

Standen Place, Horsham

Offers Over £365,000

 2
  1
  1



A beautifully presented MODERN HOME located towards the end of a SMALL CUL DE SAC, boasting TWO GENEROUS BEDROOMS, an impressive REFITTED KITCHEN , 50ft WEST FACING GARDEN and 16ft GARAGE.

Key Features

- Watch Our Video Tour
- Stylish Refitted Kitchen
- 50ft West Facing Garden
- Small North Horsham Cul De Sac
- 0.6 Miles From Littlehaven Station
- Two Generous Bedrooms
- Modern Family Bathroom
- 16'1 x 7'10 Garage
- Close To Popular Schools
- Driveway Parking

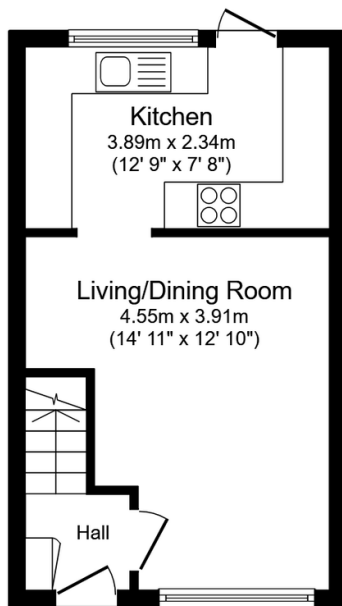

Ground Floor
Floor area 27.3 sq.m. (294 sq.ft.)

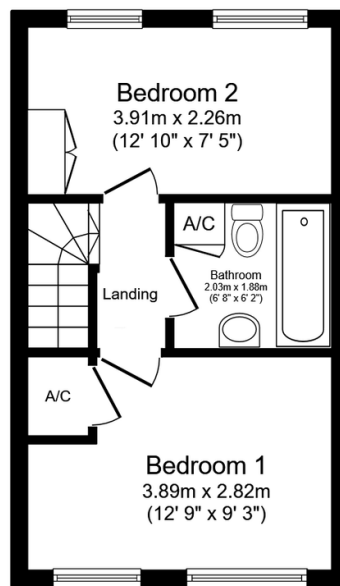

First Floor
Floor area 27.3 sq.m. (294 sq.ft.)

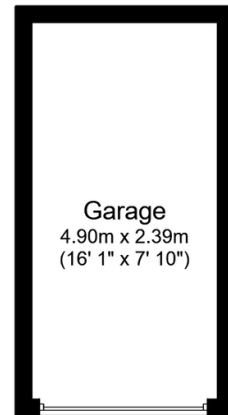

Garage
Floor area 11.6 sq.m. (125 sq.ft.)

Total floor area: 66.2 sq.m. (713 sq.ft.)

This floor plan is for illustrative purposes only. It is not drawn to scale. Any measurements, floor areas (including any total floor area), openings and orientations are approximate. No details are guaranteed, they cannot be relied upon for any purpose and do not form any part of any agreement. No liability is taken for any error, omission or misstatement. A party must rely upon its own inspection(s). Powered by www.Propertybox.io