

## Oakleigh Road, Horsham

Offers Over £350,000

3 2 1



A well presented Three Bedroom End of Terrace home, located in a popular North Horsham Cul de Sac, boasting Driveway Parking and South Facing Garden.

Tenure: Freehold

Council Tax Band: C

EPC: Current D - Potential C

## Key Features

- Watch Our Video Tour
- Three Bedrooms
- 14'6" x 12'4" Living Room
- Cul De Sac Location
- Close To Local Shops
- Generous South Facing Garden
- Stylish 11ft Kitchen
- En Suite Shower Room
- Driveway Parking
- Modern Family Bathroom

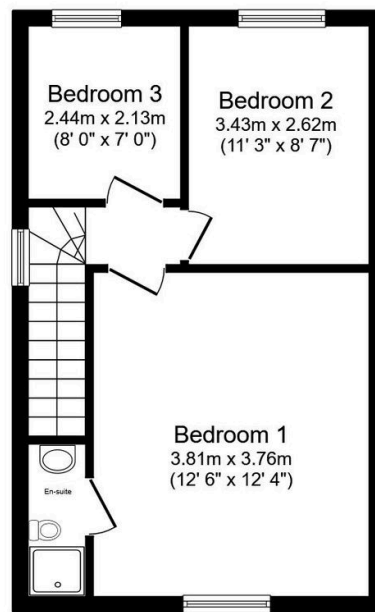
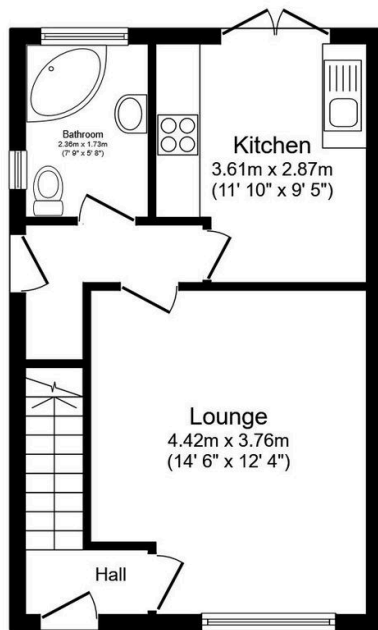

Total floor area: 72.2 sq.m. (777 sq.ft.)

This floor plan is for illustrative purposes only. It is not drawn to scale. Any measurements, floor areas (including any total floor area), openings and orientations are approximate. No details are guaranteed, they cannot be relied upon for any purpose and do not form any part of any agreement. No liability is taken for any error, omission or misstatement. A party must rely upon its own inspection(s). Powered by [www.Propertybox.io](http://www.Propertybox.io)