

Cook Way, Wickhurst Green

Offers Over £375,000

🛏 2 🚗 1 🚲 1



A stunning Two Double Bedroom Home located in a Small Cul De Sac, boasting a 34ft Open Plan Living Area, Off Street Parking for two cars and a Landscaped Rear Garden.

Tenure: Freehold

Council Tax: Band C

EPC Rating: Current B - Potential A

Key Features

- Watch Our Video Tour
- Stunning 34ft Open Plan Living Area
- Off Street Parking For Two Cars
- Luxurious Family Bathroom
- Popular Village Setting
- Two Large Double Bedrooms
- Stylish Refitted Kitchen
- Landscaped Rear Garden
- Cul De Sac Location
- Ground Floor WC



Ground Floor

Floor area 45.5 sq.m. (490 sq.ft.)

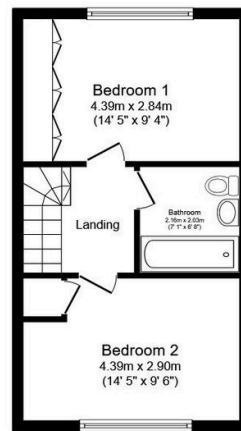

First Floor

Floor area 35.8 sq.m. (385 sq.ft.)

TOTAL: 81.4 sq.m. (876 sq.ft.)

This floor plan is for illustrative purposes only. It is not drawn to scale. Any measurements, floor areas (including any total floor area), openings and orientations are approximate. No details are guaranteed, they cannot be relied upon for any purpose and do not form any part of any agreement. No liability is taken for any error, omission or misstatement. A party must rely upon its own inspection(s). Powered by www.Propertybox.io