

Ridgehurst Drive, Horsham

Offers Over £335,000

2 1 1



An impressive End of Terrace Home sat on a large double width plot at the end of a Cul de Sac, boasting beautifully presented accommodation throughout and Driveway parking parking for three cars.

Tenure: Freehold
Council Tax Band: C
EPC: Current C - Potential B

Key Features

- Watch Our Video Tour
- Excellent Potential To Extend (stpp)
- Cul De Sac Location
- 11'9 x 11'3 Kitchen Diner
- End Of Terrace Home
- Large Double Width Plot
- Driveway For Three Cars
- Beautifully Presented Throughout
- Built In Wardrobes To Both Bedrooms
- Popular West Side Of Horsham

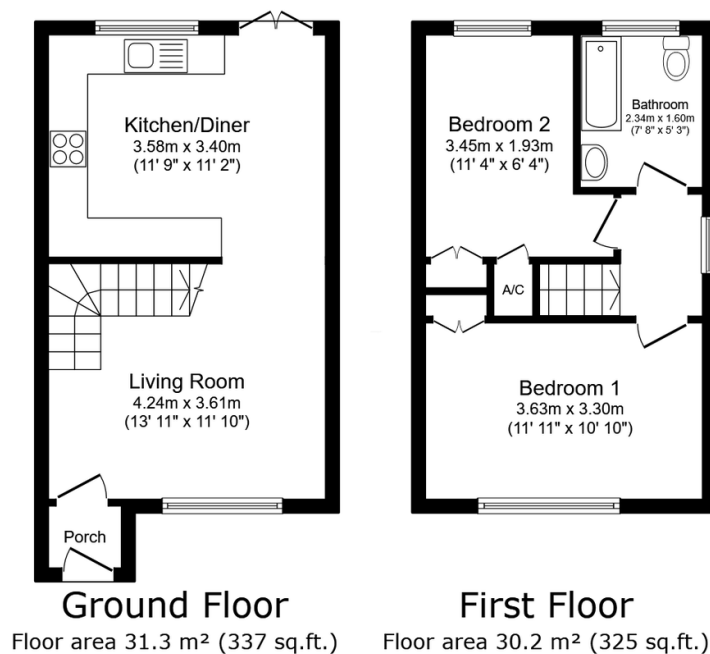

TOTAL: 61.5 m² (662 sq.ft.)

This floor plan is for illustrative purposes only. It is not drawn to scale. Any measurements, floor areas (including any total floor area), openings and orientations are approximate. No details are guaranteed, they cannot be relied upon for any purpose and do not form any part of any agreement. No liability is taken for any error, omission or misstatement. A party must rely upon its own inspection(s). Powered by www.Propertybox.io