

Forestfield, Horsham

Guide Price £675,000

5 1 3



A spacious Detached Family Home sat on an impressive corner plot towards the end of a small Cul de Sac, offering a flexible layout and excellent potential to personalise.

Tenure: Freehold

Council Tax Band: F

EPC: Current C - Potential C

Key Features

- Watch Our Video Tour
- Four/Five Generous Bedrooms
- Corner Plot Rear Garden
- Woodland Views To The Rear
- Cul De Sac Location
- Spacious Detached Family Home
- Three Separate Reception Rooms
- Popular School Catchment
- Potential To Improve & Personalise
- 1.1 Miles From Horsham Station



Ground Floor
Floor area 83.8 m² (901 sq.ft.)

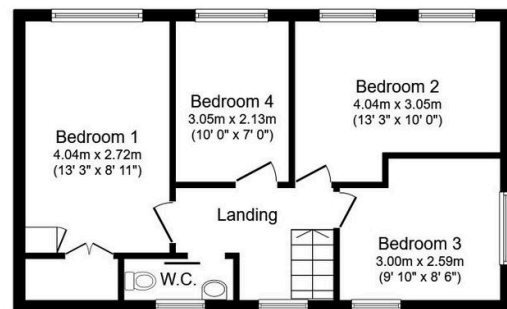

First Floor
Floor area 46.7 m² (503 sq.ft.)

TOTAL: 130.4 m² (1,404 sq.ft.)

This floor plan is for illustrative purposes only. It is not drawn to scale. Any measurements, floor areas (including any total floor area), openings and orientations are approximate. No details are guaranteed, they cannot be relied upon for any purpose and do not form any part of any agreement. No liability is taken for any error, omission or misstatement. A party must rely upon its own inspection(s). Powered by www.Propertybox.io