

## Guildford Road, Rudgwick

Guide Price £1,250,000

🛏️ 4 🍽️ 2 🚗 2



A stunning Three Storey Period Home sat on a Private 0.82 Acre Plot in a semi rural location, boasting a 25ft Reception Room, an exceptionally flexible layout and a number of outbuildings.

Tenure: Freehold

Council Tax Band: E

EPC: Current D - Potential B

## Key Features

- Watch Our Video Tour
- Accessed Via Private Lane
- 25ft Triple Aspect Reception Room
- 15'5 x 11'5 Detached Studio/Home Office
- Family Room & Study
- Secluded 0.82 Acre Plot
- Three/Four Bedrooms
- Car Barn & Garage
- Charming Semi Rural Location
- Accommodation Across Three Floors

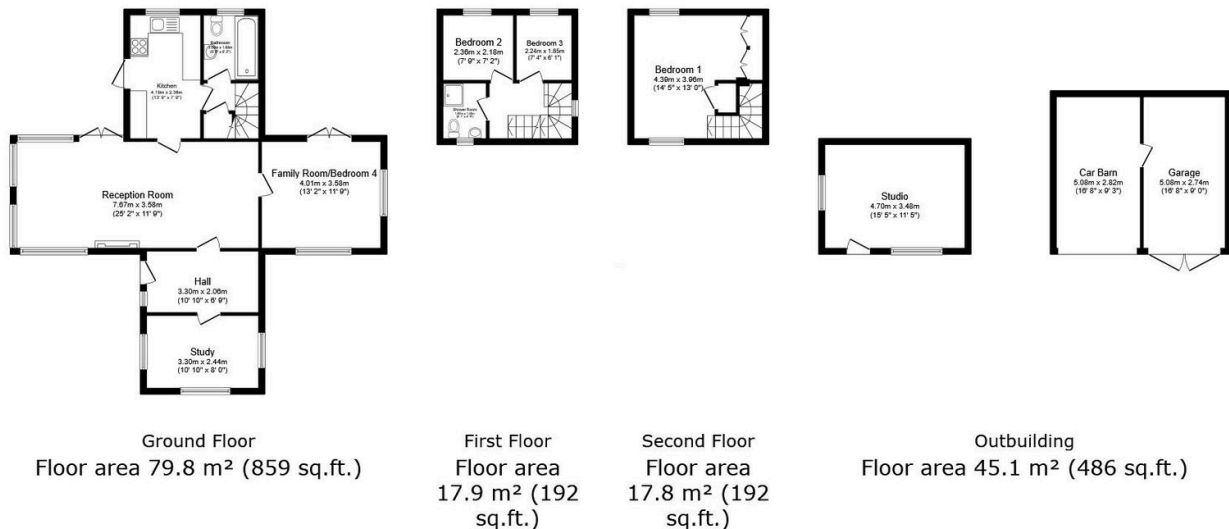

**TOTAL: 160.6 m<sup>2</sup> (1,729 sq.ft.)**

This floor plan is for illustrative purposes only. It is not drawn to scale. Any measurements, floor areas (including any total floor area), openings and orientations are approximate. No details are guaranteed, they cannot be relied upon for any purpose and do not form any part of any agreement. No liability is taken for any error, omission or misstatement. A party must rely upon its own inspection(s). Powered by [www.Propertybox.io](http://www.Propertybox.io)