

## Charrington Way, Broadbridge Heath

Guide Price £375,000

3 1 2



An impressive three bedroom Family Home in a popular village, boasting a stylish Bathroom, open plan Kitchen Diner, allocated parking and a South West facing garden.

Tenure: Freehold

Council Tax Band: C

EPC: Current C - Potential B

## Key Features

- Watch The Video Tour
- Generous Living Room
- Allocated Off Street Parking
- Popular Village
- 8'3 x 8'0 Conservatory
- Open Plan Kitchen Diner
- South West Facing Garden
- Cul De Sac Location
- Modern Family Bathroom
- Three Bedrooms

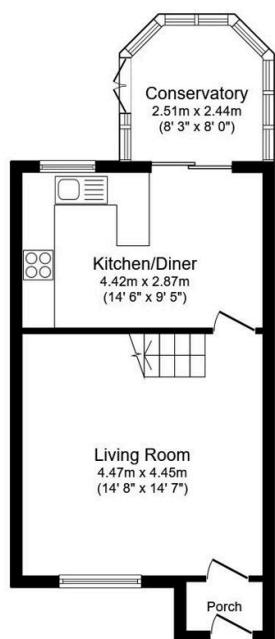

**Ground Floor**

Floor area 40.8 sq.m. (439 sq.ft.)

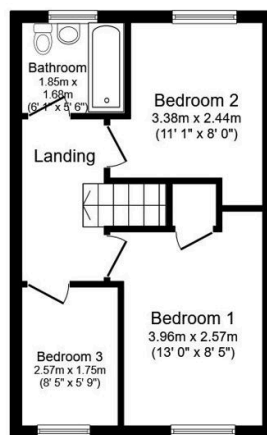

**First Floor**

Floor area 33.1 sq.m. (356 sq.ft.)

**TOTAL: 73.8 sq.m. (795 sq.ft.)**

This floor plan is for illustrative purposes only. It is not drawn to scale. Any measurements, floor areas (including any total floor area), openings and orientations are approximate. No details are guaranteed, they cannot be relied upon for any purpose and do not form any part of any agreement. No liability is taken for any error, omission or misstatement. A party must rely upon its own inspection(s). Powered by [www.Propertybox.io](http://www.Propertybox.io)