



## Loxwood Road, Tismans Common

Guide Price £700,000

 3  2  3



A charming Detached Country Home set on a Private Plot with stunning Views Across Farmland, boasting a 20ft Detached Garage, potential to improve and No Onward Chain.

Tenure: Freehold

Council Tax Band: E

Energy Performance Rating: Current E - Potential C

## Key Features

- Watch The Video Tour
- Views Across Fields
- No Onward Chain
- Potential To Improve
- 19ft Living Room
- Detached Country Home
- Private Rear Garden
- 20ft Detached Double Garage
- Study
- Semi Rural Location

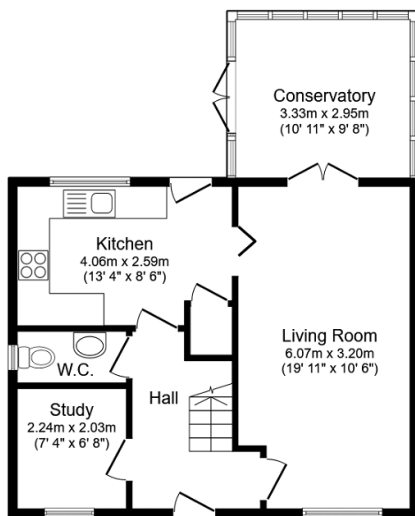

### Ground Floor

Floor area 53.8 m<sup>2</sup> (579 sq.ft.)

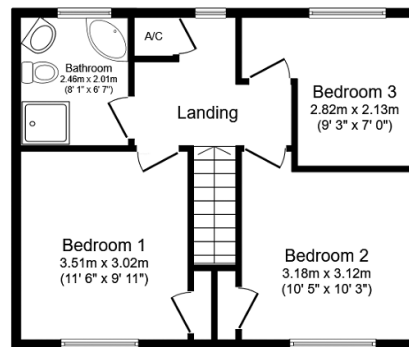

### First Floor

Floor area 43.6 m<sup>2</sup> (469 sq.ft.)

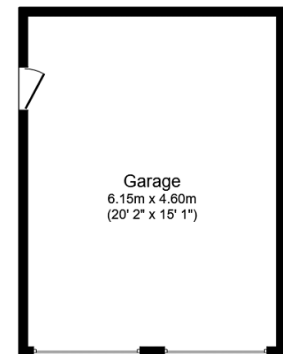

### Garage

Floor area 28.4 m<sup>2</sup> (306 sq.ft.)

**TOTAL: 125.9 m<sup>2</sup> (1,355 sq.ft.)**

This floor plan is for illustrative purposes only. It is not drawn to scale. Any measurements, floor areas (including any total floor area), openings and orientations are approximate. No details are guaranteed, they cannot be relied upon for any purpose and do not form any part of any agreement. No liability is taken for any error, omission or misstatement. A party must rely upon its own inspection(s). Powered by [www.Propertybox.io](http://www.Propertybox.io)