

Brighton Road, Horsham

Offers Over £375,000

🛏️ 2 🍳 1 🚗 1

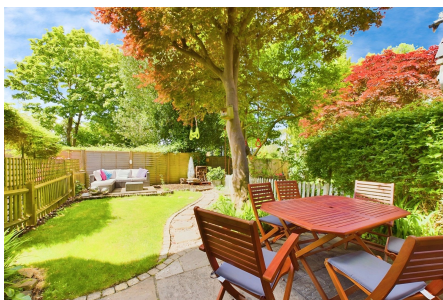

A charming Period Cottage located close to Horsham Town Centre, boasting Two Generous Bedrooms, a beautiful Rear Garden, Parking and Detached Double Garage.

Tenure: Freehold

Council Tax Band: D

Energy Performance Rating: Current D - Potential B

Key Features

- Charming Period Cottage
- Stylish First Floor Bathroom
- South West Facing Rear Garden
- Close To Town Centre
- 14ft Kitchen Diner
- Two Generous Bedrooms
- 16ft x 16ft Detached Double Garage
- Popular School Catchment
- 0.7 Miles To Horsham Station
- Excellent Storage

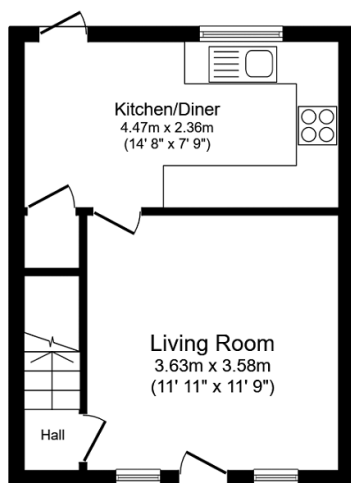

Ground Floor

Floor area 27.2 m² (293 sq.ft.)

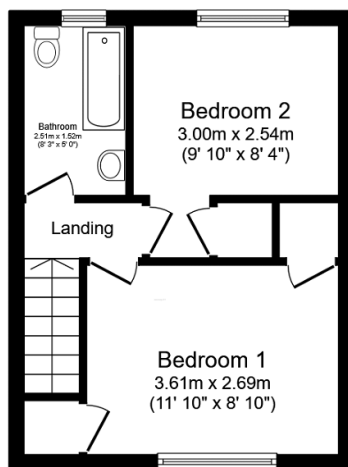

First Floor

Floor area 27.2 m² (293 sq.ft.)

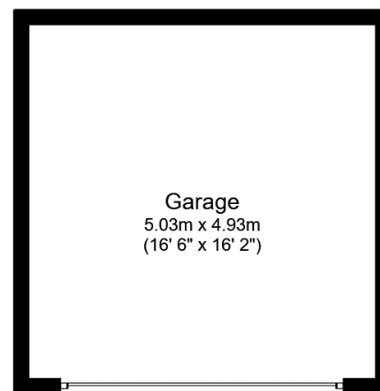

Garage

Floor area 24.8 m² (267 sq.ft.)

TOTAL: 79.3 m² (853 sq.ft.)

This floor plan is for illustrative purposes only. It is not drawn to scale. Any measurements, floor areas (including any total floor area), openings and orientations are approximate. No details are guaranteed, they cannot be relied upon for any purpose and do not form any part of any agreement. No liability is taken for any error, omission or misstatement. A party must rely upon its own inspection(s). Powered by www.Propertybox.io