

Gay Street Lane, North Heath

Offers Over £1,000,000

🛏 4 🚿 2 🛋 4



An attractive detached Family Home set on a private 2.5 acre plot, with a 40ft Detached Stone Barn that offers excellent potential to convert (stpp) and no onward chain.

Tenure: Freehold
Council Tax Band: G
EPC: Current E - Potential B

Key Features

- Private 2.5 Acre Plot
- 40ft Detached Stone Barn
- Potential To Extend/Develop (stpp)
- Four Separate Reception Rooms
- Numerous Outbuildings
- Imposing Detached Family Home
- No Onward Chain
- Four Double Bedrooms
- Secluded Location
- Potential To Improve/Personalise



Ground Floor

Floor area 109.2 m² (1,176 sq.ft.)



First Floor

Floor area 79.4 m² (854 sq.ft.)

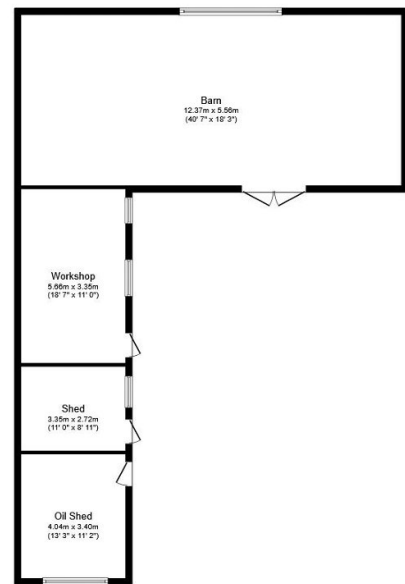

Outbuilding

Floor area 112.2 m² (1,208 sq.ft.)

TOTAL: 300.8 m² (3,238 sq.ft.)

This floor plan is for illustrative purposes only. It is not drawn to scale. Any measurements, floor areas (including any total floor area), openings and orientations are approximate. No details are guaranteed, they cannot be relied upon for any purpose and do not form any part of any agreement. No liability is taken for any error, omission or misstatement. A party must rely upon its own inspection(s). Powered by www.Propertybox.io