

Trafalgar Road, Horsham

Offers Over £475,000

 4  1  2



An Extended Semi Detached Family Home with spacious Accommodation Over Three Floors, Four Generous Bedrooms, a 23ft Kitchen Diner and a South West Facing Rear Garden.

Tenure: Freehold

Council Tax Band: E

EPC Rating: Current D - Potential B

Key Features

- Four Generous Bedrooms
- Accommodation Over Three Floors
- 23ft Kitchen Diner
- Luxurious Family Bathroom
- 0.8 Miles From Horsham Station
- South West Facing Garden
- Close To Popular Schools
- Separate Living Room
- Semi Detached Period Home
- 0.6 Miles From Town Centre

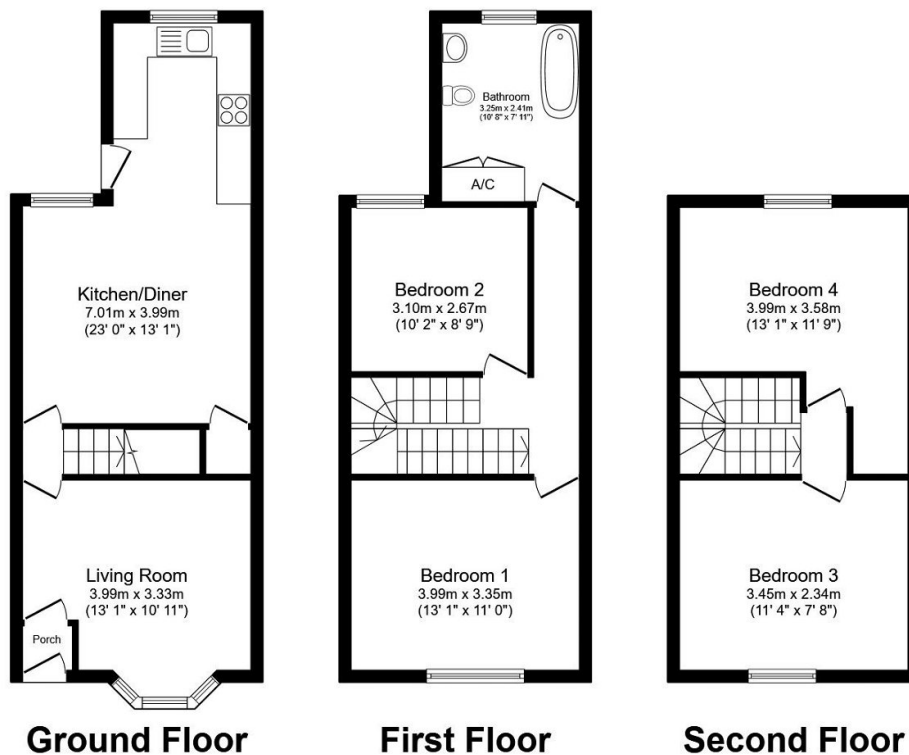

Total floor area 113.4 m² (1,221 sq.ft.) approx

This plan is for illustration purposes only and may not be representative of the property. Plan not to scale. Powered by PropertyBox