



Long Close Avenue, Rudloe, Corsham

£250,000

3 1 1

- Good sized 3 bedroom home
- 18ft Sitting room
- Refitted bathroom and separate Wc on 1st floor
- Excellent , private and sunny garden
- Approx 2 miles to Corsham High Street
- Large kitchen/dining room with French doors to the garden
- Two super double bedrooms plus a good sized single
- Modern and quirky decor
- Excellent area for bus services, play park, school and countryside walks
- On street parking



A 3 bedroom terraced home which has been modernised and updated and now provides a spacious family property at an affordable price. A spacious, refitted kitchen/dining room is mirrored by an equally good sized sitting room and with 3 very good sized bedrooms upstairs, re-fitted bathroom and excellent private garden, this home is a super opportunity !





Long Close Avenue, Corsham, SN13

Approximate Area = 928 sq ft / 86.2 sq m
For identification only - Not to scale

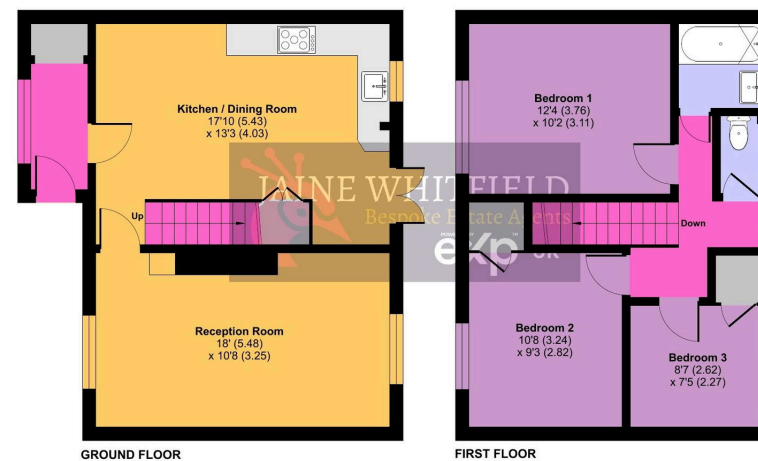

Floor plan produced in accordance with RICS Property Measurement 2nd Edition, incorporating International Property Measurement Standards (IPMS2 Residential). © richcom 2025. Produced for jaine whitfield Property Services. REF: 1207654



Energy Efficiency Rating

	Current	Potential
Very energy efficient - lower running costs		
(92 plus) A		
(81-91) B		87
(69-80) C	70	
(55-68) D		
(39-54) E		
(21-38) F		
(1-20) G		
Not energy efficient - higher running costs		
England & Wales	EU Directive 2002/91/EC	

01225 705650

hello@jainewhitfield.co.uk

www.jainewhitfield.co.uk



Part of the Internation Group of Estate Agents Power by EXP UK. Registered address: 5 Churchill Place, 10th Floor, London E14 5HU