





## Eastleigh Road, Devizes

£350,000

3 1 1

- Recently renovated 4 bedroom home plus 4 car wide driveway
- High specification finish throughout.
- Main Living room with box bay window
- Additional kitchen/diner/ living room and utility area to annexe area.
- Large and private rear garden with very generously sized shed storage
- Annexe accommodation perfect for an elderly relative or rental opportunity
- Use as 2 separate homes or combine for one larger family space
- Superb modern kitchen/ diner with French doors into the garden
- Downstairs wet room to the annexe and Family bathroom to main house
- Close to all local shops, amenities and schools.



A superb opportunity to purchase a recently renovated and modernised 4 bedroom semi detached home. This property also, unusually, has a large annexe to one side offering the perfect separate accommodation for a young adult child or elderly relative. It would also be a perfect rental opportunity for a family living in the 3 bedroom part of the house. Finishing off this superb property is a lovely sized garden to the rear (with the ability to sub divide if required and plenty of driveway parking to the front).







# Eastleigh Road, Devizes, SN10

Approximate Area = 964 sq ft / 89.5 sq m  
 Annexe = 548 sq ft / 50.9 sq m  
 Outbuilding = 98 sq ft / 9.1 sq m  
 Total = 1610 sq ft / 149.5 sq m  
 For identification only - Not to scale

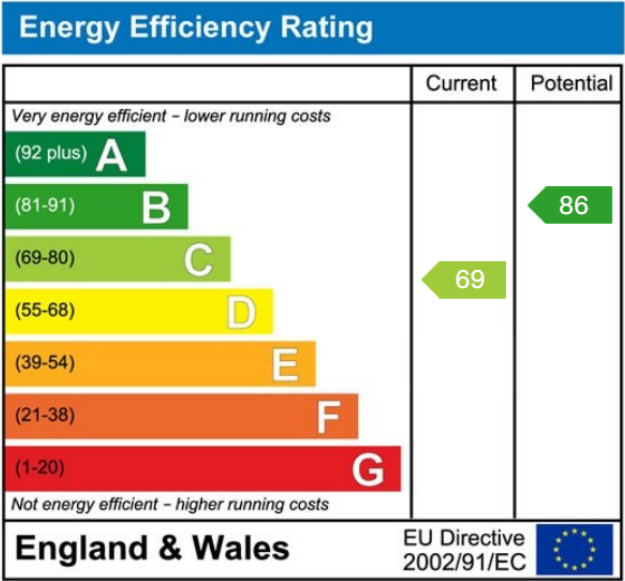
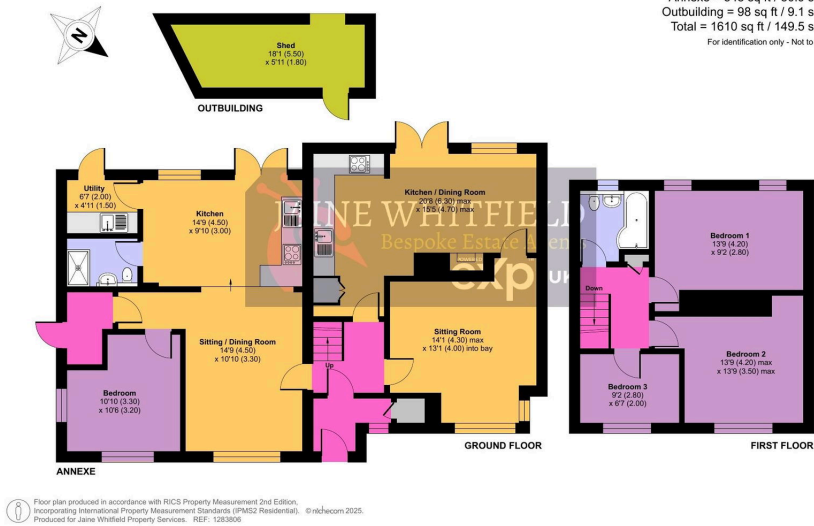

☎ 01225 705650  
 ✉ hello@jainewhitfield.co.uk  
 🌐 www.jainewhitfield.co.uk

