



North View, Preston Village, North Shields, NE29 9LS
£125,000

Bedrooms: 1 | Bathrooms: 1 | Receptions: 1

Set within an attractive period conversion, this well-presented ground floor flat combines character features with practical modern living, making it an ideal choice for first-time buyers, down-sizers, or investors alike. The accommodation includes a front aspect living room with feature fireplace, a double bedroom, a spacious internal shower room and a galley-style kitchen leading out to the rear access. Externally, the property enjoys its own rear courtyard with gated access (leading to the resident's parking) as well as a beautiful mature garden that will be wonderful extension to the property during the warmer months. Offered with no onward chain, this home is ready for immediate occupation and offers a rare opportunity to secure a characterful property with outdoor space. Well located for local amenities and transport links, it's a home that blends charm, convenience and lifestyle appeal.

- Period Conversion
- Ground Floor Flat
- One Double Bedroom
- Front Aspect Living Room With Feature Fireplace
- Spacious Internal Shower Room
- Galley-Style Kitchen
- Rear Courtyard With Gated Rear Access
- Beautiful Mature Garden
- Resident's Parking To Rear
- No Onward Chain





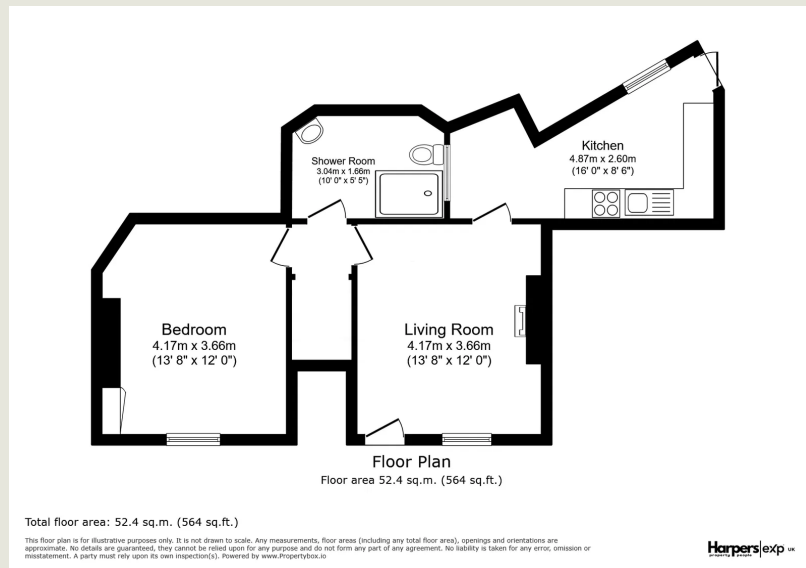

Harpers Property People

80 Windsor Gardens, Bedlington, Northumberland, NE22 5SY

07813 673 606

ali@harpersproperty.com

<https://harpersproperty.com>

Harpers POWERED BY **exp** TM **UK**
property people