





## 48 Red House Farm Estate,

Offers Over £110,000

🛏 3 🚿 1 🛋 1



- Mid-Terrace Family Home
- Three Spacious Bedrooms
- Large First Floor Family Bathroom
- Spacious Front 2 Back Reception Room
- Modern Good-Sized Kitchen
- Enclosed South Facing Garden
- Downstairs WC
- Well Presented Throughout
- Close To Local Amenities & Schools
- Brilliant Internal Proportions







Located to the West of central Bedlington, this spacious family home is very well positioned for a number of local schools, various local amenities & a great deal of open green space within close proximity. This mid-terraced property offers an incredible amount of internal accommodation for the money that includes three spacious bedrooms as well as a good-sized family bathroom at first floor level. The ground floor is equally as generous with the inclusion of a large front 2 back living/ dining room, a modern well appointed kitchen as well as a separate WC just off the entrance hall. A major benefit of this home is the rear garden, facing due South with nothing but open farmland beyond. Get in touch today if this looks & sounds like your next home.



Ground Floor  
Floor area 46.2 sq.m. (497 sq.ft.)

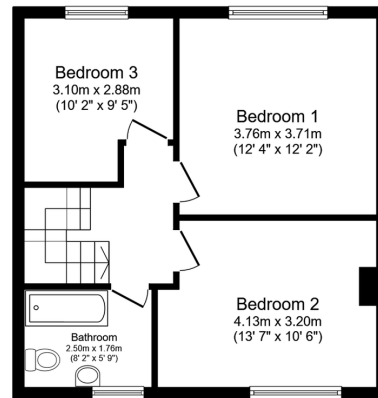

First Floor  
Floor area 46.2 sq.m. (497 sq.ft.)

Total floor area: 92.4 sq.m. (995 sq.ft.)

This floor plan is for illustrative purposes only. It is not drawn to scale. Any measurements, floor areas (including any total floor area), openings and orientations are approximate. No details are guaranteed, they cannot be relied upon for any purpose and do not form any part of any agreement. No liability is taken for any error, omission or misstatement. A party must rely upon its own inspection(s). Powered by [www.Propertybox.io](http://www.Propertybox.io)

**Harpers** | exp uk



eXp World UK Ltd is a registered company at Level 37, 25 Canada Square, London, E14 5LQ.

Registered company number is 12016573. VAT Registration Number is 327 4120 29