







**16 Knaresborough Close,**  
**Offers Over £180,000**

 3  2  1



- Semi-Detached Home
- Three Double Bedrooms
- Family Bathroom & En-Suite Shower
- Spacious Open Plan Living & Dining Room
- Modern Kitchen & Utility Room
- Garage Storage & Multi-Car Driveway
- Brilliant Location
- Generous Enclosed Garden & Patio With Gated Side Access
- Great Decorative Order Throughout
- Complete Upward Chain







Located at the far end of a cul-de-sac within the ever popular Hazelmere estate close to a number of local amenities & schooling options, we present this well appointed three double bedroom semi-detached home. Arranged over two floors, this property benefits from a generous front 2 back reception room with double doors to the garden, a modern kitchen beyond along with a matching utility room to the rear of the converted garage space. The three first floor bedrooms are supported by a family bathroom & an en-suite shower off of bedroom one. Externally, there is a good-sized rear garden & patio with gated side access, plus a multi-car driveway & ample storage space to the front of the original garage with internal access.

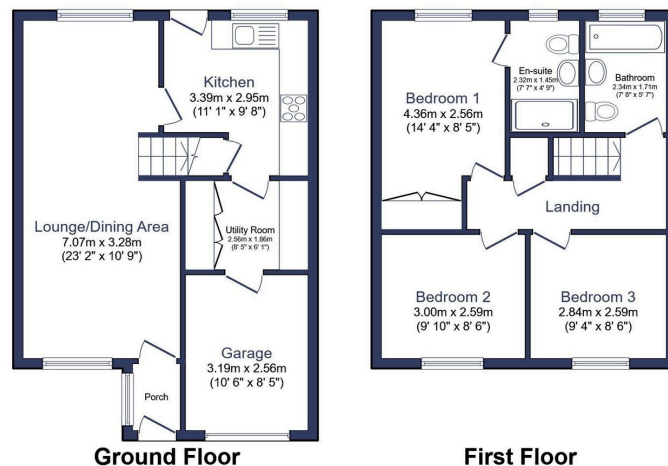

Total floor area 89.2 m<sup>2</sup> (960 sq.ft.) approx

This floor plan is for illustrative purposes only. It is not drawn to scale. Any measurements, floor areas (including any total floor area), openings and orientation are approximate. No details are guaranteed, they cannot be relied upon for any purpose and they do not form part of any agreement. No liability is taken for any error, omission or misstatement. A party must rely upon its own inspection(s). Powered by [www.focalagent.com](http://www.focalagent.com)



eXp World UK Ltd is a registered company at Level 37, 25 Canada Square, London, E14 5LQ.

Registered company number is 12016573. VAT Registration Number is 327 4120 29