



7 Hereford Crescent

Little Lever, Bolton, BL3 1XQ

Offers in excess of £185,000

JonesPottsTaylor are delighted to present FOR SALE this three bedroom semi-detached property. Situated in a sought after residential location of Little Lever in Bolton, close to transport and network links, schools, shops and amenities. The property briefly comprises of; entrance porch, hallway, an open plan sitting / dining room with French doors opening to the rear garden and kitchen. To the first floor are two double bedrooms, a single bedroom and a further family three piece suite shower room. Outside to the front is an open garden, with access to the driveway which leads down the side of the property. To the rear is a large enclosed, low maintenance garden. Viewings for this property are highly recommended to see its generous outside space and potential investment, development growth.

- Potential Investment and Development Opportunity
- Sought After Location
- Close To Transport And Network Links
- Large Rear Garden & Ample Off Road Parking
- Cost Efficient Solar Panels
- Gas Central Heating & Double Glazed UPVC Windows

Viewing

Please contact our Jones Potts Taylor Office on 01942 368600 if you wish to arrange a viewing appointment for this property or require further information.

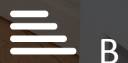

Floor Plan

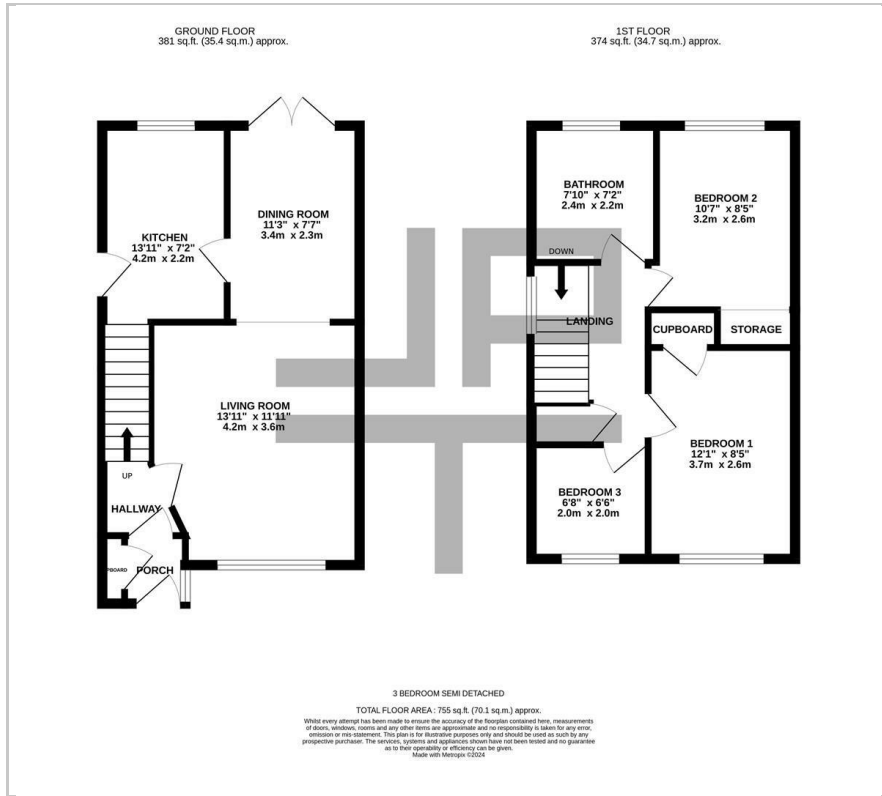

Area Map



Energy Efficiency Graph

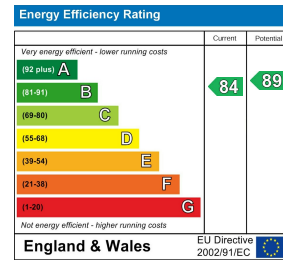

These particulars, whilst believed to be accurate are set out as a general outline only for guidance and do not constitute any part of an offer or contract. Intending purchasers should not rely on them as statements of representation of fact, but must satisfy themselves by inspection or otherwise as to their accuracy. No person in this firm's employment has the authority to make or give any representation or warranty in respect of the property.