



## 10 Rothay Street

, Leigh, WN7 2DS

Price £135,000

JonesPottsTaylor are delighted to present FOR SALE this end terrace property. Situated in a residential location in Leigh, close to network and transport links, schools, shops and amenities. The property briefly comprises of; entrance hallway, sitting room, dining room and newly fitted kitchen, to the ground floor. To the first floor are two double bedrooms and a further fitted three piece bathroom. To the rear is an enclosed low maintenance yard, with room for off road parking. Viewings for this property are recommended.

- No Onward Chain
- Two Separate Reception Rooms
- Gas Central Heating
- Newly Fitted Kitchen
- Off Road Parking
- Close To Transport And Network Links

### Viewing

Please contact our Jones Potts Taylor Office on 01942 368600 if you wish to arrange a viewing appointment for this property or require further information.



D



## Floor Plan

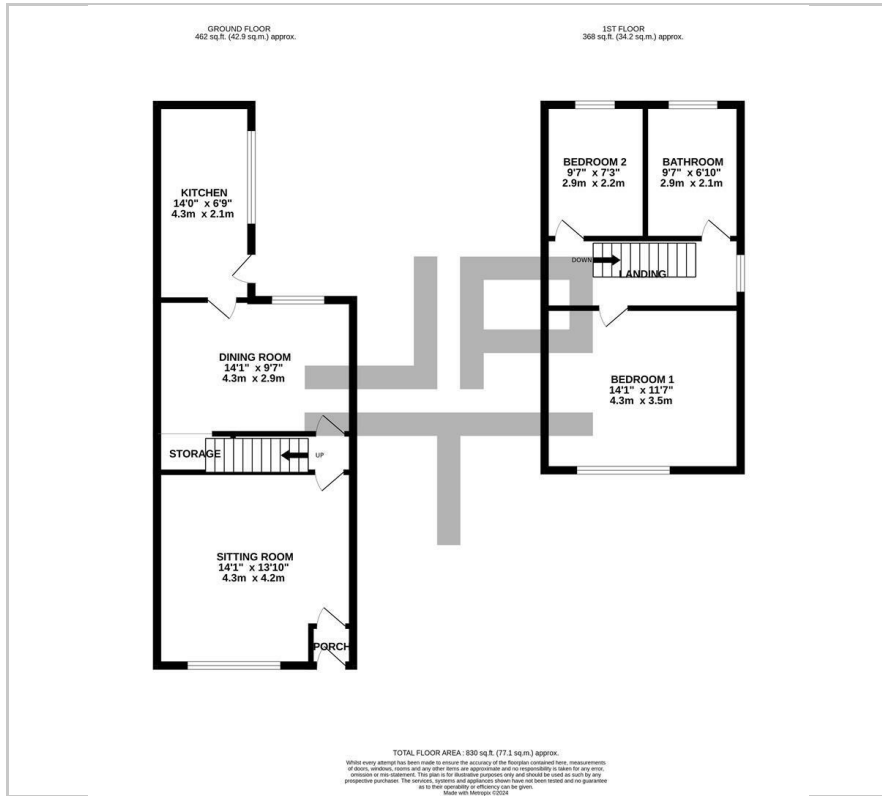

## Area Map

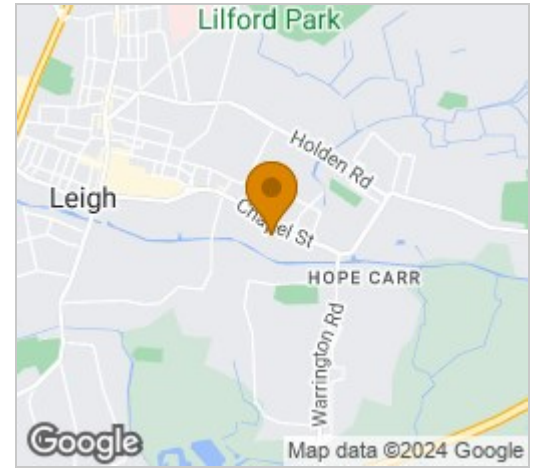

## Energy Efficiency Graph

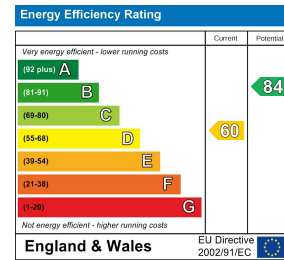

These particulars, whilst believed to be accurate are set out as a general outline only for guidance and do not constitute any part of an offer or contract. Intending purchasers should not rely on them as statements of representation of fact, but must satisfy themselves by inspection or otherwise as to their accuracy. No person in this firm's employment has the authority to make or give any representation or warranty in respect of the property.