



## 31 Moorgate Drive

Tyldesley, Manchester, M29 7DG

Offers in the region of £229,995

JonesPottsTaylor are delighted to present FOR SALE this three bedroom semi-detached property, situated in a sought after residential location in Astley. The property briefly comprises of; entrance hallway, kitchen and an open plan sitting / dining room with French doors opening to the rear garden. To the first floor are two double bedrooms, a single bedroom and a further three piece suite bathroom. Outside to the front is an open garden, with access to the driveway which leads to a detached garage. To the rear is an enclosed low maintenance garden.

The property is currently under renovation which will be completed prior to any sale completion. Viewings are highly recommended.

- Under Renovation
- No Onward Chain
- Potential Development Growth
- Gas Central Heating
- Double Glazed PVC Windows
- Spacious Driveway And Detached Garage

### Viewing

Please contact our Jones Potts Taylor Office on 01942 368600 if you wish to arrange a viewing appointment for this property or require further information.



## Floor Plan

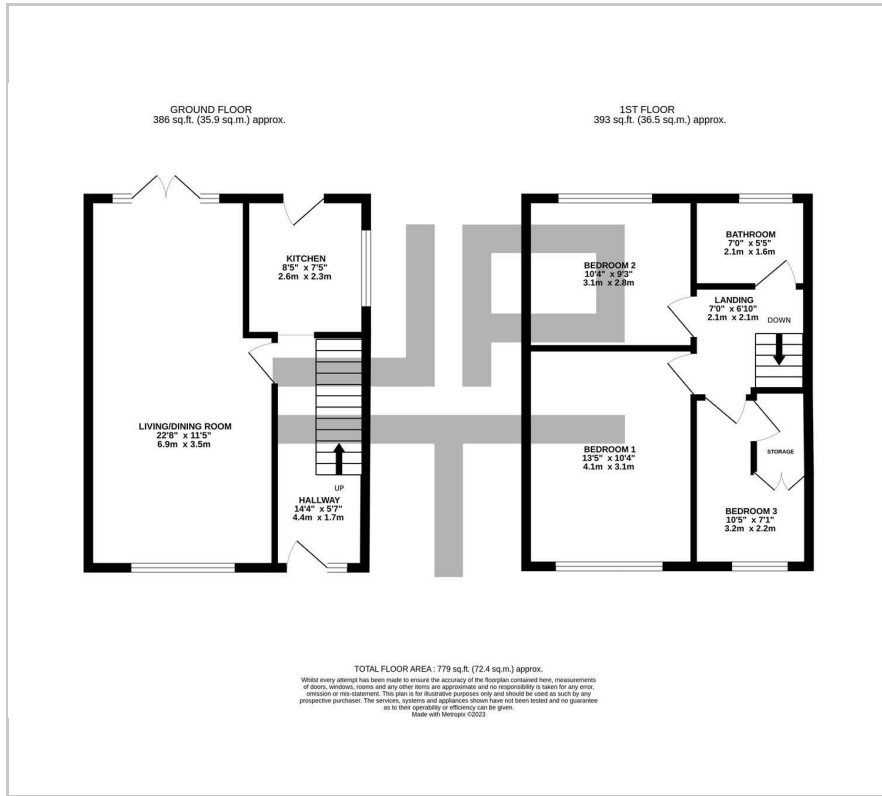

## Area Map



## Energy Efficiency Graph

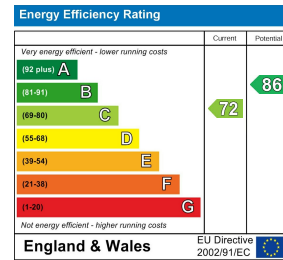

These particulars, whilst believed to be accurate are set out as a general outline only for guidance and do not constitute any part of an offer or contract. Intending purchasers should not rely on them as statements of representation of fact, but must satisfy themselves by inspection or otherwise as to their accuracy. No person in this firm's employment has the authority to make or give any representation or warranty in respect of the property.