



Sheering Mill Lane, Sawbridgeworth, CM21

Guide Price £179,000

iad UK

www.iad.uk.com |



DOING REAL ESTATE A WORLD OF GOOD



Introducing the Ultimate Wide Beam Houseboat: A Luxurious Floating Retreat! This is a rare opportunity to own a one-of-a-kind, meticulously designed wide beam houseboat that exudes sheer luxury. No expense has been spared in creating a floating sanctuary that rivals the comfort and elegance of a high-end hotel.





 1

 1

 458 sq ft



Approx. Gross Internal Area 459 Sq Ft - 42.60 Sq M

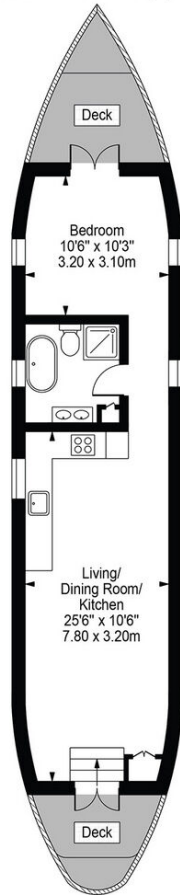

Ground Floor
For Illustration Purposes Only - Not To Scale

This floor plan should be used as a general outline for guidance only and does not constitute in whole or in part an offer or contract. Any intending purchaser or lessee should satisfy themselves by inspection, searches, enquiries and full survey as to the correctness of each statement. Any areas, measurements or distances quoted are approximate and should not be used to value a property or be the basis of any sale or let.



DOING REAL ESTATE A WORLD OF GOOD

iad UK

50 Seymour Street, , London, England, , W1H 7JG

www.iad.uk.com |