



KINGSTONS



## St. Ediths Marsh

Bromham, Chippenham SN15 2DF

- Charming Grade II Listed Home
  - Three Generous Bedrooms
  - Beautiful Countryside Views
- Popular Village with Great Community
- Extended with Two Reception Rooms
  - Utility Room and Downstairs Toilet
  - Stunning Walks
- Near Market Town of Devizes

**£485,000 Freehold**





### **Porch**

External door and door to kitchen/diner.

### **Kitchen/Diner**

17'8" x 14'6"

Fitted with a matching range of base and eye level units with worktop space over, Belfast sink, space for fridge/freezer, dishwasher and cooker, windows to side and rear elevation, radiator and doors to lobby, inner hall and living room.

### **Living Room**

12'4" x 21'7"

Two windows to front elevation, radiator and external door to front.

### **Lobby**

Radiator and stairs to first floor.

### **Inner Hall**

Opening the utility room and door to study.



### **Family Room / Study**

10'11" x 9'9"

Window to rear elevation, radiator and external door to rear garden.

### **Utility**

Fitted with a with worktop space over base units, space for washing machine and door to WC.

### **WC**

Fitted with a two piece suite comprising wash hand basin and WC, boiler and window to side elevation.

### **Landing**

5'10" x 10'8"

Window to side elevation and doors to bedrooms and bathroom.

### **Bedroom One**

12'4" x 14'6"

Windows to rear and side elevation with radiator.

### **Bedroom Two**

12'6" x 11'9"

Window to front elevation and radiator.

### **Bedroom Three**

12'7" x 9'11"

Window to front elevation and radiator.

### **Bathroom**

Fitted with a four piece suite comprising bath with separate shower

enclosure, WC and wash hand basin, window to rear elevation and radiator.

### **Outside**

Enclosed front garden mostly laid to lawn with shed and courtyard garden to rear overlooking fields.



Local Authority **Wiltshire**  
Council Tax Band **D**  
EPC Rating

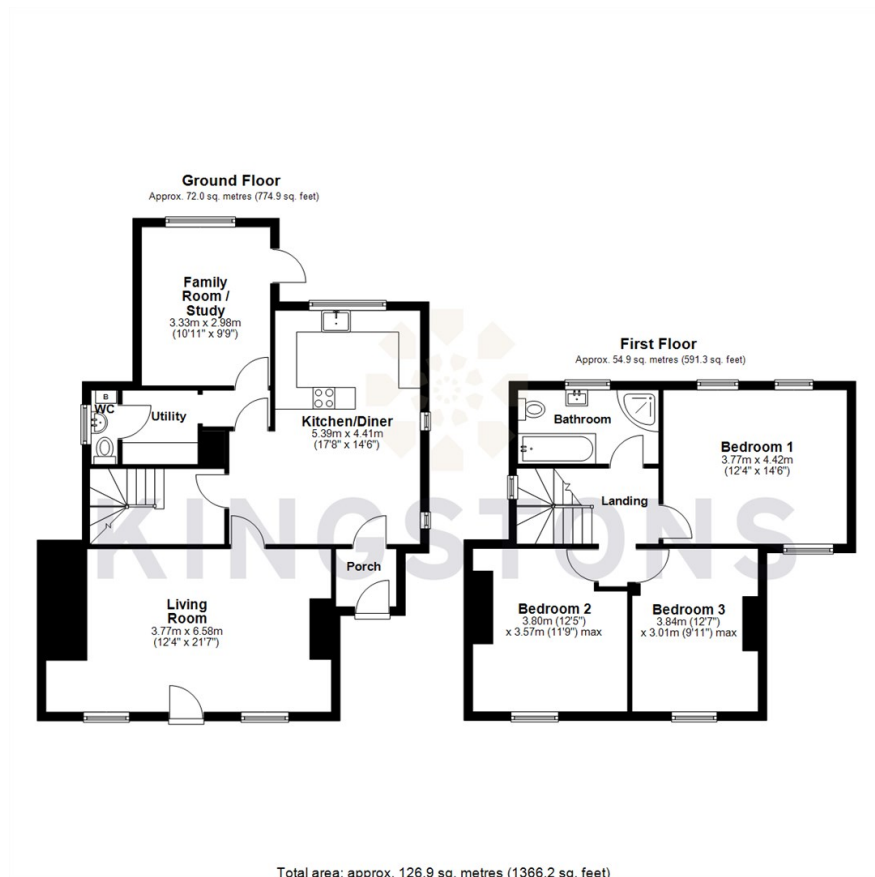

  
**KINGSTONS**  
Melksham Office

11 High Street, Melksham,  
Wiltshire, SN12 6JR

### Contact

01225709115  
sales@kingstons.biz  
www.kingstons.biz

Agents Note: Whilst every care has been taken to prepare these particulars, they are for guidance purposes only. All measurements are approximate and for general guidance purposes only and whilst every care has been taken to ensure accuracy, they should not be relied upon and potential buyers/tenants are advised to recheck the measurements.