



KINGSTONS



Oregano Close

Melksham SN12 6WW

- Detached
- Kitchen/Diner
 - En-suite
 - Garden
- Only A Few Years Old
 - Three Bedrooms
 - Green Outlook
 - Driveway

Asking Price £350,000 Freehold





Hall

Door to front elevation, doors to cloakroom, living room, kitchen/diner and cupboard, stairs to first floor and radiator.

Cloakroom

Fitted with a two piece suite comprising of wash hand basin and low-level WC and radiator.

Living Room

Windows to front and side elevations, media wall and radiator.

Kitchen/Diner

Fitted with a matching range of base and eye level units with worktop space over, 1+1/2 bowl sink unit with single drainer and mixer tap, space for fridge/freezer, dishwasher and washing machine, built-in electric fan assisted oven, built-in four ring gas hob with extractor hood over, windows to front and side elevations, double doors to side elevation and radiator.



Landing

Doors to bedrooms, bathroom and cupboard.

Main Bedroom

Window to side elevation, built in wardrobe with sliding mirror doors, door to en-suite and radiator.

En-suite

Fitted with a three piece suite comprising of double shower, wash hand basin and low-level WC, window to front elevation and radiator.

Bedroom Two

Windows to front and side elevation and radiator.

Bedroom Three

Window to side elevation and radiator.

Bathroom

Fitted with a three piece suite comprising of bath with hand shower attachment, wash hand basin and low-level WC, window to front elevation and heated towel rail.

Garden

Fully enclosed with rear access, mainly laid to lawn with a patio and raised borders.

Driveway

Located to the rear of the property with space for two vehicles.



Local Authority **Wiltshire**
Council Tax Band **D**
EPC Rating **B**

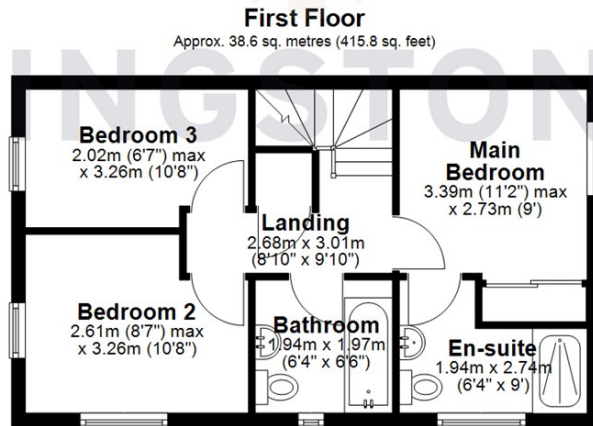
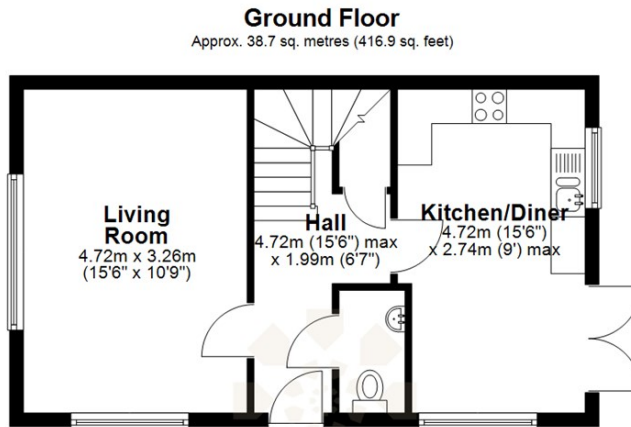

Total area: approx. 77.4 sq. metres (832.7 sq. feet)



KINGSTONS
Melksham Office

11 High Street, Melksham,
Wiltshire, SN12 6JR

Contact

01225709115
sales@kingstons.biz
www.kingstons.biz

Agents Note: Whilst every care has been taken to prepare these particulars, they are for guidance purposes only. All measurements are approximate and for general guidance purposes only and whilst every care has been taken to ensure accuracy, they should not be relied upon and potential buyers/tenants are advised to recheck the measurements.