



## Grasmere

Bowerhill, Melksham SN12 6FQ

- Incredibly Popular Location
  - Impressive Kitchen
- Double Garage & Driveway
- Beautiful Finish
- Private Garden

**Asking Price £500,000 Freehold**

Local Authority  
Council Tax Band **E**  
EPC Rating **D**

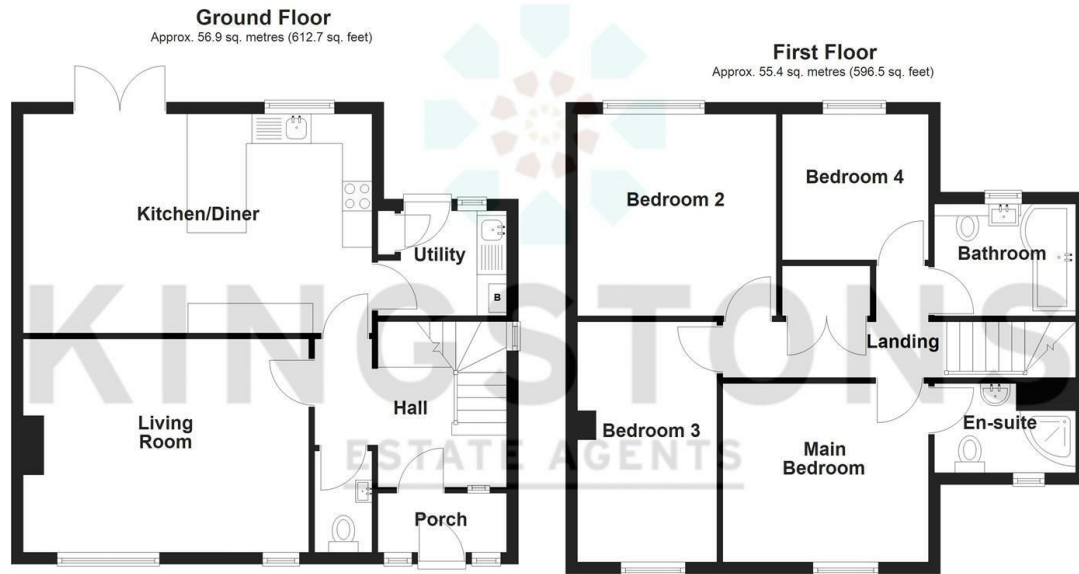

Total area: approx. 112.3 sq. metres (1209.2 sq. feet)



  
**KINGSTONS**  
Melksham Office

11 High Street, Melksham,  
Wiltshire, SN12 6JR

**Contact**  
01225709115  
sales@kingstons.biz  
www.kingstons.biz

Agents Note: Whilst every care has been taken to prepare these particulars, they are for guidance purposes only. All measurements are approximate and for general guidance purposes only and whilst every care has been taken to ensure accuracy, they should not be relied upon and potential buyers/tenants are advised to recheck the measurements.