

# Goldsdow Road EN3

£374,995

## FREEHOLD

 2 BEDROOMS

 1 BATHROOMS

 1 RECEPTIONS

## Details

- TWO DOUBLE BEDROOMS
- FITTED KITCHEN
- LOUNGE OPENING ONTO REAR GARDEN
- LARGE FIRST FLOOR BATHROOM
- SOUGHT AFTER TURNING
- CHAIN FREE
- GAS CENTRAL HEATING AND DOUBLE GLAZING
- APPROX 30/40FT REAR GARDEN
- CLOSE TO ALL AMENITIES
- VIEWINGS HIGHLY RECOMMENDED

EPC RATING: 63 (D)  
COUNCIL TAX: C

BREENS





## Goldsdow Road, Enfield, EN3

APPROX GROSS INTERNAL FLOOR AREA: 844 sq. ft / 78 sq. m

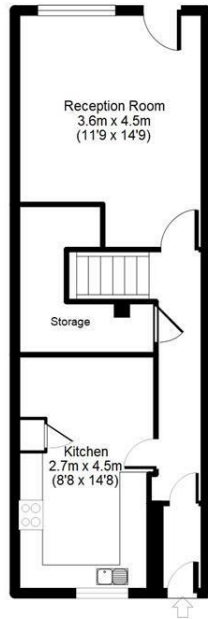

Ground Floor

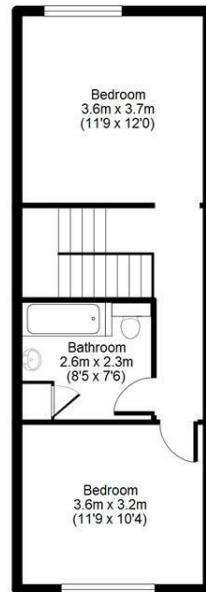

First Floor

For identification purposes only  
Measurements are approx and not to scale



BREENS

## Contact Us

020 8804 8989

[enfield@breens.property](mailto:enfield@breens.property)

[www.breens.property](http://www.breens.property)

557- 559 Hertford Road, Enfield, EN3 5UQ

All sizes are approximate. The Agent has not tested any apparatus, equipment, fixtures and fittings, or services and so cannot verify that they are in working order or fit for the purpose. A buyer is advised to obtain verification from their Solicitors or Surveyor. Photographs are for illustration purposes only and may depict items, which are not for sale or included in the sale price. References to tenure of a property are based upon Information supplied by the vendor. The agent has not had sight of the title documents, a buyer is advised to obtain verification from their solicitor.

Money Laundering Regulations 2003: Intending purchasers will be asked to produce identification, documentation at a later stage and we would ask for your co-operation in order that there will be no delay in agreeing the sale. These particulars are intended to give a fair description of the property only and are in no way guaranteed, nor do of any contract. They are issued on the express condition that all negotiations are conducted through Breens Estate Agents. All subject to contract and to being unsold.