

# James Lee Square EN3

£299,950

LEASEHOLD

 2 BEDROOMS

 1 BATHROOMS

 1 RECEPTIONS

## Details

- CHAIN FREE
- LEASE: 189 YEARS FROM DEC 1997
- SERVICE CHARGE : £1,600 PER ANNUM (APPROXIMATELY)
- GROUND RENT: £100 PER ANNUM (APPROXIMATELY)
- TWO BEDROOM GROUND FLOOR APARTMENT
- GRADE II LISTED APARTMENT
- BEAUTIFUL VIEWS OVER THE CANAL STREAM
- MODERN BATHROOM (WHITE SUITE)
- SASH WINDOWS/HIGH CEILINGS
- COMMUNAL PARKING

EPC RATING: 55 (D)  
COUNCIL TAX: C

BREENS



## James Lee Square, Enfield, EN3

APPROX GROSS INTERNAL FLOOR AREA: 516 sq. ft / 48 sq. m

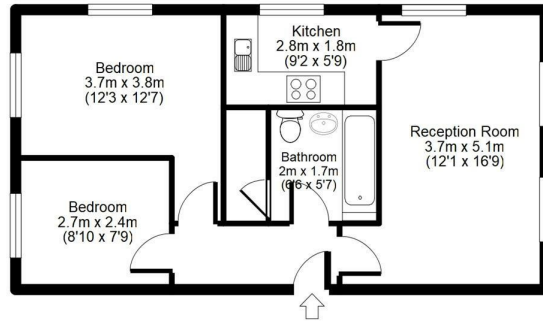

For identification purposes only  
Measurements are approximate and not to scale



**BREENS**

## Contact Us

020 8804 8989

[enfield@breenestateagents.co.uk](mailto:enfield@breenestateagents.co.uk)

[www.breenestateagents.co.uk](http://www.breenestateagents.co.uk)

557- 559 Hertford Road, Enfield, EN3 5UQ

All sizes are approximate. The Agent has not tested any apparatus, equipment, fixtures and fittings, or services and so cannot verify that they are in working order or fit for the purpose. A buyer is advised to obtain verification from their Solicitors or Surveyor. Photographs are for illustration purposes only and may depict items, which are not for sale or included in the sale price. References to tenure of a property are based upon Information supplied by the vendor. The agent has not had sight of the title documents, a buyer is advised to obtain verification from their solicitor.

Money Laundering Regulations 2003: Intending purchasers will be asked to produce identification, documentation at a later stage and we would ask for your co-operation in order that there will be no delay in agreeing the sale. These particulars are intended to give a fair description of the property only and are in no way guaranteed, nor do of any contract. They are issued on the express condition that all negotiations are conducted through Breens Estate Agents. All subject to contract and to being unsold.