

78 Lutterworth Road

Offers In Region Of £700,000

 4  3

No Onward Chain | Luxury family living | Prestigious location | Spacious driveway | Landscaped garden | Indian slate patio | Amtico herringbone flooring | Open-plan kitchen | Sky lantern | Master en-suite | Ideal for entertaining Must Be Viewed!

Floor Area

1948 sq. ft.

Tenure

Freehold

Service Charge

£ per annum

Ground Rent

£ per annum

- No Onward Chain
- 6 Car Driveway
- Bespoke Kitchen With Integrated Appliances & Granite Worktops
- Amtico herringbone flooring throughout
- 4 Double Bedrooms
- Fully Renovated Interior & Exterior
- Large & Private Rear Garden
- Ideal Entertainment Home

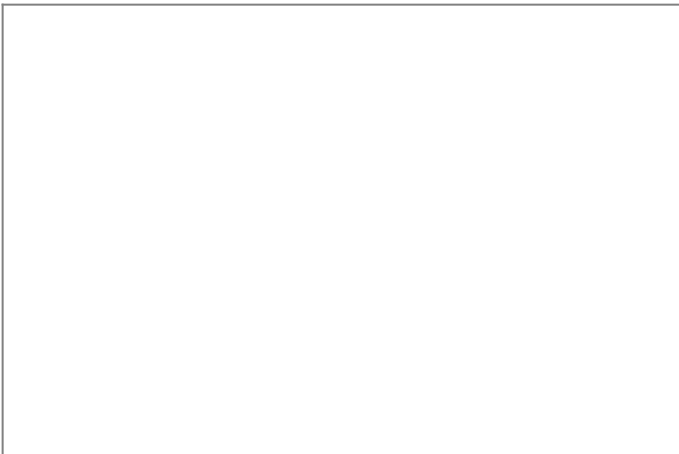

78 Lutterworth Road, Nuneaton, CV11 6PH

Approximate Gross Internal Area
1948 sq ft - 181 sq m

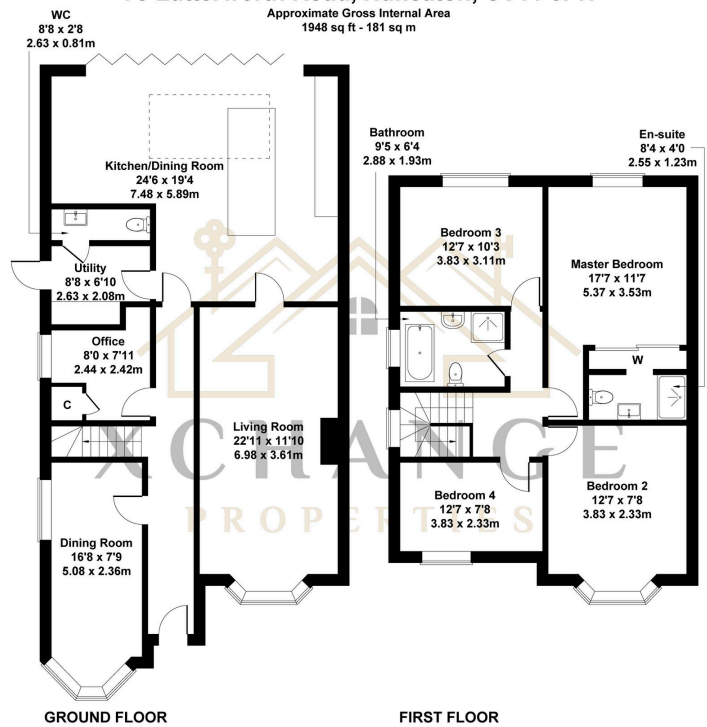

Not to Scale. Produced by The Plan Portal 2025
For Illustrative Purposes Only.