





152 Lutterworth Road

Guide Price £450,000

 4  1

Sought After Lutterworth Road Location | Nearly 2,000 sqft | Fantastic Size Rooms Throughout | 3/4 Bedrooms | Kitchen With Granite Worktops And Appliances | Lounge With Log Burner | Conservatory | Large Master Bedroom With Fitted Wardrobes | Parking For A Number Of Cars | Integral Garage

Floor Area

1948 sq. ft.

Tenure

Freehold

Service Charge

£ per annum

Ground Rent

£ per annum

- Nearly 2,000 SqFt!
- Lutterworth Road Location
- Fantastic size rooms throughout the house
- Kitchen with granite worktops and appliances
- Lounge with log Burner
- 3 bedrooms plus a further room on first floor
- Large master bedroom with fitted wardrobes
- Parking for a number of cars
- EPC - D | Council Tax Band - D
- Nuneaton & Bedworth Council



152 Lutterworth Road, Nuneaton, CV11 6PE
Approximate Gross Internal Area
1948 sq ft - 181 sq m

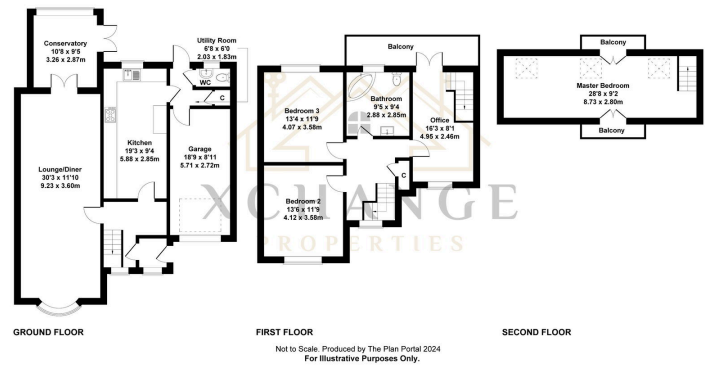

Energy Efficiency Rating		
	Current	Potential
<i>Very energy efficient - lower running costs</i>		
(92 plus) A		
(81-91) B		
(69-80) C		75
(55-68) D	58	
(39-54) E		
(21-38) F		
(1-20) G		
<i>Not energy efficient - higher running costs</i>		
England & Wales	EU Directive 2002/91/EC	