



SLATER BROOKING

Sales and Lettings

If you're selling, letting or just looking, contact Slater Brooking

Monsall Close, Greater Manchester, Bury, Sunny Bank, BL9

Offers Over £300,000

3 1 1



Welcome to this charming 3-bedroom semi-detached home, located on the peaceful and family-friendly Monsall Close, Bury. This inviting property offers a blend of modern comfort and practicality, featuring both front and rear gardens, off-road parking, and a detached garage for added convenience.



SLATER BROOKING

Sales and Lettings

If you're buying, selling or just looking, contact Slater Brooking



SLATER BROOKING

Sales and Lettings

If you're selling, letting or just looking, contact Slater Brooking

- 3 Bedroom Semi-Detached Property
- Off-Road Parking
- Detached Garage
- Modern Kitchen
- Conservatory
- Front and Rear Gardens
- Move-in-Ready
- Freehold
- Commuter Transport Links
- Close to Popular Local Schools

Ground Floor

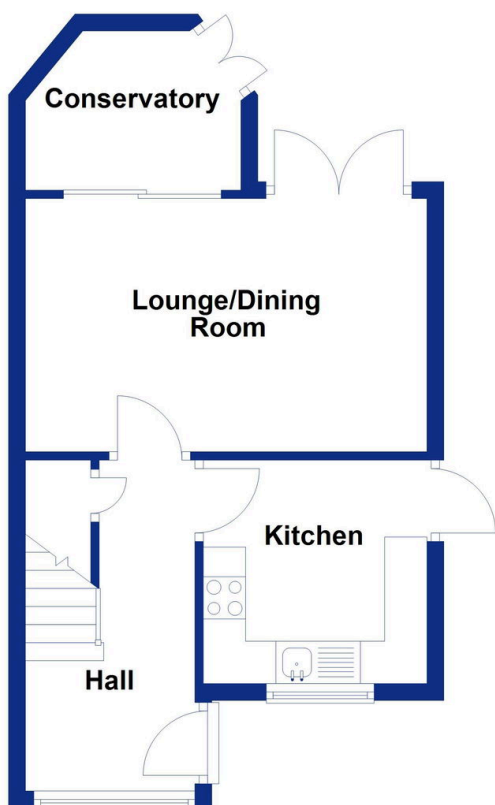

First Floor

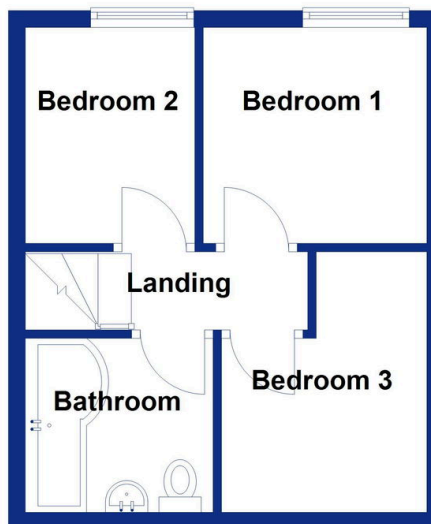

SLATER BROOKING

Sales and Lettings

If you're buying, selling or just looking, contact Slater Brooking