





SLATER BROOKING

Sales and Lettings

If you're selling, letting or just looking, contact Slater Brooking

Holmeswood Park, Rossendale, BB4

Guide Price £390,000

 4  2  2



An immaculately presented family home with south facing garden you're not going to want to miss!

Welcome to Holmeswood Park a stunning four bedroom detached family home nestled in the picturesque area of Rossendale. This property offers a perfect blend of modern comfort and timeless charm, boasting spacious living areas and a beautifully landscaped south facing garden perfect for those outdoor gatherings or just a peaceful retreat. This home is perfect for families seeking space and tranquillity, with four good sized bedrooms, including a generous master suite and living areas that provide ample space for relaxation and entertainment.

This property is conveniently located near local Rawtenstall amenities, excellent schools and breath taking views of the surrounding hills. This property presents a unique opportunity to experience Rossendale's beauty and community.

Don't miss the opportunity to make this beautiful property your new home by contacting us today!



SLATER BROOKING

Sales and Lettings

If you're buying, selling or just looking, contact Slater Brooking



SLATER BROOKING

Sales and Lettings

If you're selling, letting or just looking, contact Slater Brooking

- 4 Bedroom Detached House in a peaceful cul-de-sac
- Immaculately Presented
- Perfectly located for schools and local amenities
- Off-Road Parking and Integral Garage
- Freehold Property
- South Facing and Mature Gardens
- No Onward Chain
- Easy access to the motorway network and commuting to Manchester
- EPC Rating D
- Council Tax Band E

Ground Floor



First Floor

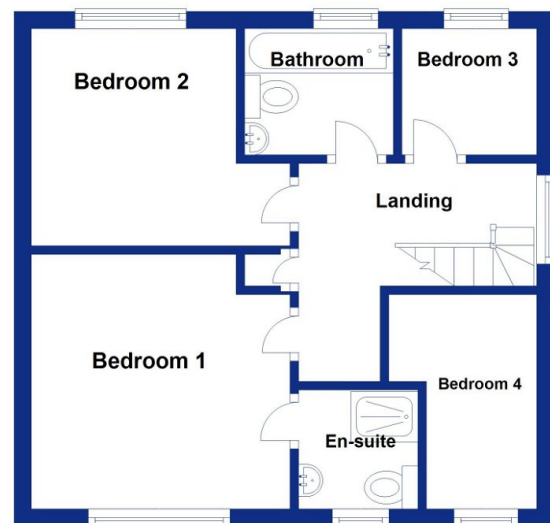

SLATER BROOKING

Sales and Lettings

If you're buying, selling or just looking, contact Slater Brooking