

ALLDAY  
& MILLER



Bournemead Close, Northolt, UB5 6PT  
£750,000

7 4 2 C



Bournemead Close, Northolt, UB5 6PT

**£750,000**

- Six / Seven Bedroom House
- Four Bathrooms
- Almost 2000 SQ.FT
- Driveway
- Easy Reach To A Central Line Station
- Semi-Detached Freehold
- Great Investment Potential
- Large Private Rear Garden
- No Onward Chain
- Good Schools Nearby

## Description

This semi-detached house comprises of a welcoming entrance hall that leads to two reception rooms, perfect for relaxation or entertaining. The ground floor also features two bedrooms, one with an ensuite and a kitchen which completes this floor.

Rising to the first floor, you will discover five bedrooms, offering ample space. Two further bathrooms on this level enhance the convenience of the home.

Outside, the property boasts a front drive with parking a valuable asset in this bustling area. The rear garden is a delightful retreat, mainly laid to lawn, providing a private space for outdoor dining.

## Situation

Bournemead Close a popular residential road close to a number of local amenities including the high street with its variety of local shops, cafes, bakery's and coffee shops. A number of highly regarded schools in the local area including St. Raphaels primary school and Barnhill Community High School. Northolt Underground Station and Northolt Park Railway Station are both just a short distance away with its several bus and train links to central London and the surrounding.



Floor Plans

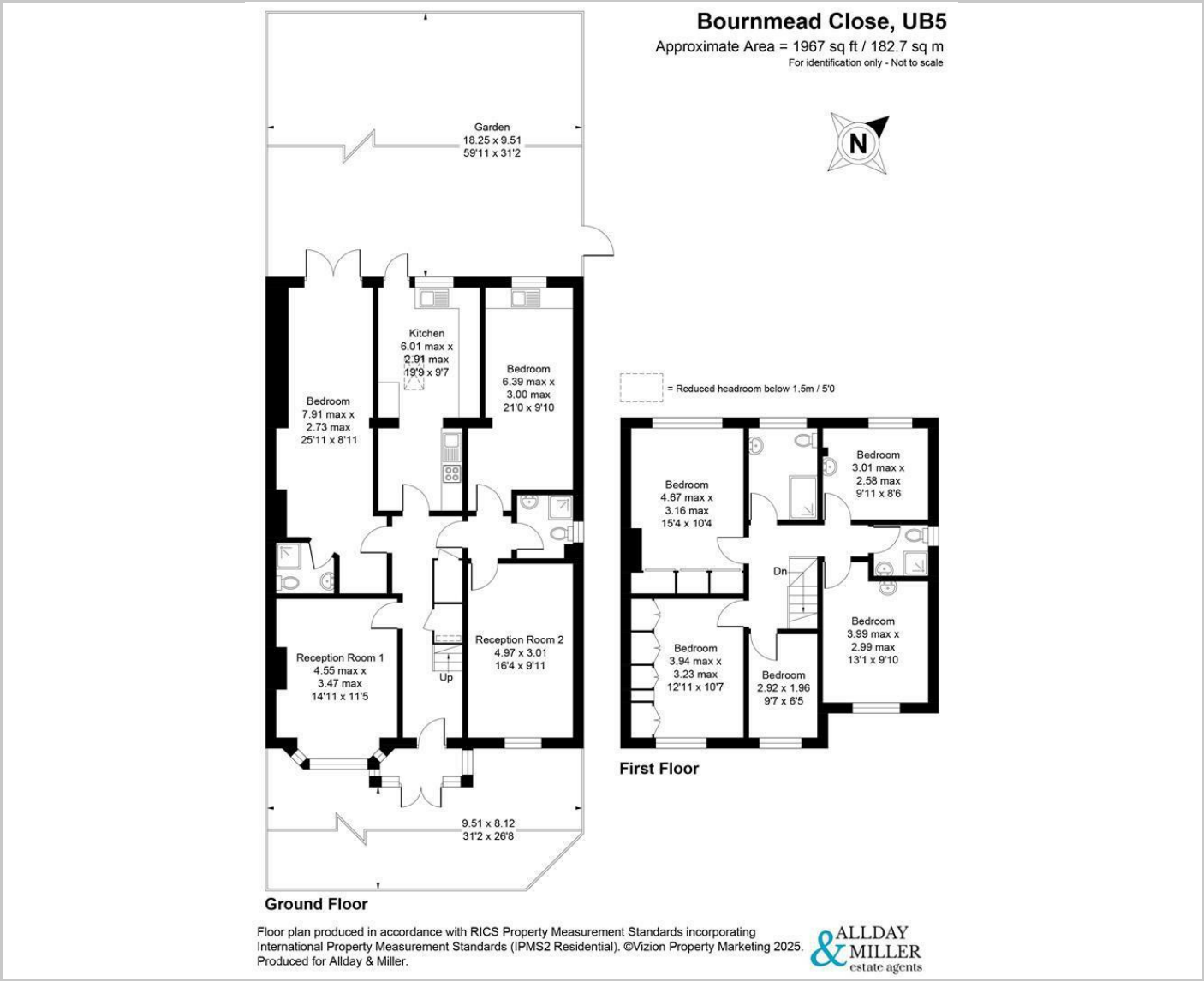

Area Map

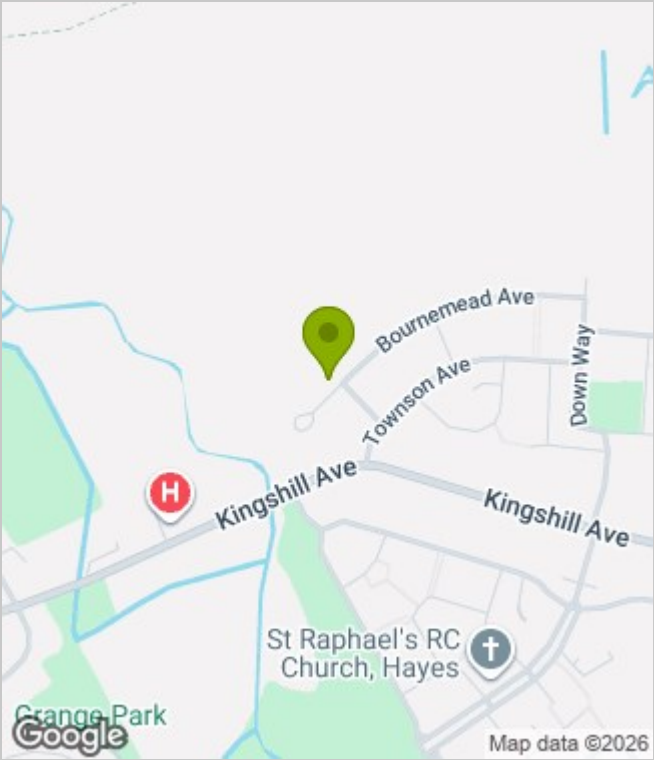

Energy Performance Graph

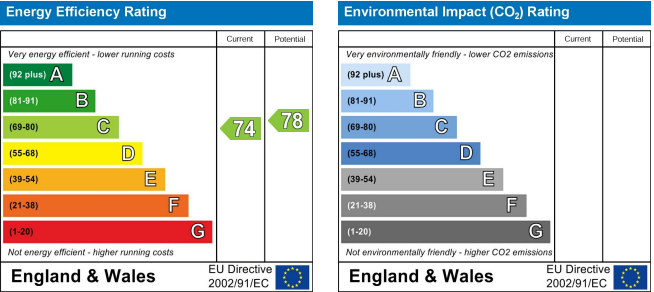

These particulars, whilst believed to be accurate are set out as a general outline only for guidance and do not constitute any part of an offer or contract. Intending purchasers should not rely on them as statements of representation of fact, but must satisfy themselves by inspection or otherwise as to their accuracy. No person in this firms employment has the authority to make or give any representation or warranty in respect of the property.