

ALLDAY
& MILLER



22 Farine Avenue, Hayes, UB3 4GD
£315,000





22 Farine Avenue, Hayes, UB3 4GD

£315,000

- One Bedroom Apartment
- 3.1 Metre High Ceiling
- 5 Minutes Walk To Elizabeth Line
- Newly Built In 2022
- Perfect For First Time Buyers & Investors
- Outdoor Balcony Space
- Over 900 Years Lease
- Totalling 555 Sq Ft
- Free Access To Well Maintained Gym
- Leasehold

Description

This property presented in stunning condition throughout boasts a bright airy reception and dining room, seamlessly integrating with a well fitted kitchen, this room also provides access to the delightful balcony , a spacious double bedroom, providing a comfortable retreat, while the modern bathroom adds a touch of luxury.

The development benefits from an on site gym, lift to all floors and communal garden areas.

Situation

Farine Avenue situated in the heart of Hayes just moments from Hayes & Harlington station with the Elizabeth line giving easy links to central London and the surrounding areas. There are several bus routes to local amenities including Brunel University, Heathrow Airport, Uxbridge town centre, Hounslow and Southall. Hayes town is within walking distance with its variety of local shops, cafes, coffee shops, takeaways and restaurants. The area is also served by highly regarded schools including Harlington secondary school and Pinkwell primary school.



Floor Plans

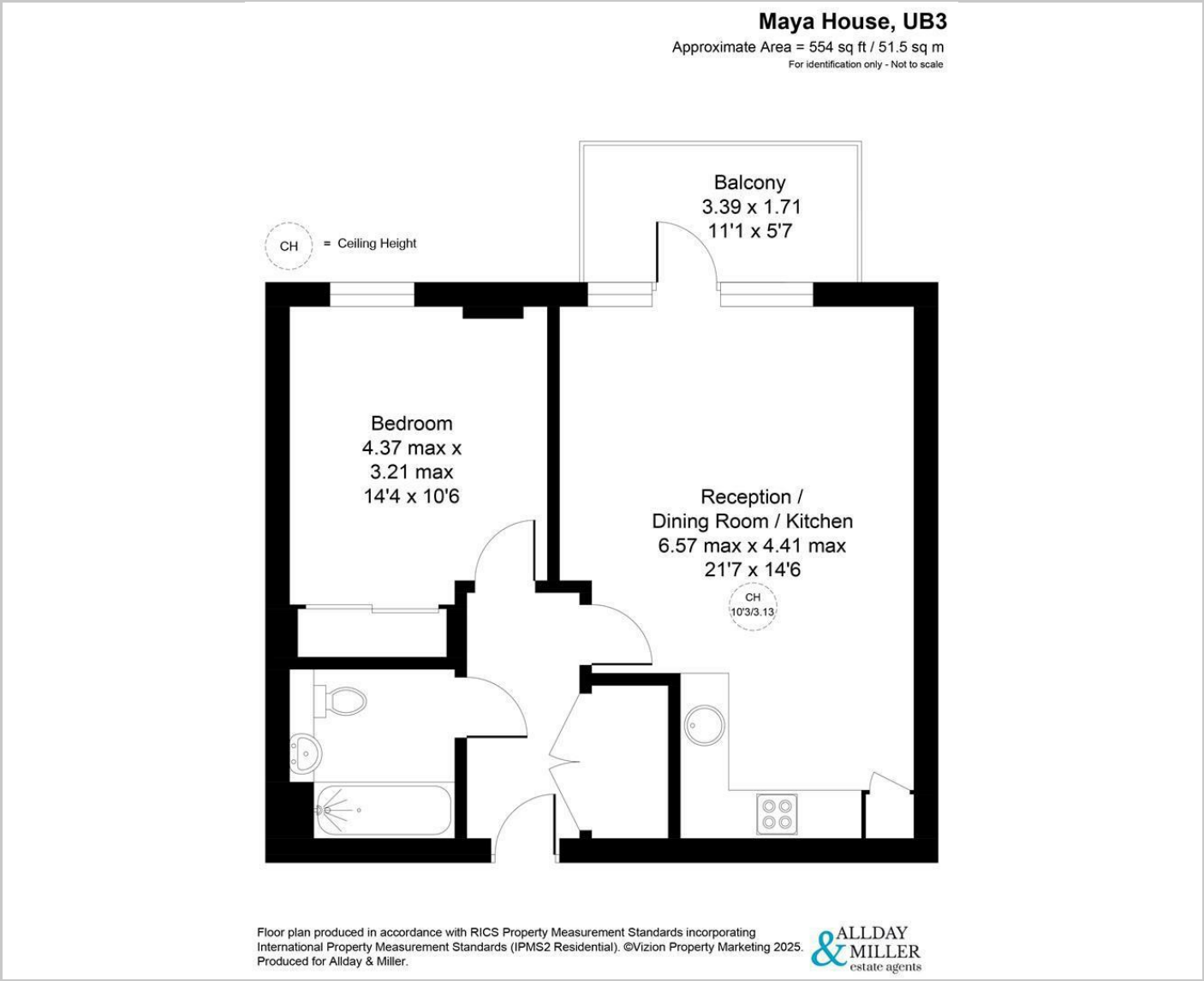

Area Map

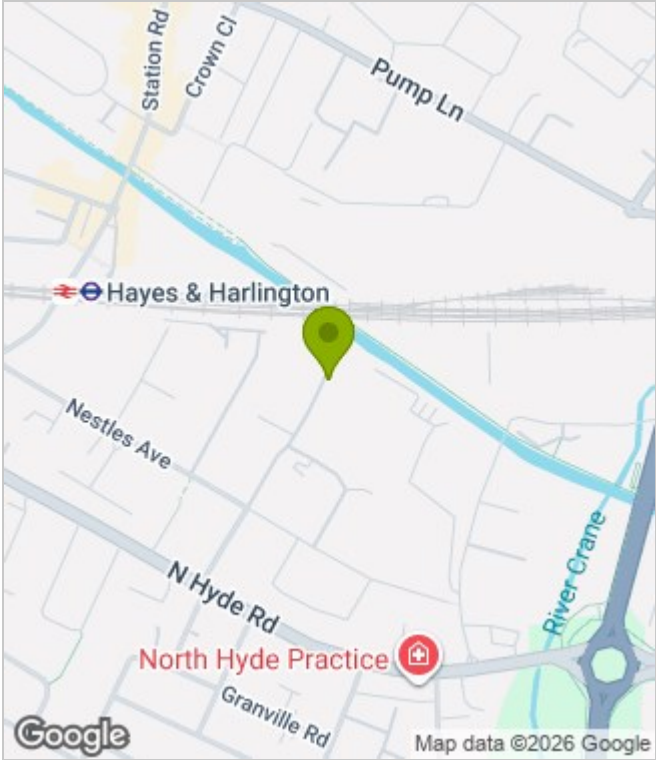

Energy Performance Graph

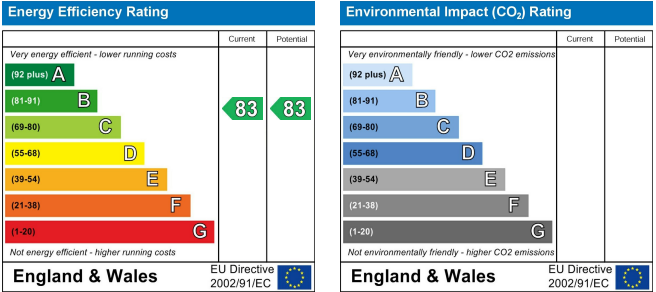

These particulars, whilst believed to be accurate are set out as a general outline only for guidance and do not constitute any part of an offer or contract. Intending purchasers should not rely on them as statements of representation of fact, but must satisfy themselves by inspection or otherwise as to their accuracy. No person in this firms employment has the authority to make or give any representation or warranty in respect of the property.