

ALLDAY
& MILLER

Maple Close, Hayes, UB4 9NH
£500,000

4 3 1 c



Maple Close, Hayes, UB4 9NH

£500,000

- Four Double Bedrooms
- Integral Garage
- Double Glazed Windows Including Front & Rear Doors
- Driveway Space For Two Cars
- Excellent Investment Opportunity (EPC C Rated)
- End Of Terraced Home
- Potential To Extend (STPP)
- Quiet Cul De Sac
- Cavity Insulation Throughout
- Loft Insulation

Description

This charming semi detached house offers a perfect blend of comfort and modern living, making it an ideal family home. Spanning an impressive 1,271 square feet, the property boasts a sleek fitted kitchen and dining area, designed for both functionality and style, alongside a convenient downstairs WC.

The first floor features a well appointed reception room, a spacious bedroom, and a family bathroom.

The second floor features three additional bedrooms, complemented by another bathroom.

Outside, the property benefits from a front drive that accommodates off street parking, along with access to a garage. The private rear garden offers a peaceful retreat, ideal for outdoor entertainment.

Situation

Maple Close with easy access to a variety of local amenities including Lombardy Retail Park and the Uxbridge Road with its array of shops and restaurants. Transport links here provide popular bus routes, the M4/A40 road links (providing access to London and The Home Counties), Heathrow Airport just a short drive away. The Elizabeth Line runs from Hayes & Harlington Station making the commute into Central London a breeze. A number of highly rated schools including Yeading Primary School and Barnhill Secondary School also within close proximity.



Floor Plans

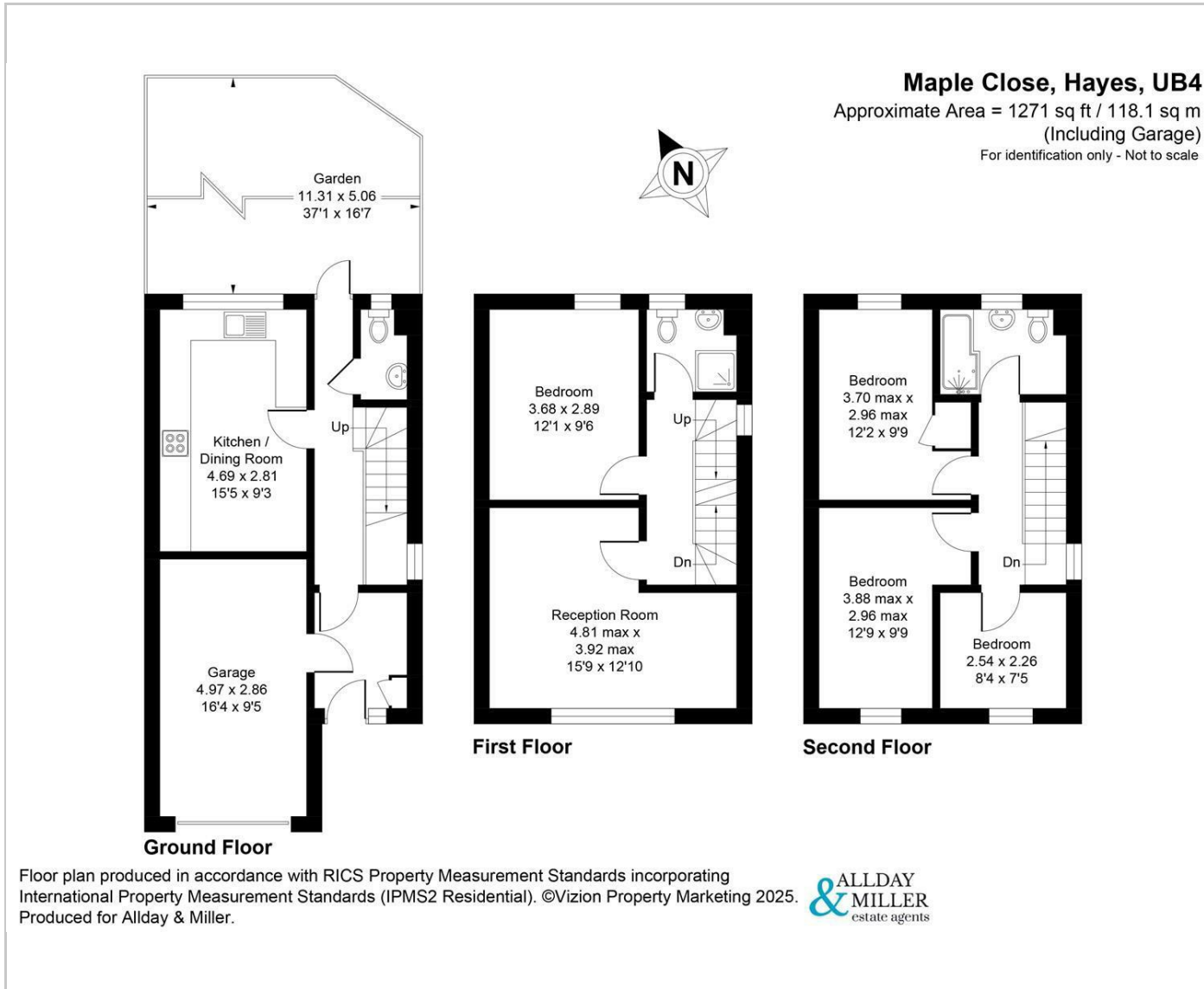

Area Map

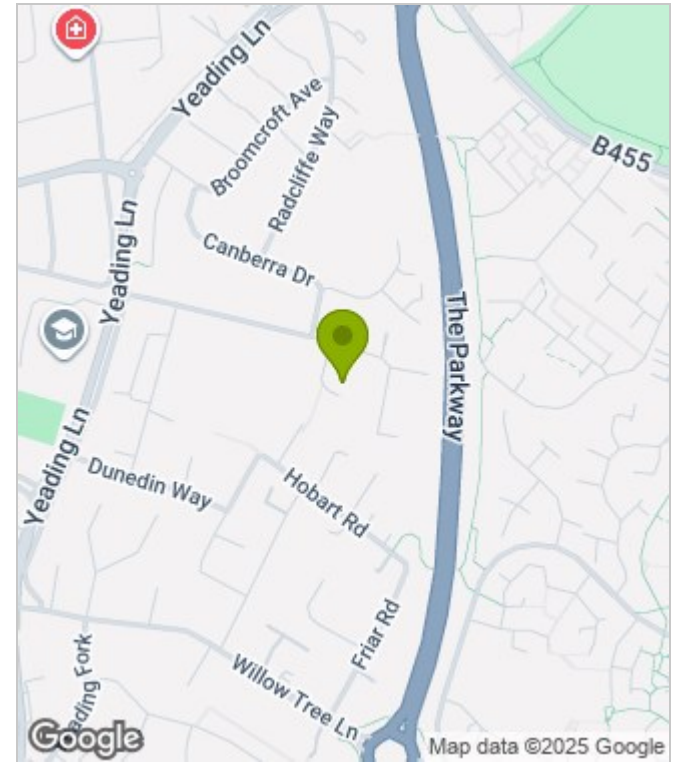

Energy Performance Graph

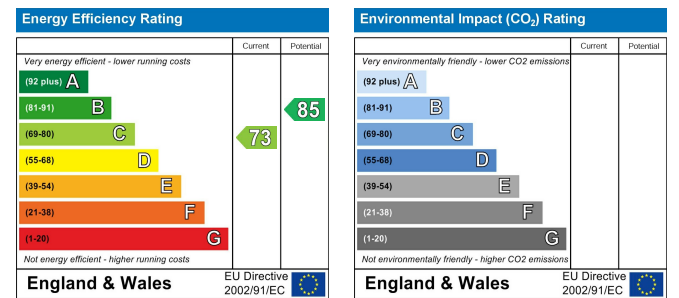

These particulars, whilst believed to be accurate are set out as a general outline only for guidance and do not constitute any part of an offer or contract. Intending purchasers should not rely on them as statements of representation of fact, but must satisfy themselves by inspection or otherwise as to their accuracy. No person in this firm's employment has the authority to make or give any representation or warranty in respect of the property.