

ALLDAY
& MILLER

Forris Avenue, Hayes, UB3 2AT
£340,000

2 1 1 c



Forris Avenue, Hayes, UB3 2AT

£340,000

- Split Level Maisonette
- Excellent Condition
- Quiet Residential Road
- Close To Local Amenities
- Garage
- Two Double Bedrooms
- Beautifully Kept Communal Grounds
- Great Location
- 129 Year Lease
- Close To Hayes & Harlington

Description

This delightful house presents an excellent opportunity for families seeking a spacious and well-maintained home. The property is in good condition, ensuring a comfortable living experience from the moment you step inside.

Upon entering, you are greeted by a welcoming reception room that flows seamlessly into a fitted kitchen and dining area. This open-plan layout is perfect for family gatherings and entertaining guests, with easy access to the rear.

The first floor boasts two generous bedrooms, providing ample space for rest and relaxation. Additionally, the modern bathroom on this level is conveniently located, catering to the needs of the household.

Situation

Forris Avenue located in the heart of Hayes. Hayes and Harlington station within a close proximity giving quick access links to Central London. Stockley Business Park, Heathrow Airport & the M4/M25 Motorways are also within easy reach. Uxbridge Town centre being a short drive away with an array of restaurants, coffee shops, bars and shopping centres. There are also a number of highly regarded schools including Hayes Park primary school and Grange Park.



Floor Plans

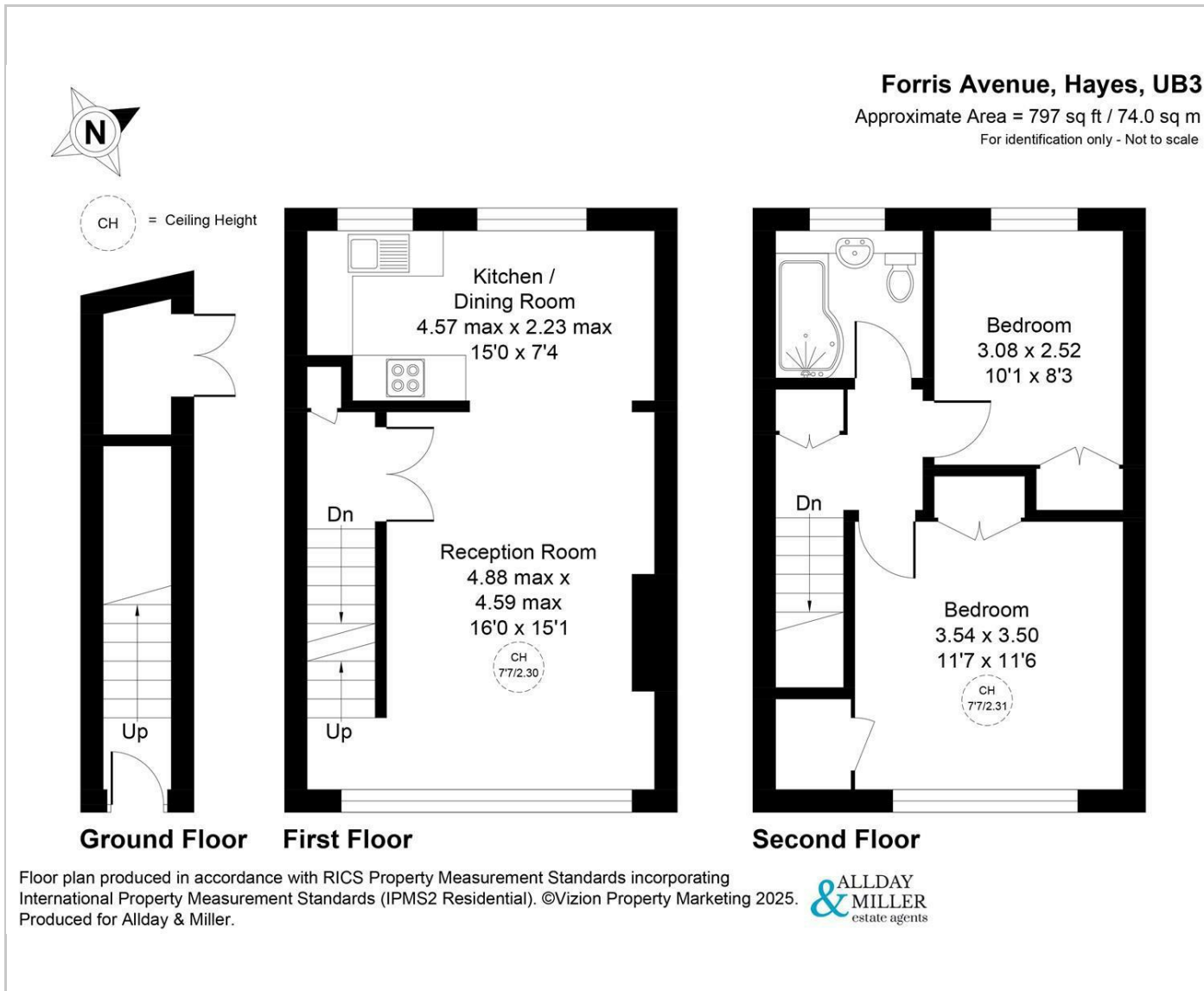

Area Map

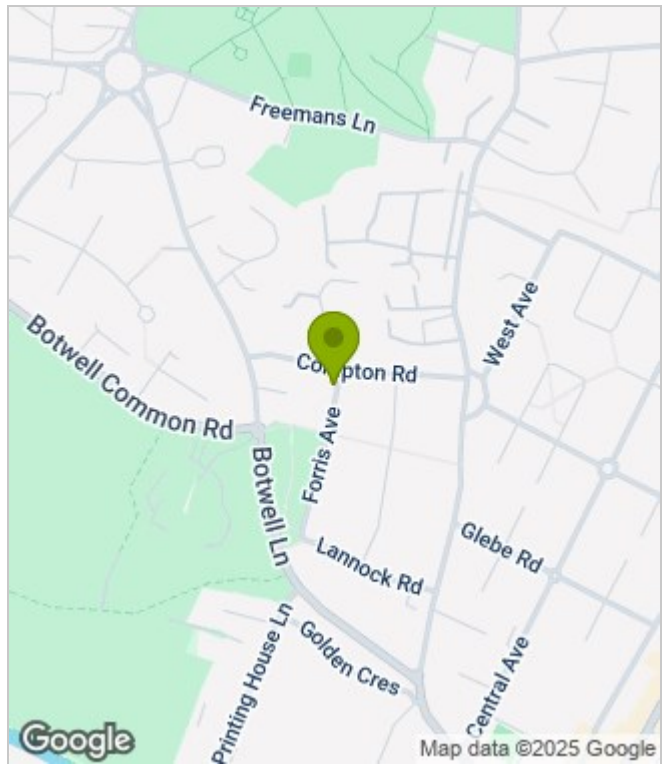

Energy Performance Graph

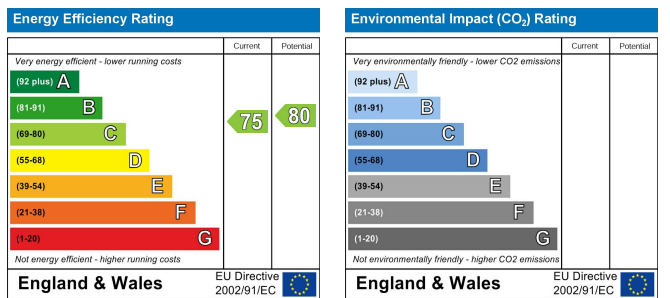

These particulars, whilst believed to be accurate are set out as a general outline only for guidance and do not constitute any part of an offer or contract. Intending purchasers should not rely on them as statements of representation of fact, but must satisfy themselves by inspection or otherwise as to their accuracy. No person in this firm's employment has the authority to make or give any representation or warranty in respect of the property.