

ALLDAY
& MILLER

Botwell Crescent, Hayes, UB3 2BE
£335,000





Botwell Crescent, Hayes, UB3 2BE

£335,000

- Ground Floor Garden Maisonette
- Large Rear Garden
- Stylishly Presented
- Front Aspect Living Room
- Potential To Extend STPP
- Long Lease
- Fitted Kitchen
- Driveway For Three Cars
- Modern Bathroom
- Good Local Schools

Description

This well-presented family home offers a delightful blend of comfort and practicality. The property features a bright and airy reception room, perfect for both relaxation and entertaining guests, two bedrooms, the family bathroom is conveniently located, ensuring ease of access for all and a fitted that leads directly to the rear garden.

Outside, the property boasts a front driveway, providing off-street parking for your convenience. The rear garden is a true gem, featuring a beautiful private space that is perfect for dining and entertainment. Additionally, there is an outbuilding studio, ideal for extra storage space.

Situation

Botwell Crescent is located just a short drive from Hayes & Harlington station giving easy links to Central London and the surrounding. Stockley Business Park, Heathrow Airport & the M4/M25 Motorways are also within an easy reach. Uxbridge Town centre being just an 11 minute drive away with an array of restaurants, coffee shops, bars and shopping centres. There are also a number of highly regarded schools including Hayes Park primary school and Grange Park.



Floor Plans

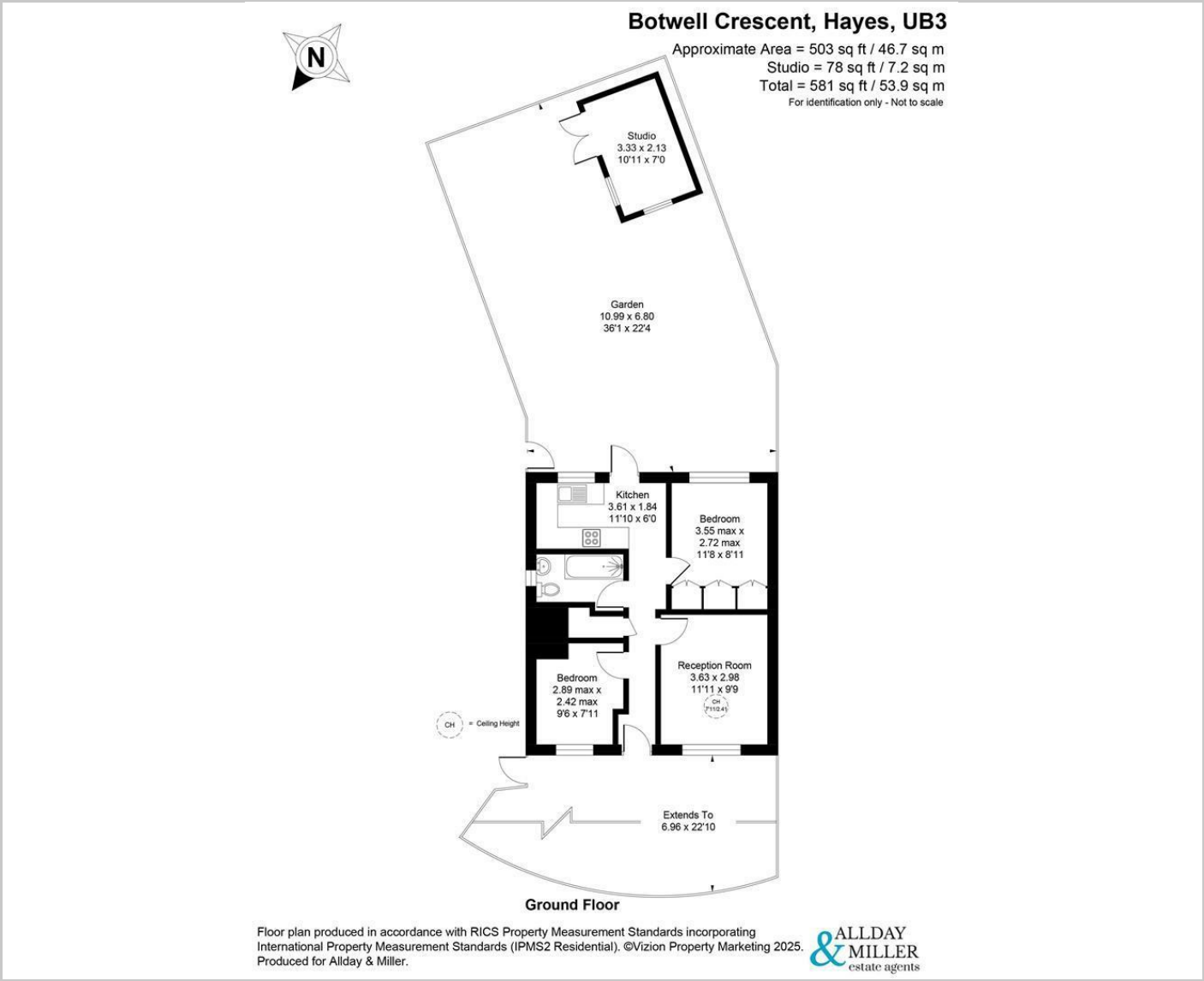

Area Map

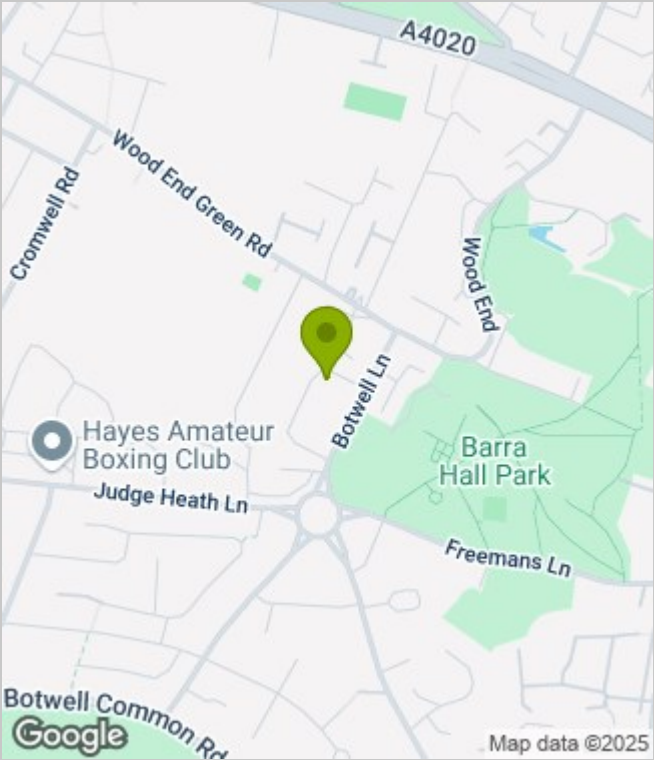

Energy Performance Graph

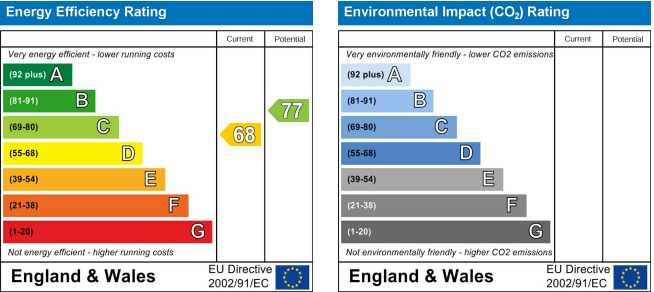

These particulars, whilst believed to be accurate are set out as a general outline only for guidance and do not constitute any part of an offer or contract. Intending purchasers should not rely on them as statements of representation of fact, but must satisfy themselves by inspection or otherwise as to their accuracy. No person in this firms employment has the authority to make or give any representation or warranty in respect of the property.