

ALLDAY  
& MILLER

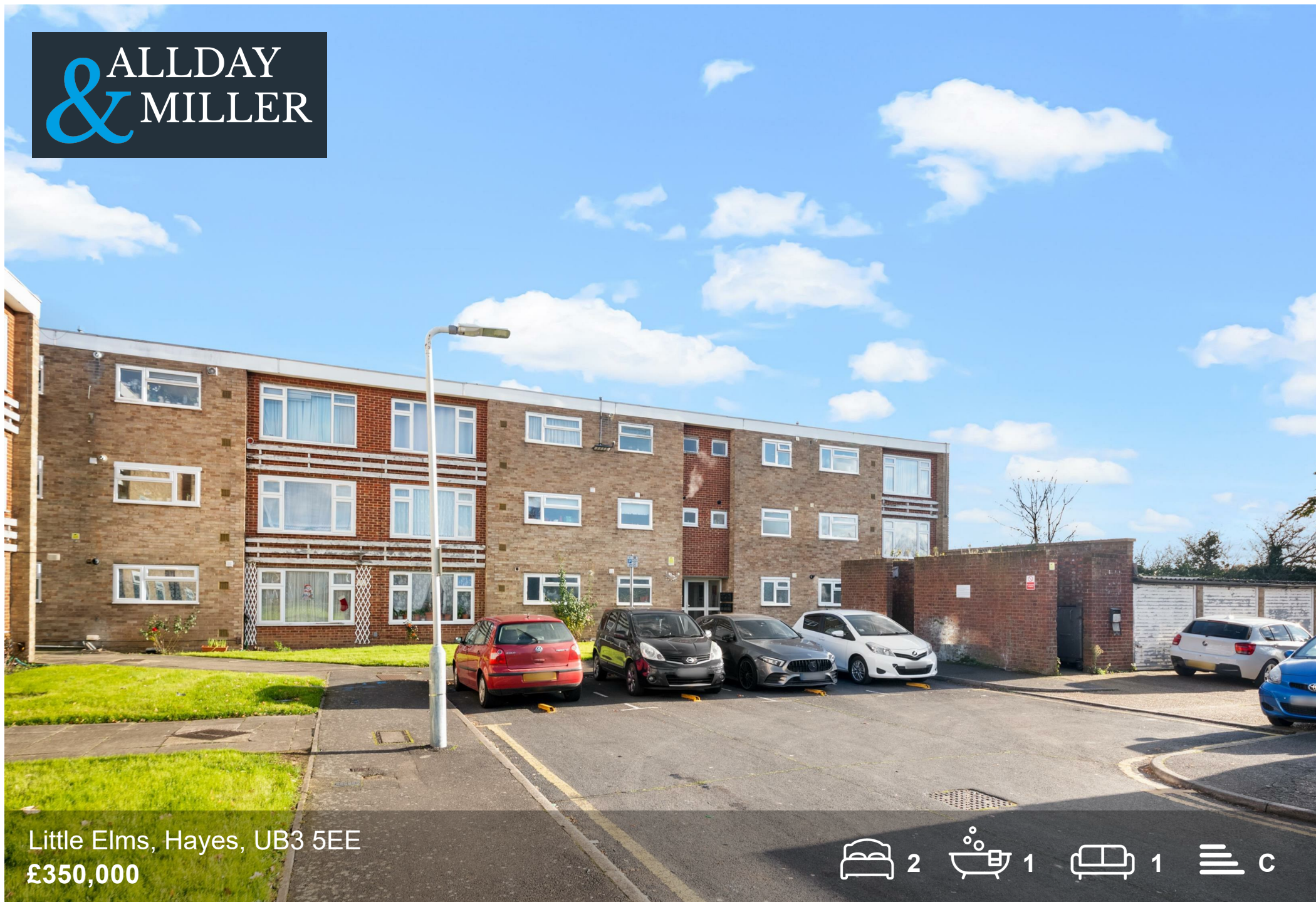

Little Elms, Hayes, UB3 5EE  
£350,000

2 1 1 c



Little Elms, Hayes, UB3 5EE

**£350,000**

- Two Double Bedrooms
- Chain Free
- Off Street Parking
- Fitted Kitchen
- Excellent Condition Throughout
- Brand New Lease
- Garage
- Great Transport Links

## Description

This well presented first floor property brought to the market comprises of two double bedrooms, family bathroom, modern fitted kitchen and a light filled reception/dining room.

The development benefits from well maintained communal gardens, a private garage and permit parking available for residents.

## Situation

Little Elms is situated just moments from the Bath Road in prime location to a number of local amenities including London Heathrow Airport Terminals 1, 2 & 3 just 0.8 Miles away, Heathrow Express Terminals 1, 2 & 3 Hatton Cross train station providing serval links to central London and the surrounding. A number of highly regarded schools in the local area including Harlington school and Botwell House catholic primary school. Hounslow Treaty centre being a 16 minute drive away with its variety of local shops, restaurants and coffee shops.



## Floor Plans

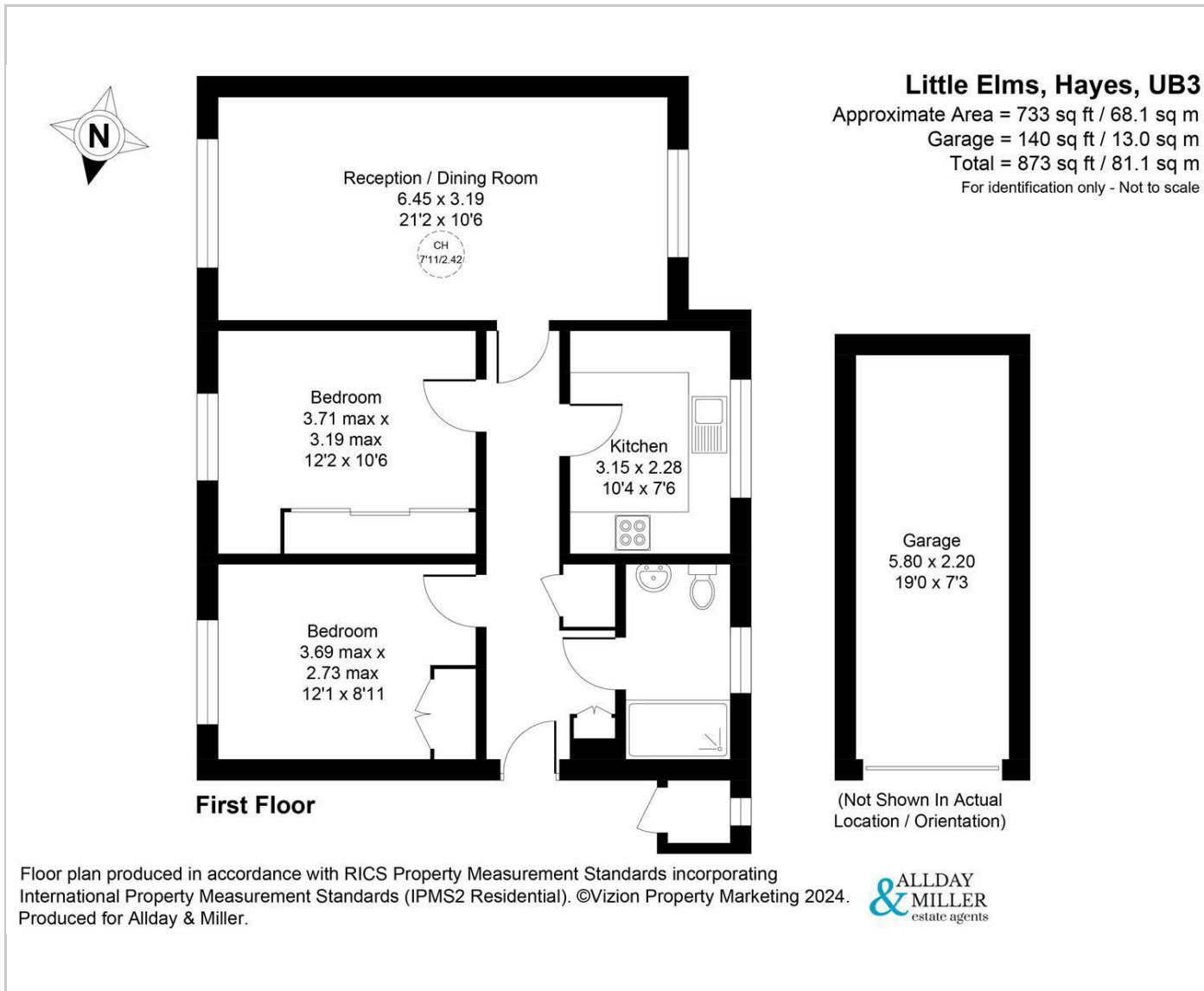

## Area Map

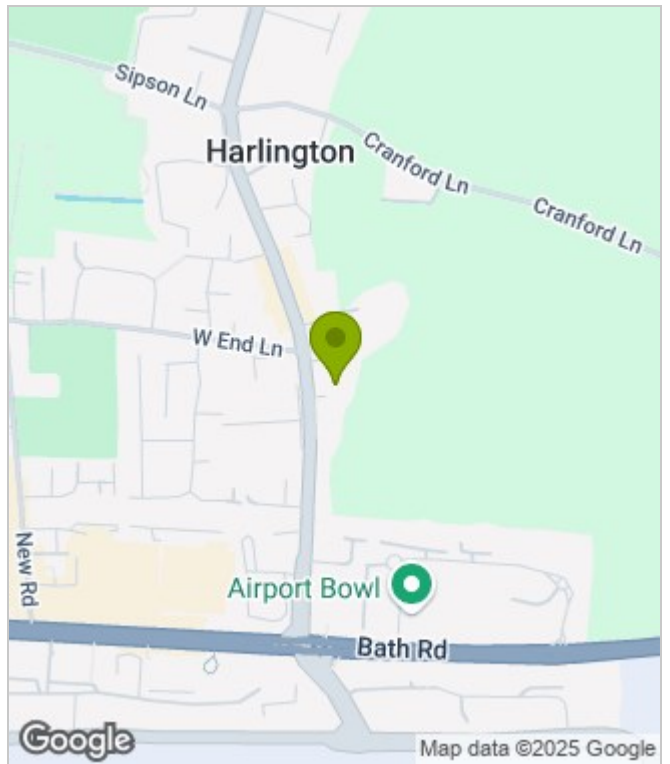

## Energy Performance Graph

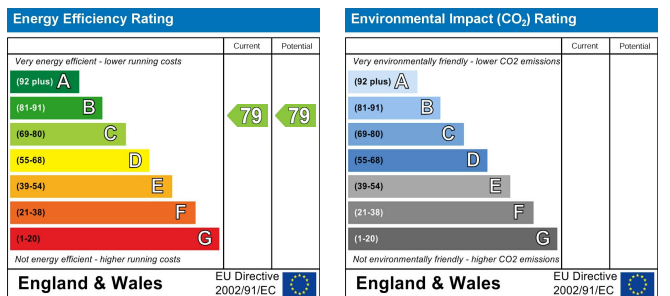

These particulars, whilst believed to be accurate are set out as a general outline only for guidance and do not constitute any part of an offer or contract. Intending purchasers should not rely on them as statements of representation of fact, but must satisfy themselves by inspection or otherwise as to their accuracy. No person in this firm's employment has the authority to make or give any representation or warranty in respect of the property.