

ALLDAY
& MILLER



Shelley Close, Hayes, UB4 0QW
£375,000

 2  1  1  E



Shelley Close, Hayes, UB4 0QW

£375,000

- Two/Three Bedrooms
- 933 Years Lease
- Immaculate Condition
- No Annual Service Charge
- Cul-De-Sac Location
- Ground Floor Maisonette
- Large Private Rear Garden
- Conservatory
- Garage
- North Hayes

Description

Welcoming to the market this larger than average two/three bedroom, stunning ground floor maisonette. The property offers huge benefits with over 900 years on the lease and no annual service charge.

This stylish maisonette comprises of a welcoming entrance porch, family bathroom, two double bedrooms, an office/third bedroom, light filled reception room which flows into the conservatory providing access to the rear.

A low maintenance front garden leads you to the accommodation. To the rear a private garden laid with artificial lawn perfect for outside dining and entertainment. A garage in a separate block also available, great for additional storage.

Situation

Shelley Close a popular cul-de-sac, situated just off Warley Road with its easy access to a number of local amenities including the Uxbridge Road with its variety of shops, cafes and restaurants. A number of highly regarded schools including Hayes Park and Whitehall Junior school. A number of road links with the M4/M25 and the A40 all within a short drive. Hayes & Harlington station being just a 10 minute drive with the Elizabeth Line providing an efficient route in to Central London.



Floor Plans

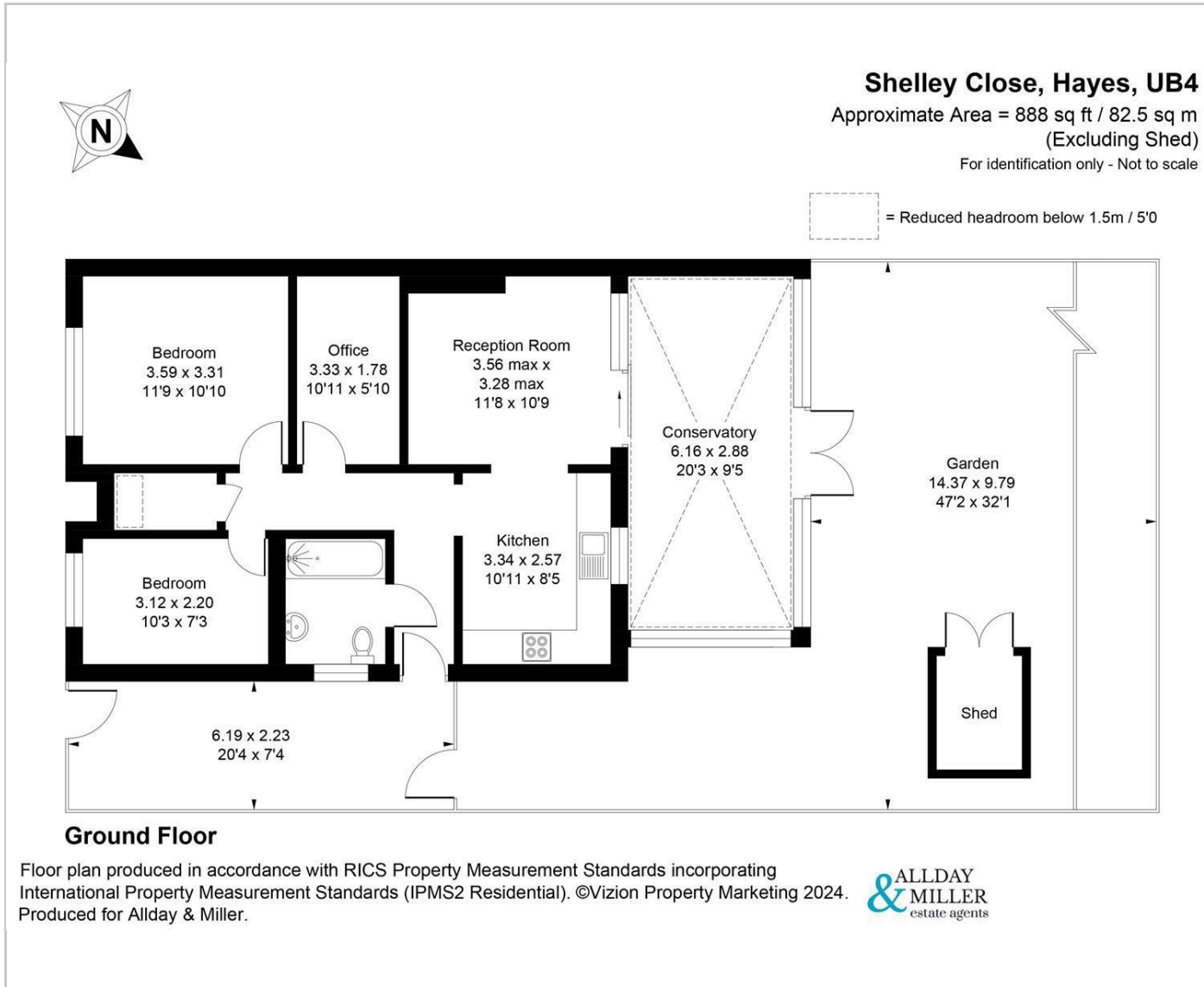

Area Map

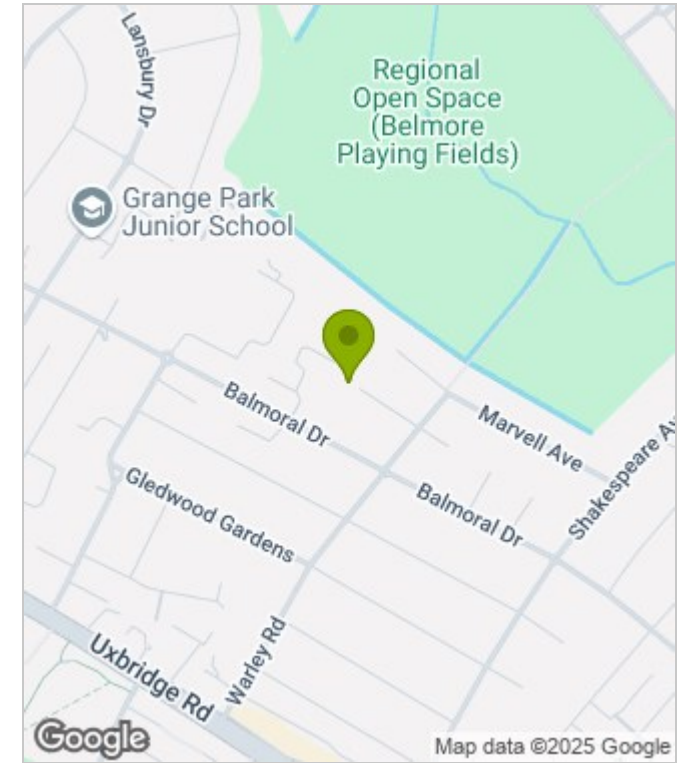

Energy Performance Graph

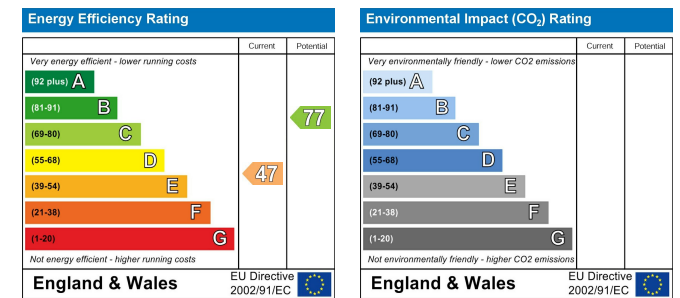

These particulars, whilst believed to be accurate are set out as a general outline only for guidance and do not constitute any part of an offer or contract. Intending purchasers should not rely on them as statements of representation of fact, but must satisfy themselves by inspection or otherwise as to their accuracy. No person in this firm's employment has the authority to make or give any representation or warranty in respect of the property.