

# TUDORS CLOSE

CALVERT, BUCKINGHAM

# Tudors Close

Calvert, Buckingham

A modern three-bedroom townhouse set over three floors, positioned on an extra-large plot with a generous, private south-west facing garden in a desirable Buckinghamshire village. Tucked away at the end of a close and backing onto open green space, the home enjoys a peaceful and secluded setting.

On the first floor the generous bedroom overlooking the garden is double aspect and comes with a fitted wardrobe. There is a smaller double bedroom to the front and a family bathroom in between the two rooms. Moving up to the second floor, the main bedroom has ample fitted storage and connects to a recently replaced ensuite shower room fully tiled with stylish metro tiles for a contemporary finish.

The garden is a standout feature. Larger than average, with two patios and mature borders. A garage, driveway, and additional parking complete the home.

## GUIDE PRICE

**£385,000**

 **3**

 **1**

 **2**

  
South Facing









Approximate Gross Internal Area = 100.8 sq m / 1085 sq ft

Garage = 13.2 sq m / 142 sq ft

Total = 114 sq m / 1227 sq ft

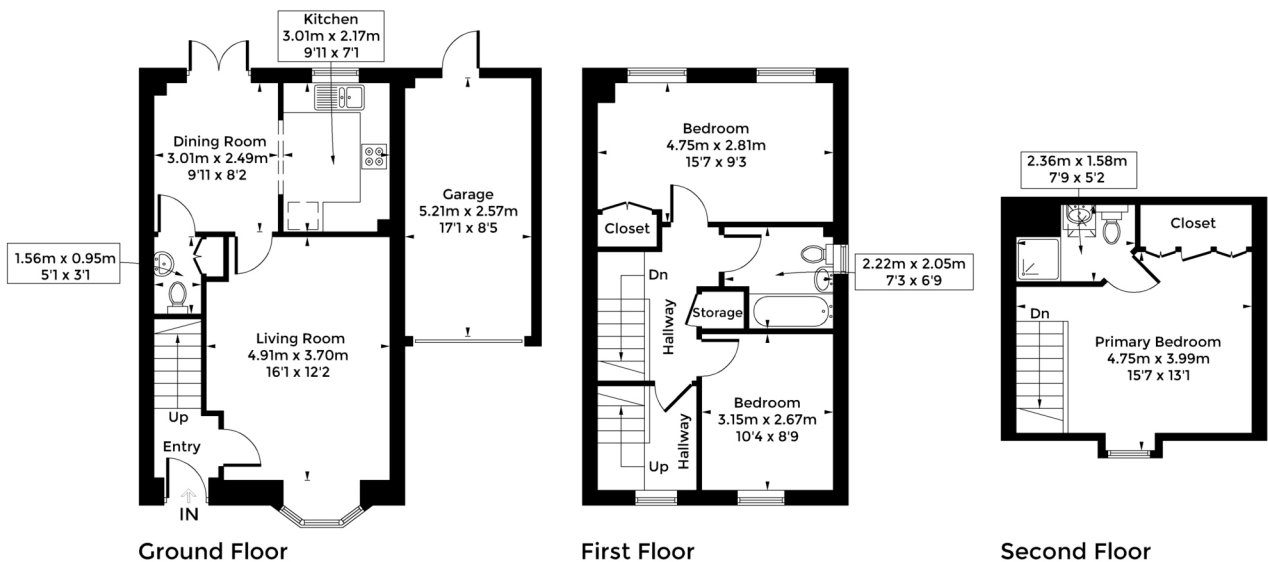

### Council Tax:

Band C - £2,137.31

### Parking:

Driveway Parking And Garage

### Local Authority:

Aylesbury Vale

# AWAITING EPC



# LOCATION COMMENT

*Calvert is a small village located approximately 5 miles northwest of the town of Buckingham and 10 miles West to Bicester making this an ideal location to pick up road connections to Oxford, M40 or Milton Keynes and the M1. Calvert is a charming and welcoming village that offers a peaceful and picturesque setting for residents and visitors alike. Calvert has a centre which includes a recreational park and community centre. Also close by is Great Moor Sailing Club and many country walks. The nearby market town of Buckingham offers schooling including the catchment Royal Latin grammar school, as well as a full range of sports, restaurants and shopping facilities.*

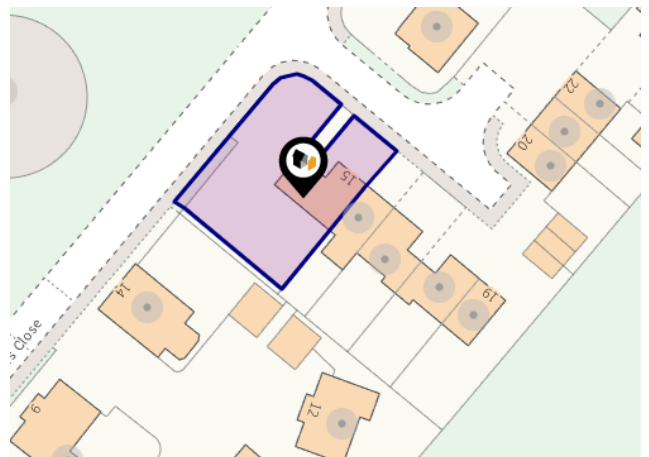



## OUR NETWORK OF OFFICES ACROSS OXFORDSHIRE

**Breckon & Breckon**  
est.1947



*Every office* has access to  
*every buyer* registered across  
our network of seven offices.

Sharing a single database of  
buyers ensures maximum  
exposure for our clients.

### Bicester Sales & Lettings

30 Market Square  
Bicester  
Oxfordshire  
OX26 6AG

t: 01869 24 24 23  
e: bicester@breckon.co.uk



**FROM LEFT:**  
Laura Conaty, Maxine Reynolds,  
Ken Cunha Lin

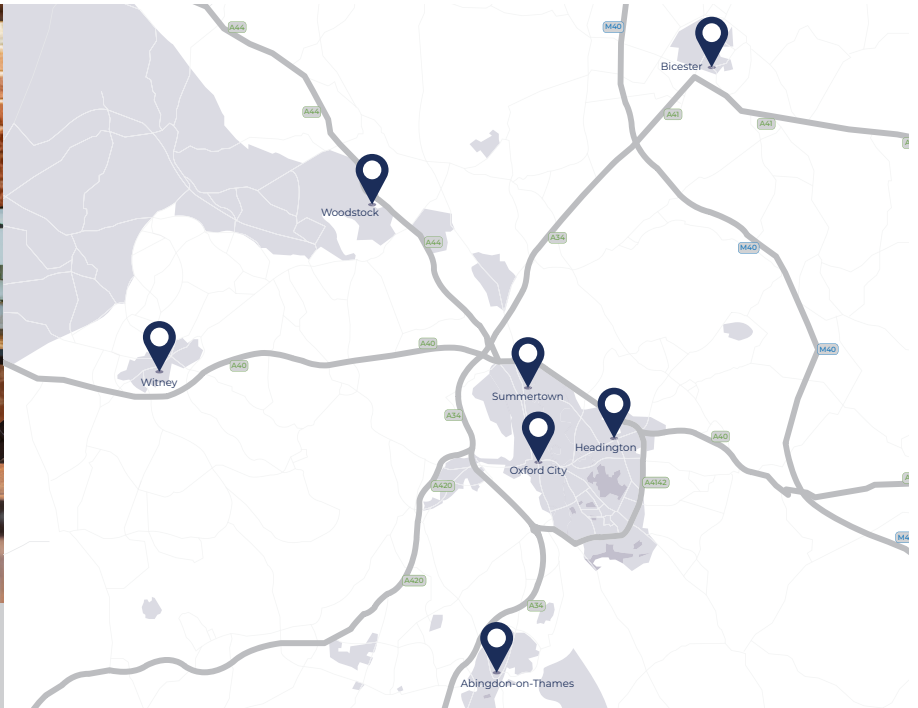

### Summertown

t: 01865 310 300 (sales)  
t: 01865 20 1111 (letting)  
e: summertown@breckon.co.uk

### Oxford City Centre

t: 01865 244 735 (sales)  
t: 01865 20 1111 (letting)  
e: post@breckon.co.uk

### Headington

t: 01865 750 200 (sales)  
t: 01865 763 999 (letting)  
e: headington@breckon.co.uk

### Abingdon-on-Thames

t: 01235 550 550 (sales)  
t: 01235 554 040 (letting)  
e: abingdon@breckon.co.uk

### Woodstock

t: 01993 811881 (sales)  
t: 01993 810 100 (letting)  
e: woodstock@breckon.co.uk

### Witney

t: 01993 776 775 (sales)  
t: 01993 899 972 (letting)  
e: witney@breckon.co.uk

### New Homes

t: 01865 261 222  
e: newhomes@breckon.co.uk

### Land Team

t: 01865 558 999  
e: land@breckon.co.uk

### Letting and Property Management

t: 01865 20 1111  
e: lettings@breckon.co.uk

### Creative Department

t: 01865 310 300  
e: creative@breckon.co.uk

### Bespoke by Breckon

t: 01865 765 555  
e: bespoke@breckon.co.uk



IMPORTANT NOTICE: These particulars are for information purposes only and do not in whole or in part constitute or form part of any offer or contract, nor should any statement obtained herein be relied upon as a statement or representation of fact. Breckon & Breckon do not test whether the services connected to the property, heating systems and domestic appliances are in working order. We therefore recommend that the purchaser obtains verification from their surveyor or solicitor. Whilst every attempt has been made to ensure the accuracy of the floor plans contained here, measurements of doors, windows and rooms are approximate and no responsibility is taken for any error, omission or mis-statement. These plans are for representation purposes only as defined by the RICS code of measuring practice and should be used as such by any possible purchaser.