

# MONTGOMERY ROAD

CAVERSFIELD, BICESTER

# Montgomery Road

Caversfield, Bicester

A spacious four-bedroom detached home with a south-facing garden, located in the desirable Statton Fields area of Caversfield. Set back from the road in a peaceful no-through location, the home offers excellent privacy and a welcoming feel.

The large entrance hall with an upgraded cloakroom opens to an inviting living room with a feature fireplace. This flows into a bright dining room with French doors to the garden, and a well-appointed kitchen with garden access. An office/fifth bedroom completes the ground floor.

Upstairs, there are four double bedrooms, including a principal suite with a stylish ensuite and a matching refitted shower room. Outside, the south-facing garden features a patio, lawn, and brick-built shed. There's parking for 2-3 vehicles and planning permission for a garage & utility extension.

## GUIDE PRICE

**£500,000**



South Facing









Approximate Gross Internal Area = 145 sq m / 1560 sq ft  
 Brick Shed = 3.0 sq m / 32 sq ft  
 Total = 148.0 sq m / 1592 sq ft

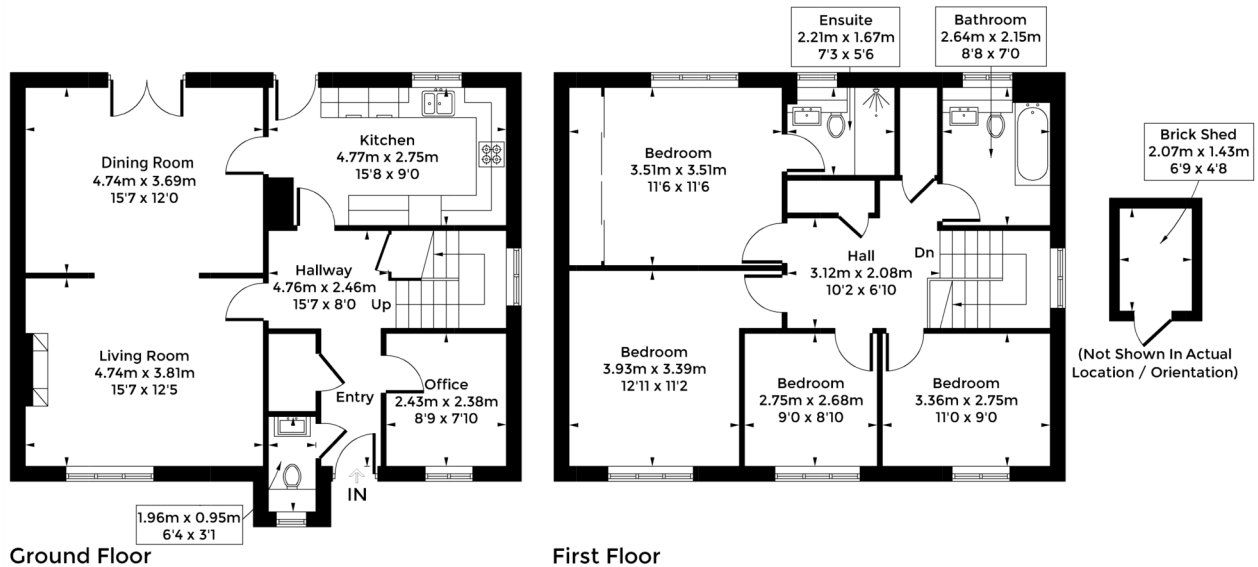

**Council Tax:**  
Band E

**Parking:**  
Driveway Parking

**Local Authority:**  
Cherwell District Council

20 Montgomery Road  
Caversfield  
BICESTER  
OX27 8FG

Energy rating

**D**

Valid until  
**27 February 2034**

Certificate number  
**2034-3222-2300-0457-5226**



# LOCATION COMMENT

*Situated on the edge of Bicester, Caversfield has great access to open countryside yet is only 1.5 miles to Bicester town centre. In the centre of the village is a fantastic large park popular with dog walkers, with a running track and children's play area and tennis courts. Caversfield is also home to Bicester Heritage, a former RAF base and now home to some fantastic events and Sky Wave Gin bar, the perfect place for an evening drink.*

*Bicester North station is short drive away and offers a great commuter service to London Marylebone in around 45 minutes and you can reach Birmingham in 1 hour.*





## OUR NETWORK OF OFFICES ACROSS OXFORDSHIRE

**Breckon & Breckon**  
est.1947



*Every office* has access to  
*every buyer* registered across  
our network of seven offices.

Sharing a single database of  
buyers ensures maximum  
exposure for our clients.

### Bicester Sales & Lettings

30 Market Square  
Bicester  
Oxfordshire  
OX26 6AG

t: 01869 24 24 23  
e: bicester@breckon.co.uk



**FROM LEFT:**  
Laura Conaty, Maxine Reynolds,  
Ken Cunha Lin

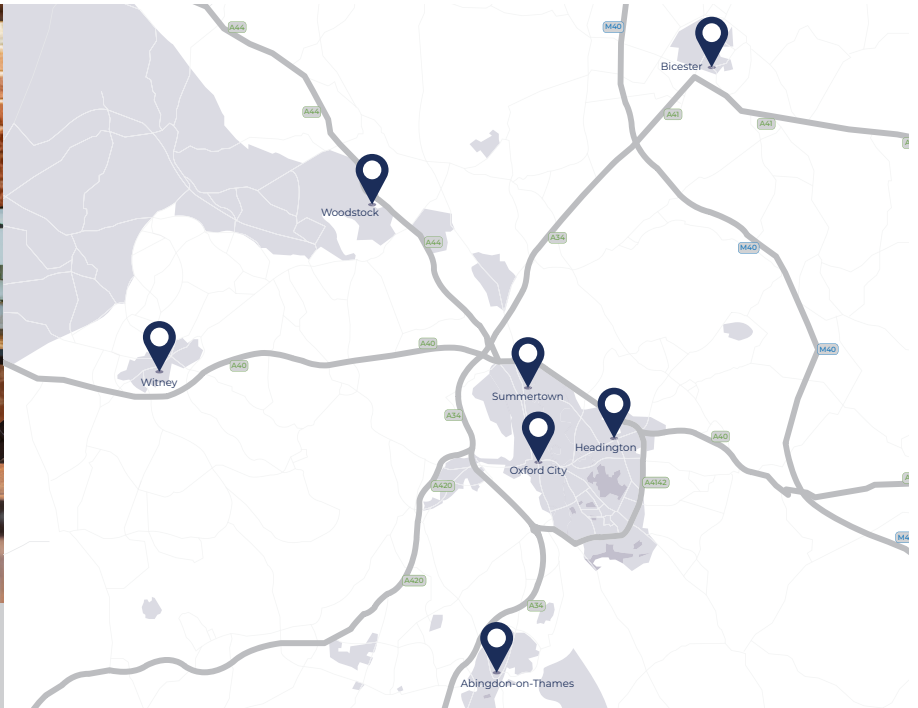

### Summertown

t: 01865 310 300 (sales)  
t: 01865 20 1111 (letting)  
e: summertown@breckon.co.uk

### Oxford City Centre

t: 01865 244 735 (sales)  
t: 01865 20 1111 (letting)  
e: post@breckon.co.uk

### Headington

t: 01865 750 200 (sales)  
t: 01865 763 999 (letting)  
e: headington@breckon.co.uk

### Abingdon-on-Thames

t: 01235 550 550 (sales)  
t: 01235 554 040 (letting)  
e: abingdon@breckon.co.uk

### Woodstock

t: 01993 811881 (sales)  
t: 01993 810 100 (letting)  
e: woodstock@breckon.co.uk

### Witney

t: 01993 776 775 (sales)  
t: 01993 899 972 (letting)  
e: witney@breckon.co.uk

### New Homes

t: 01865 261 222  
e: newhomes@breckon.co.uk

### Land Team

t: 01865 558 999  
e: land@breckon.co.uk

### Letting and Property Management

t: 01865 20 1111  
e: lettings@breckon.co.uk

### Creative Department

t: 01865 310 300  
e: creative@breckon.co.uk

### Bespoke by Breckon

t: 01865 765 555  
e: bespoke@breckon.co.uk



IMPORTANT NOTICE: These particulars are for information purposes only and do not in whole or in part constitute or form part of any offer or contract, nor should any statement obtained herein be relied upon as a statement or representation of fact. Breckon & Breckon do not test whether the services connected to the property, heating systems and domestic appliances are in working order. We therefore recommend that the purchaser obtains verification from their surveyor or solicitor. Whilst every attempt has been made to ensure the accuracy of the floor plans contained here, measurements of doors, windows and rooms are approximate and no responsibility is taken for any error, omission or mis-statement. These plans are for representation purposes only as defined by the RICS code of measuring practice and should be used as such by any possible purchaser.