

CORNER COTTAGE  
CHESTERTON

[BRECKON.CO.UK](http://BRECKON.CO.UK)

# Corner Cottage, Chesterton

Bicester, OX26 1UQ

Corner Cottage is a substantial detached stone cottage set in a conservation area of this desirable North Oxfordshire village.

This impressive house is set within a large plot approaching a third of an acre and dates back to 1860 retaining many charming character features and has been extended in more recent years to provide a wonderful home ideal for modern family living.

The centrepiece is an open plan kitchen/breakfast/dining room with a vaulted ceiling and exposed brick and stone. Two spacious sitting rooms sit on either side of the front reception hallway, each with lovely, exposed brick fireplaces with wood burners and oak beams. On the ground floor there is also a study/fifth bedroom and bike store. Underfloor heating runs throughout the majority of the ground floor space.

A contemporary sweeping oak staircase with black metal spindles rises to the first floor where you will find two generous double bedrooms, both double aspect and with fitted storage. The principal bedroom comes with an ensuite shower room. The staircase continues to the third floor with two further bedrooms with exposed stone walls.

**Guide Price: £1,000,000**

 4

 3

 3



South Facing









Approximate Gross Internal Area = 260.5 sq m / 2804 sq ft  
 Outbuildings = 75.2 sq m / 809 sq ft  
 Total = 335.7 sq m / 3613 sq ft



Ground Floor



Second Floor

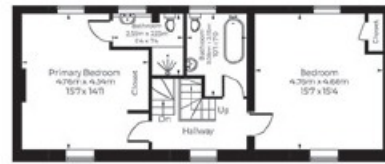

First Floor



[Not Shown in Actual Location / Orientation]



**Council Tax:**  
Band F

**Parking**  
Driveway parking

**Local Authority**  
Cherwell District  
Council

Corner Cottage  
Chesterton  
BICESTER  
OX26 1UQ

Energy rating

**D**

Valid until

**15 July 2034**

Certificate number

**9057-3040-9203-3204-0204**

IMPORTANT NOTICE: These particulars are for information purposes only and do not in whole or in part constitute or form part of any offer or contract, nor should any statement obtained herein be relied upon as a statement or representation of fact. Breckon & Breckon do not test whether the services connected to the property, heating systems and domestic appliances are in working order. We therefore recommend that the purchaser obtains verification from their surveyor or solicitor. Whilst every attempt has been made to ensure the accuracy of the floor plans contained here, measurements of doors, windows and rooms are approximate and no responsibility is taken for any error, omission or mis-statement. These plans are for representation purposes only as defined by the RICS code of measuring practice and should be used as such by any possible purchaser.



# “Location Comments”

*Chesterton is a pretty village approximately 15 miles north of Oxford and 2.3 miles south of Bicester. Within the village there are excellent local amenities including a local primary school, Bruern Abbey Prep School, a village hall with sports facilities, The Chesterton Hotel and restaurant, The Red Cow Public House and Bicester Hotel Golf and Spa which has a performance gym.*

*Bicester town centre offers a great choice of restaurants, a Cinema and Sainsbury's supermarket. Internationally acclaimed Bicester Village designer outlet, and Bicester Shopping Park including an M&S Food Hall, and David Lloyd health club can all be found.*





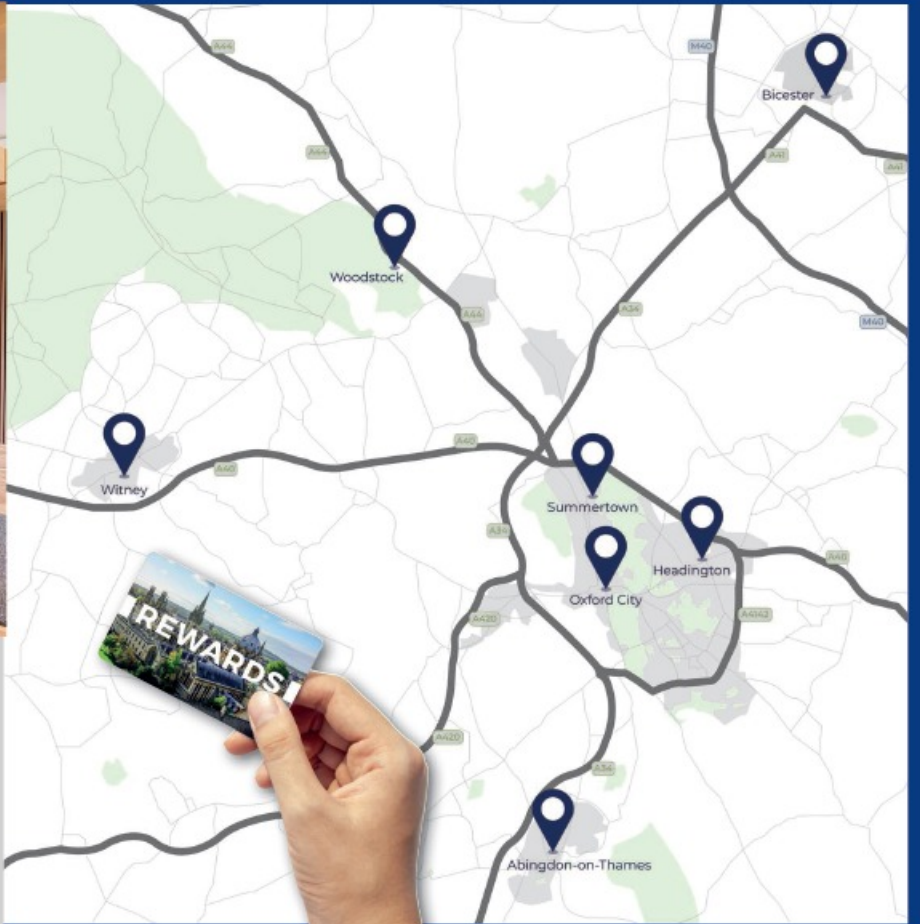

## Our network of offices across Oxfordshire

*Every office* has access to *every buyer* registered across our network of seven offices.

Sharing a single database of buyers ensures maximum exposure for our clients.

### Bicester Sales & Lettings

30 Market Square  
Bicester  
Oxfordshire  
OX26 6AG

t: 01869 242423  
e: bicester@breckon.co.uk



**FROM LEFT:**  
Ken Cunhao Lin, Maxine Reynolds,  
Laura Conaty

**BRECKON  
REWARDS**  
Scan to find  
out more!



**naea  
propertymark**  
**PROTECTED**

### Summertown

t: 01865 310300 (sales)  
t: 01865 201111 (letting)  
e: summertown@breckon.co.uk

### Oxford City Centre

t: 01865 244735 (sales)  
t: 01865 201111 (letting)  
e: post@breckon.co.uk

### Headington

t: 01865 750200 (sales)  
t: 01865 763999 (letting)  
e: headington@breckon.co.uk

### Abingdon-on-Thames

t: 01235 550550 (sales)  
t: 01235 554040 (letting)  
e: abingdon@breckon.co.uk

### Woodstock

t: 01993 811881 (sales)  
t: 01993 810100 (letting)  
e: woodstock@breckon.co.uk

### Witney

t: 01993 776775 (sales)  
t: 01993 899972 (letting)  
e: witney@breckon.co.uk

### New Homes

t: 01865 261222  
e: newhomes@breckon.co.uk

### Land Team

t: 01865 558999  
e: land@breckon.co.uk

### Letting and Property Management

t: 01865 201111  
e: lettings@breckon.co.uk

### Creative Department

t: 01865 310300  
e: creative@breckon.co.uk

**Breckon & Breckon**  
est. 1947