



SAB
ESTATES

Margil House, Singapore Road, London

Offers Over **£550,000**

SAB
ESTATES



Margil House, Singapore Road

West Ealing, London

- Spacious Open-Plan Kitchen & Living Area
- Private Balcony with Open Outlook
- Allocated Parking Included
- Modern Development in Excellent Condition
- Offered Chain-Free
- Just 10 Minutes to West Ealing Station (Elizabeth Line)
- Moments from Shops, Cafes & Local Amenities

Council Tax band: D

Tenure: Leasehold

EPC Energy Efficiency Rating: B

EPC Environmental Impact Rating: A



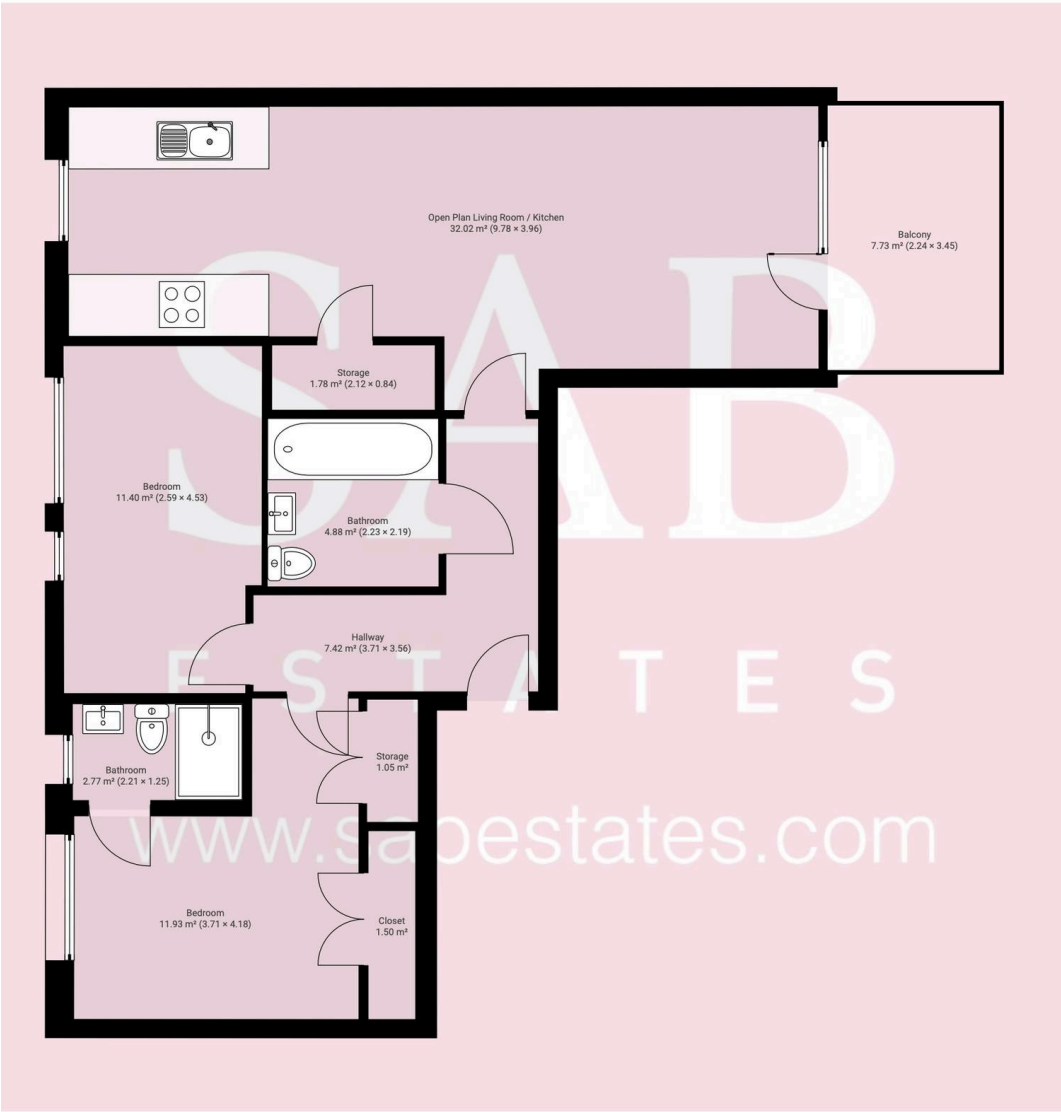

THIS FLOORPLAN IS PROVIDED WITHOUT WARRANTY OF ANY KIND. SENSOPIA DISCLAIMS ANY WARRANTY INCLUDING, WITHOUT LIMITATION, SATISFACTORY QUALITY OR ACCURACY OF DIMENSIONS.

0 1 2 3m
1:69
Page 1/1



SAB Estates

236-238 Ruislip Road, Greenford - UB6 9RS

020 8575 2929 • info@sabestates.com • www.sabestates.com/