



SAB
ESTATES

Frensham Close, Southall
£258,500

SAB
ESTATES



Frensham Close

Southall

- Assigned Parking Space
- Local Amenities
- 50 m2 / 551 ft2
- Leasehold: 91 Years Remaining
- New Electric Radiators
- Chain Free
- Loft Access
- Second Floor Flat
- Newly Decorated
- Ground Rent: £200 pa
- Service Charge: £2,100 pa

Council Tax band: C

Tenure: Leasehold

EPC Energy Efficiency Rating: C

EPC Environmental Impact Rating: D



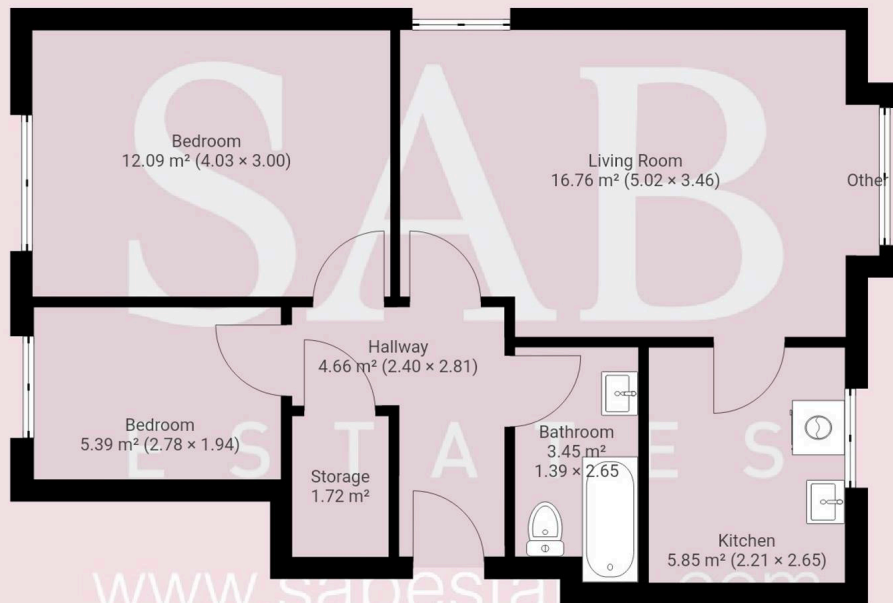



SAB Estates

236-238 Ruislip Road, Greenford - UB6 9RS

020 8575 2929 • info@sabestates.com • www.sabestates.com/