

Millstream Meadows

MIDDLEWICH, CHESHIRE

A brand new collection of 2, 3 & 4 bedroom homes,
located between Middlewich and Sandbach alongside
the Trent and Mersey canal.

Taylor
Wimpey

Contents

→ **Welcome to
Millstream Meadows**



→ **Personalise
your home**

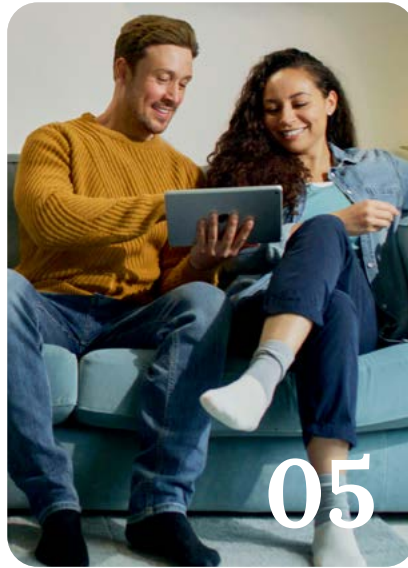

→ **Included
as standard**



→ **Our homes**



→ **Ways to buy**



→ **Take your
next step**



Welcome to Millstream Meadows

Located between Booth Lane and Warmingham Lane, less than 2 miles from Middlewich, Millstream Meadows will bring 390 homes from a brand new house type range.

Ranging from 2, 3 and 4 bedrooms, with modern designs and layouts to suit individual needs, open spaces and a convenience store to the front.



[→ View the site plan](#)

The perfect place to be

Ideally located off Booth Lane, between Sandbach and Middlewich, 5 miles from Junction 18 of the M6 and Sandbach train station just over 3 miles away, to Millstream Meadows is ideal for links to Manchester and Crewe. The Trent and Mersey Canal runs adjacent to the development, with barges and places to eat and drink, perfect for family walks. Schools can be found within 2.5 miles and local amenities in the area include Golf Clubs, leisure centres, parks and a range of shops.

Trent & Mersey canal



Places to dine out



Middlewich



[View the site plan](#)



Personalise your home

A new Taylor Wimpey home is a blank canvas, ready for you to put your stamp on even before you move in. You can choose from a range of high quality options for your kitchen, bedroom and bathroom to suit your taste – and all from the comfort of your sofa. We offer dark and light kitchen units and patterned or plain tiles for your bathroom, so whatever your preferred style we've got you covered.

Using our innovative Options Online tool, you can visualise your new home room-by-room and customise each as you go. You can also choose your options with the help of your Sales Executive if you'd prefer.

Our customers have created some fantastic spaces in their homes and you can get inspiration from their choices by following us on Instagram. You can also check out a host of interior design tips on our website.

[→ Find out more](#)



Options availability is subject to build stage of plots and options won't be available if plots have reached a certain build stage. Please contact the Sales Executive for further information.

Included as standard

From the external features to the finishing touches, every detail of our homes is designed with our customers in mind.

While you'll have the choice to upgrade some of our standard offerings, all of our houses are fitted with a range of high quality features at no extra cost to you.

You'll find a complete list of all items that come as standard in your house below.



Kitchens

All of our kitchens are fitted with beautiful units and worktops and you can choose your preferred style and colour to create your perfect cooking and entertaining space.

A range of accessories including stylish splashbacks, a stainless steel sink and Zeno Taps, and lighting gives your kitchen a clean, contemporary finish. You'll get a modern, energy efficient Zanussi oven with built-in gas hob and integrated hood and extractor fan too.

Utility rooms[†]

Units will be fitted to match your chosen kitchen style, complete with a stainless steel sink and Zeno Taps. If your home has a toilet in the utility room, we'll fit a contemporary white basin and toilet for a sleek finish.



Bathrooms, en suites and shower rooms

Modern white sanitaryware, including toilet, basin and bath with chrome Ideal Standard taps give your main bathroom a clean look. The same sanitaryware is fitted in en suites and shower rooms which also benefit from an Aqualisa shower and glass enclosure. For a distinct look, we offer a varied range of Porcelanosa ceramic wall tiles for you to choose from to make your bathroom and en suite stand out from the crowd.



Garden[†]

The outside of your home is just as carefully considered as the inside. You'll get a fully turfed and landscaped front garden – including plants. The back garden includes a slabbed area and your privacy is protected by a garden fence.



All of the specification listed is included in our houses as standard. For the specification included in our apartments, please see the separate apartment specification list. Standard specifications are correct at time of going to print, but are subject to change without notice. Please contact the Sales Executive for further information. † = Where applicable.

Our homes

→ 2 bedroom homes



→ 3 bedroom homes



→ 4 bedroom homes



→ View the site plan



The Beaford

2 BEDROOM HOME, TOTAL 778 sq ft / 72.25m²



GROUND FLOOR

Living/Dining

3.80m × 4.06m 12' 6" × 13' 4"

Kitchen

2.92m × 2.20m 9' 7" × 7' 2"



FIRST FLOOR

Bedroom 1

3.79m × 4.06m 12' 5" × 13' 4"

Bedroom 2

2.69m × 4.06m 8' 10" × 13' 4"

[→ Discover more about this home](#)

[→ View our current availability](#)

*Plot specific windows. The floor plans depict a typical layout of this house type. For exact plot specification, details of external and internal finishes, dimensions and floor plan differences consult your sales executive. All dimensions are + or - 50mm and floor plans are not shown to scale. The kitchen layout and furniture positions are for indicative purposes only. The computer generated image is for illustrative purposes only and it is from an imaginary viewpoint within an open space area. Its purpose is to give a feel for the development, not an accurate description of each property. The illustration shows a typical Taylor Wimpey home of this type, but there are, however, variances from site to site. External materials, finishes, landscaping and the position of garages (where provided) may vary throughout the development. Properties may also be built handed (mirror image). Images may include optional upgrades at an additional cost. Please ask for further details. TWMA 77298/October 2023



The Mapleford

2 BEDROOM HOME, TOTAL 864 sq ft / 80.20m²



GROUND FLOOR

Living/Dining

4.79m × 4.51m 15' 9" × 14' 10"

Kitchen

2.45m × 3.98m 8' 0" × 13' 1"



FIRST FLOOR

Bedroom 1

3.32m × 3.73m 10' 11" × 12' 3"

Bedroom 2

2.75m × 4.51m 9' 0" × 14' 10"

[→ Discover more about this home](#)

[→ View our current availability](#)

*Plot specific windows. The floor plans depict a typical layout of this house type. For exact plot specification, details of external and internal finishes, dimensions and floor plan differences consult your sales executive. All dimensions are + or - 50mm and floor plans are not shown to scale. The kitchen layout and furniture positions are for indicative purposes only. The computer generated image is for illustrative purposes only and it is from an imaginary viewpoint within an open space area. Its purpose is to give a feel for the development, not an accurate description of each property. The illustration shows a typical Taylor Wimpey home of this type, but there are, however, variances from site to site. External materials, finishes, landscaping and the position of garages (where provided) may vary throughout the development. Properties may also be built handed (mirror image). Images may include optional upgrades at an additional cost. Please ask for further details. TWMA 77298/October 2023



The Eynsford

3 BEDROOM HOME, TOTAL 972 sq ft / 90.26m²



GROUND FLOOR

Living

3.11m × 4.17m 10' 2" × 13' 8"

Kitchen/Dining

3.80m × 5.07m 12' 6" × 16' 8"



FIRST FLOOR

Bedroom 1

3.01m × 4.03m 9' 11" × 13' 3"

Bedroom 2

2.15m × 3.47m 7' 1" × 11' 5"

Bedroom 3

2.84m × 2.93m 9' 4" × 9' 7"

[→ Discover more about this home](#)

[→ View our current availability](#)

*Plot specific windows. The floor plans depict a typical layout of this house type. For exact plot specification, details of external and internal finishes, dimensions and floor plan differences consult your sales executive. All dimensions are + or - 50mm and floor plans are not shown to scale. The kitchen layout and furniture positions are for indicative purposes only. The computer generated image is for illustrative purposes only and it is from an imaginary viewpoint within an open space area. Its purpose is to give a feel for the development, not an accurate description of each property. The illustration shows a typical Taylor Wimpey home of this type, but there are, however, variances from site to site. External materials, finishes, landscaping and the position of garages (where provided) may vary throughout the development. Properties may also be built handed (mirror image). Images may include optional upgrades at an additional cost. Please ask for further details. TWMA 77298/October 2023



The Tetford

3 BEDROOM HOME, TOTAL 1,021 sq ft / 94.84m²

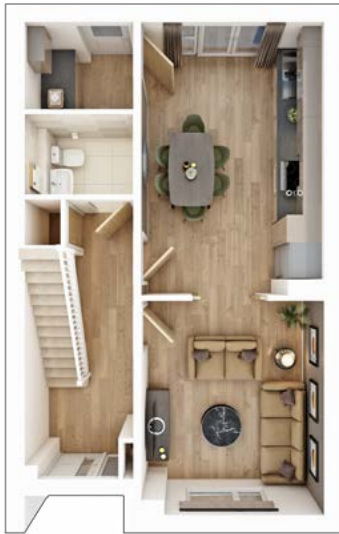

GROUND FLOOR

Living

3.30m × 3.90m 10' 10" × 12' 8"

Kitchen/Dining

3.30m × 4.93m 10' 10" × 16' 2"



FIRST FLOOR

Bedroom 1

2.79m × 3.18m 9' 2" × 10' 5"

Bedroom 2

3.12m × 3.30m 10' 3" × 10' 10"

Bedroom 3

2.52m × 2.97m 8' 3" × 9' 9"

[→ Discover more about this home](#)

[→ View our current availability](#)

*Plot specific windows. The floor plans depict a typical layout of this house type. For exact plot specification, details of external and internal finishes, dimensions and floor plan differences consult your sales executive. All dimensions are + or - 50mm and floor plans are not shown to scale. The kitchen layout and furniture positions are for indicative purposes only. The computer generated image is for illustrative purposes only and it is from an imaginary viewpoint within an open space area. Its purpose is to give a feel for the development, not an accurate description of each property. The illustration shows a typical Taylor Wimpey home of this type, but there are, however, variances from site to site. External materials, finishes, landscaping and the position of garages (where provided) may vary throughout the development. Properties may also be built handed (mirror image). Images may include optional upgrades at an additional cost. Please ask for further details. TWMA 77298/October 2023



The Aynesdale

3 BEDROOM HOME, TOTAL 1,058 sq ft / 98.27m²



GROUND FLOOR

Living/Study

5.52m × 3.19m 18' 1" × 10' 6"

Kitchen/Dining

5.52m × 3.21m 18' 1" × 10' 6"



FIRST FLOOR

Bedroom 1

4.52m × 2.77m 14' 10" × 9' 1"

Bedroom 2

3.23m × 3.27m 10' 7" × 10' 9"

Bedroom 3

2.67m × 2.80m 8' 9" × 9' 2"

[→ Discover more about this home](#)

[→ View our current availability](#)

*Plot specific windows. The floor plans depict a typical layout of this house type. For exact plot specification, details of external and internal finishes, dimensions and floor plan differences consult your sales executive. All dimensions are + or - 50mm and floor plans are not shown to scale. The kitchen layout and furniture positions are for indicative purposes only. The computer generated image is for illustrative purposes only and it is from an imaginary viewpoint within an open space area. Its purpose is to give a feel for the development, not an accurate description of each property. The illustration shows a typical Taylor Wimpey home of this type, but there are, however, variances from site to site. External materials, finishes, landscaping and the position of garages (where provided) may vary throughout the development. Properties may also be built handed (mirror image). Images may include optional upgrades at an additional cost. Please ask for further details, TWMA 77298/October 2023



The Harrton

3 BEDROOM HOME, TOTAL 1,140 sq ft / 106.00m²



GROUND FLOOR

Living/Dining

4.09m × 4.39m 13' 5" × 14' 5"

Kitchen

3.37m × 3.12m 11' 1" × 10' 5"



FIRST FLOOR

Bedroom 1

4.39m × 3.17m 14' 5" × 10' 5"

Bedroom 3

2.40m × 3.32m 7' 10" × 10' 11"



SECOND FLOOR

Bedroom 2

3.35m × 3.41m 11' 0" × 11' 2"

Bedroom 2 (Dresser Area)

2.81m × 2.23m 9' 3" × 7' 4"

[→ Discover more about this home](#)

[→ View our current availability](#)

*Plot specific windows. The floor plans depict a typical layout of this house type. For exact plot specification, details of external and internal finishes, dimensions and floor plan differences consult your sales executive. All dimensions are + or - 50mm and floor plans are not shown to scale. The kitchen layout and furniture positions are for indicative purposes only. The computer generated image is for illustrative purposes only and it is from an imaginary viewpoint within an open space area. Its purpose is to give a feel for the development, not an accurate description of each property. The illustration shows a typical Taylor Wimpey home of this type, but there are, however, variances from site to site. External materials, finishes, landscaping and the position of garages (where provided) may vary throughout the development. Properties may also be built handed (mirror image). Images may include optional upgrades at an additional cost. Please ask for further details. TWMA 77298/October 2023



The Byrneham

3 BEDROOM HOME, TOTAL 1,154 sq ft / 107.20m²



GROUND FLOOR

Living

3.27m × 4.38m 10' 9" × 14' 4"

Kitchen/Dining

4.17m × 4.39m 13' 8" × 14' 5"

Garage

5.36m × 3.19m 17' 7" × 10' 6"



FIRST FLOOR

Bedroom 1

3.29m × 5.32m 10' 9" × 17' 6"

Bedroom 2

2.89m × 4.17m 9' 6" × 13' 8"

Bedroom 3

3.59m × 2.24m 11' 10" × 7' 4"

Study

2.60m × 1.85m 8' 6" × 6' 1"



[Discover more about this home](#)



[View our current availability](#)

*Plot specific windows. The floor plans depict a typical layout of this house type. For exact plot specification, details of external and internal finishes, dimensions and floor plan differences consult your sales executive. All dimensions are + or - 50mm and floor plans are not shown to scale. The kitchen layout and furniture positions are for indicative purposes only. The computer generated image is for illustrative purposes only and it is from an imaginary viewpoint within an open space area. Its purpose is to give a feel for the development, not an accurate description of each property. The illustration shows a typical Taylor Wimpey home of this type, but there are, however, variances from site to site. External materials, finishes, landscaping and the position of garages (where provided) may vary throughout the development. Properties may also be built handed (mirror image). Images may include optional upgrades at an additional cost. Please ask for further details. TWMA 77298/October 2023



The Bittesford

4 BEDROOM HOME, TOTAL 1,236 sq ft / 114.85m²



GROUND FLOOR

Living

3.49m × 4.39m 11' 5" × 14' 5"

Kitchen/Dining

4.39m × 5.30m 14' 5" × 17' 5"



FIRST FLOOR

Bedroom 1

3.40m × 3.51m 11' 12" × 11' 6"

Bedroom 2

2.94m × 3.16m 9' 8" × 10' 4"

Bedroom 3

3.04m × 2.45m 10' 0" × 8' 0"

Bedroom 4

2.13m × 3.51m 7' 0" × 11' 6"



[Discover more about this home](#)



[View our current availability](#)

*Plot specific windows. The floor plans depict a typical layout of this house type. For exact plot specification, details of external and internal finishes, dimensions and floor plan differences consult your sales executive. All dimensions are + or - 50mm and floor plans are not shown to scale. The kitchen layout and furniture positions are for indicative purposes only. The computer generated image is for illustrative purposes only and it is from an imaginary viewpoint within an open space area. Its purpose is to give a feel for the development, not an accurate description of each property. The illustration shows a typical Taylor Wimpey home of this type, but there are, however, variances from site to site. External materials, finishes, landscaping and the position of garages (where provided) may vary throughout the development. Properties may also be built handed (mirror image). Images may include optional upgrades at an additional cost. Please ask for further details. TWMA 77298/October 2023



The Colford

4 BEDROOM HOME, TOTAL 1,252 sq ft / 116.29m²



GROUND FLOOR

Living

3.50m × 4.36m 11' 6" × 14' 4"

Kitchen/Dining

6.54m × 3.11m 21' 5" × 10' 3"

Study Area (in Kitchen/Dining)

2.08m × 2.21m 6' 10" × 7' 3"



FIRST FLOOR

Bedroom 1

3.41m × 3.51m 11' 2" × 11' 6"

Bedroom 2

3.16m × 2.94m 10' 4" × 9' 8"

Bedroom 3

3.04m × 2.47m 10' 0" × 8' 1"

Bedroom 4

3.51m × 2.13m 11' 6" × 7' 0"

[→ Discover more about this home](#)

[→ View our current availability](#)

*Plot specific windows. The floor plans depict a typical layout of this house type. For exact plot specification, details of external and internal finishes, dimensions and floor plan differences consult your sales executive. All dimensions are + or - 50mm and floor plans are not shown to scale. The kitchen layout and furniture positions are for indicative purposes only. The computer generated image is for illustrative purposes only and it is from an imaginary viewpoint within an open space area. Its purpose is to give a feel for the development, not an accurate description of each property. The illustration shows a typical Taylor Wimpey home of this type, but there are, however, variances from site to site. External materials, finishes, landscaping and the position of garages (where provided) may vary throughout the development. Properties may also be built handed (mirror image). Images may include optional upgrades at an additional cost. Please ask for further details. TWMA 77298/October 2023



The Plumdale

4 BEDROOM HOME, TOTAL 1,252 sq ft / 116.29m²



GROUND FLOOR

Living/Study

6.53m × 3.25m 21' 5" × 10' 8"

Kitchen/Dining

6.53m × 3.29m 21' 5" × 10' 10"



FIRST FLOOR

Bedroom 1

3.63m × 3.40m 11' 11" × 11' 2"

Bedroom 2

3.31m × 3.00m 10' 10" × 9' 10"

Bedroom 3

2.18m × 3.45m 7' 2" × 11' 4"

Bedroom 4

3.04m × 2.16m 10' 0" × 7' 1"

[→ Discover more about this home](#)

[→ View our current availability](#)

*Plot specific windows. The floor plans depict a typical layout of this house type. For exact plot specification, details of external and internal finishes, dimensions and floor plan differences consult your sales executive. All dimensions are + or - 50mm and floor plans are not shown to scale. The kitchen layout and furniture positions are for indicative purposes only. The computer generated image is for illustrative purposes only and it is from an imaginary viewpoint within an open space area. Its purpose is to give a feel for the development, not an accurate description of each property. The illustration shows a typical Taylor Wimpey home of this type, but there are, however, variances from site to site. External materials, finishes, landscaping and the position of garages (where provided) may vary throughout the development. Properties may also be built handed (mirror image). Images may include optional upgrades at an additional cost. Please ask for further details. TWMA 77298/October 2023



The Hubham

4 BEDROOM HOME, TOTAL 1,370 sq ft / 127.30m²



GROUND FLOOR

Living

3.60m × 4.13m 11' 10" × 13' 7"

Kitchen/Dining

5.81m × 3.89m 19' 1" × 12' 9"

Garage

7.12m × 3.02m 23' 4" × 9' 11"



FIRST FLOOR

Bedroom 1

3.61m × 5.27m 11' 10" × 17' 3"

Bedroom 2

3.75m × 3.29m 12' 4" × 10' 10"

Bedroom 3

3.72m × 3.08m 12' 2" × 10' 1"

Bedroom 4

3.51m × 2.83m 11' 6" × 9' 3"

[→ Discover more about this home](#)

[→ View our current availability](#)

*Plot specific windows. The floor plans depict a typical layout of this house type. For exact plot specification, details of external and internal finishes, dimensions and floor plan differences consult your sales executive. All dimensions are + or - 50mm and floor plans are not shown to scale. The kitchen layout and furniture positions are for indicative purposes only. The computer generated image is for illustrative purposes only and it is from an imaginary viewpoint within an open space area. Its purpose is to give a feel for the development, not an accurate description of each property. The illustration shows a typical Taylor Wimpey home of this type, but there are, however, variances from site to site. External materials, finishes, landscaping and the position of garages (where provided) may vary throughout the development. Properties may also be built handed (mirror image). Images may include optional upgrades at an additional cost. Please ask for further details. TWMA 77298/October 2023

Ways to buy

Everyone knows buying a new home is an exciting time. But it can be a stressful one too, which is why our sales executives and customer relations managers are there to help every step of the way, from your initial enquiry right through to opening the front door of your new home for the first time.



First time buyer?

[→ Here's how we can help](#)

Existing home owner?

[→ Here's how we can help](#)



Take your next step



Find your dream home on our website.



Book an appointment to view our show homes.



Take a virtual tour of our homes from the comfort of your sofa.



Have your questions answered by calling our sales executives on **01270 306 638**.



Find out how we can get you moving with our buying schemes.



[Book an appointment](#)



[How to buy a home](#)



MILLSTREAM MEADOWS Booth Lane, Middlewich, CW10 0HB

CONTACT US ON 01270 306 638

Taylor Wimpey