

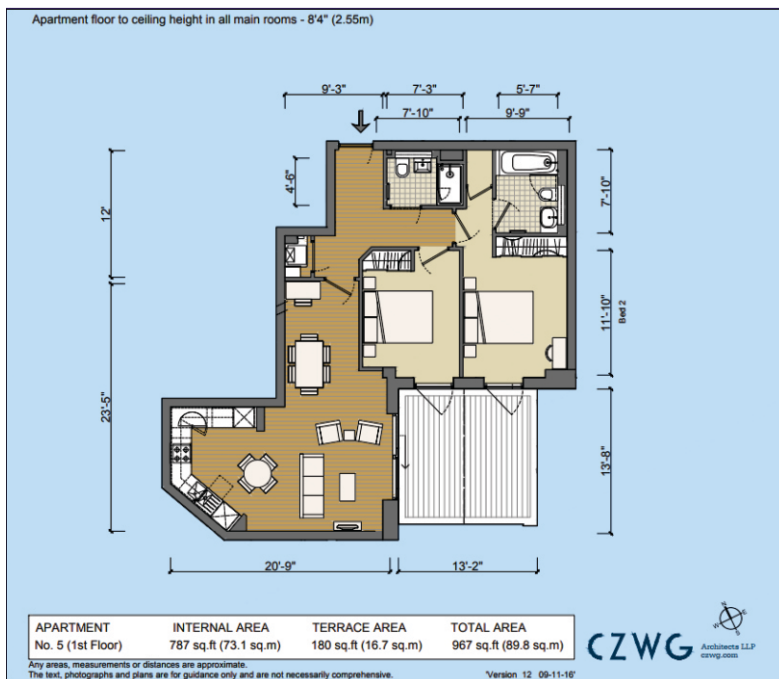

Key features:

- Large Private Patio
- 2 Double Bedrooms
- Modern Kitchen and Bathrooms
- Secure Underground Parking



The Cooperage,
Dorchester



Guide price of
£325,000

For Sale | 2 bedrooms | 2 bathrooms

2 Bedroom 2 Bathroom apartment with spacious private patio area and secure underground parking

Description

This two bedroom apartment is spacious, light and airy. Designed by Conran & Partners, it has the bonus of being located on the first floor from street level but is located on the ground floor from the internal communal gardens with the advantage of a private large outside patio area which is accessed from the main living area and both bedrooms. The large fully fitted kitchen, designed by Paula Rosa includes a range of modern top quality integrated appliances and leads into the open plan living area.

Both bedrooms are carpeted and have large built in wardrobes finished in Walnut veneer. The master bedroom is fully en-suite with travertine tiling complimenting the quality bathroom suite, this is reflected in the guest bathroom. Walnut flooring runs throughout the hall, which accommodates a cupboard that houses the washer/drier. The apartment is heated by gas fired underfloor central heating.

The apartment has Video Phone Entry, Concierge, 24 hour on-site security. Underground parking can be accessed by a lift.

Brewery Square is a prestigious development in the County Town of Dorchester. It has a wealth of shops and eateries, a cinema, hairdressers, wine merchants, doctors' surgery and pharmacy all coming together to create a local community. It is situated within a few minutes walking distance of Dorchester's busy shopping street and also the main line rail stations to London and Bristol. The beautiful Dorset countryside and the seaside town of Weymouth are also within easy reach.

Please note images were taken when the apartment was empty - the apartment is currently tenanted, tenancy ends soon

For room sizes please see Floorplan

Council Tax Band D

