



AR WERTH  
McHattons  
Gwerthu a Gosod  
01656 331577

Arlington Place  
, Porthcawl, CF36 3DD  
£300,000

3 1 3 D

## Arlington Place

, Porthcawl, CF36 3DD

Nestled in Arlington Place, Porthcawl, this charming semi-detached house presents an excellent opportunity for those looking to create their dream family home. With three spacious reception rooms, including a delightful conservatory that overlooks the rear garden, this property offers ample space for both relaxation and entertaining.

The home features three generously sized double bedrooms, ensuring comfort for all family members. A well-appointed bathroom and a separate WC add to the convenience of this layout. Additionally, the property boasts a large attic space, which holds great potential for conversion, subject to planning permission, allowing you to tailor the home to your specific needs.

Situated in a sought-after location, this residence is in close proximity to local schools, making it ideal for families. The vibrant town centre, the historic village of Nottage, and the beautiful beaches are all just a short distance away, providing a perfect blend of convenience and leisure.

While the property is in need of some modernisation, it offers a fantastic canvas for those with a vision. The gated driveway provides off-road parking and access to a carport, enhancing the practicality of this lovely home.

In summary, this semi-detached house in Arlington Place is a rare find, combining space, potential, and a prime location. If you are looking to create a family haven, this property is well worth your consideration.





## Floor Plan

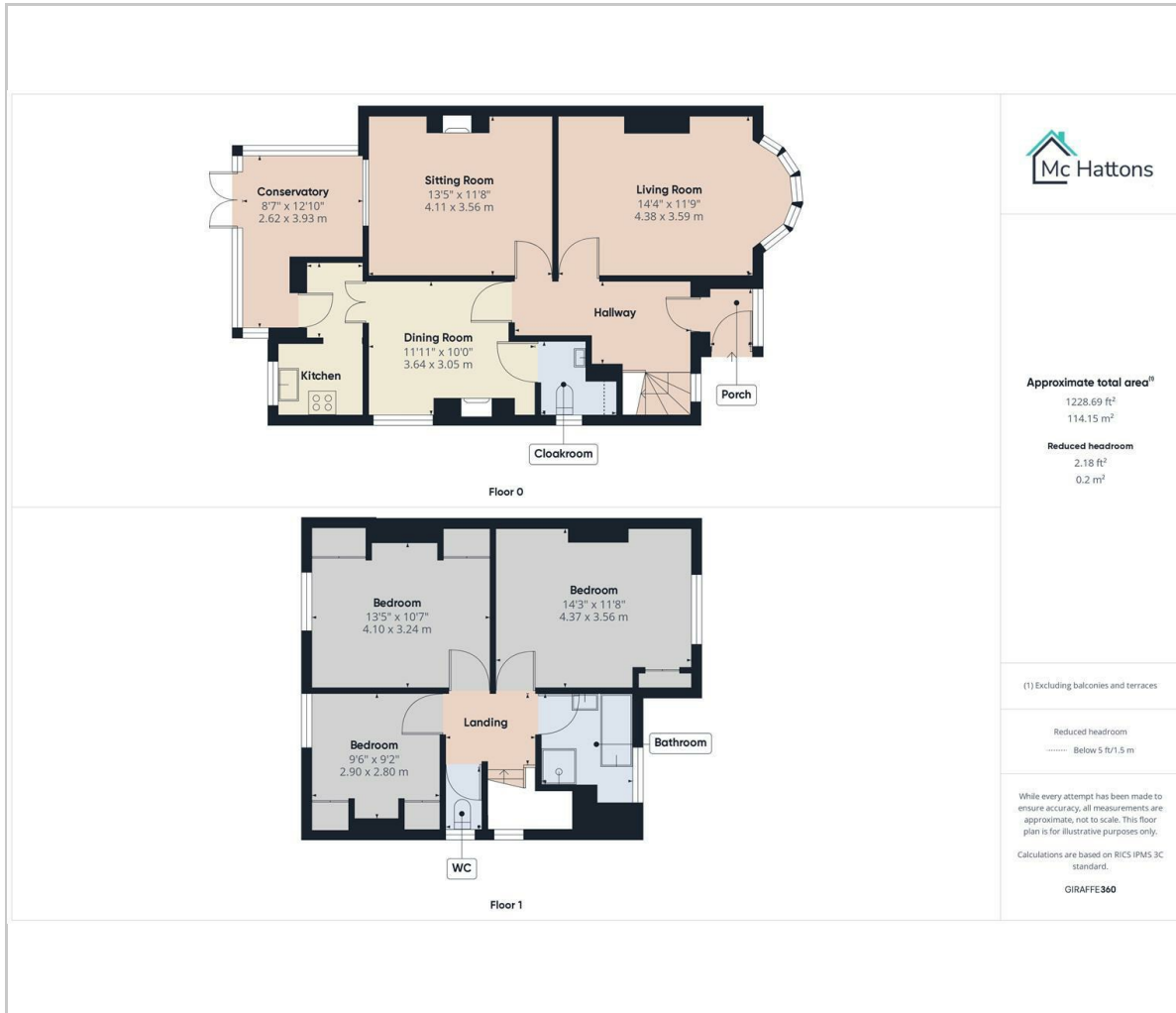

## Area Map

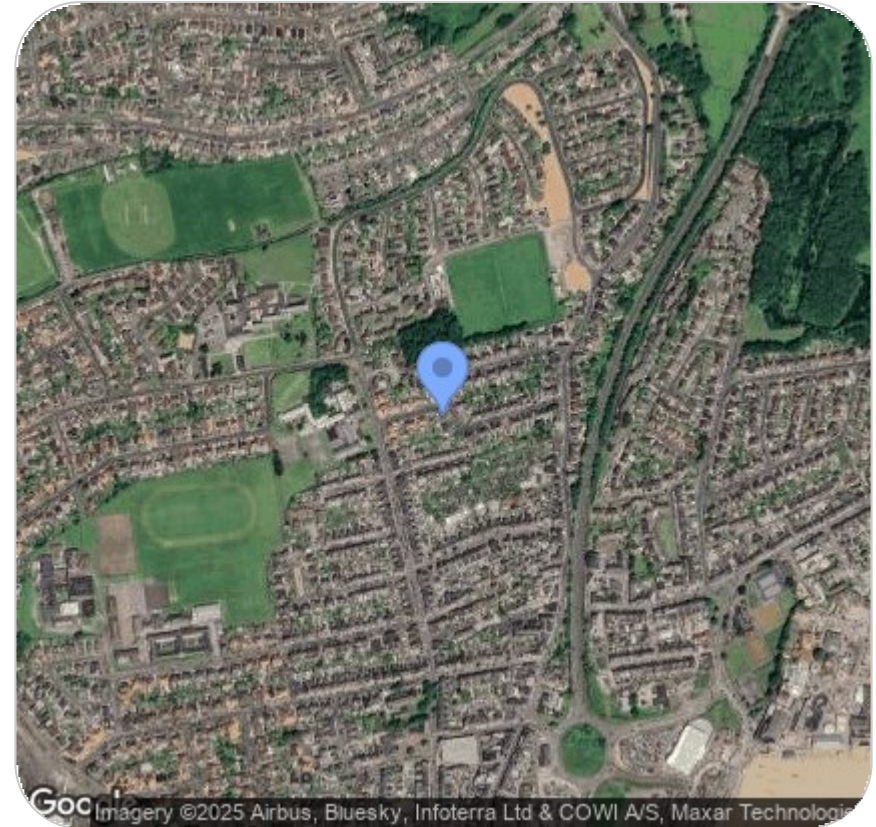

## Viewing

Please contact our McHattons - Porthcawl Office on 01656 331577 if you wish to arrange a viewing appointment for this property or require further information.

These particulars, whilst believed to be accurate are set out as a general outline only for guidance and do not constitute any part of an offer or contract. Intending purchasers should not rely on them as statements of representation of fact, but must satisfy themselves by inspection or otherwise as to their accuracy. No person in this firm's employment has the authority to make or give any representation or warranty in respect of the property.

10 Lias Road Porthcawl, CF36 3AH

Tel: 01656 331577 Email: enquiries@mchattons.co.uk www.mchattons.co.uk

## Energy Efficiency Graph

