



Lewis Road
Crynant, SA10 8SD

Offers in the region of £200,000



Lewis Road
Crynant, SA10 8SD

McHattons Estate agents are pleased to present to market this three-bedroom, semi-detached home on Lewis Road in the sought after area of Crynant, Neath. With no ongoing chain and well presented throughout, early enquiries are encouraged to secure your viewing of this property.

The ground floor includes an inviting entrance hall, a spacious living room, and a contemporary open-plan kitchen/dining area. Additional features include a separate utility room and a convenient WC. Upstairs, the landing provides access to three well-proportioned bedrooms and a family bathroom. The property also benefits from an enclosed, low-maintenance rear garden with artificial grass.

Situated in the peaceful village of Crynant, the property enjoys close proximity to local amenities and scenic countryside. With its spacious layout and potential for further enhancement, this home is perfect for young families, those looking to downsize and buy to let investors alike.





Floor Plan

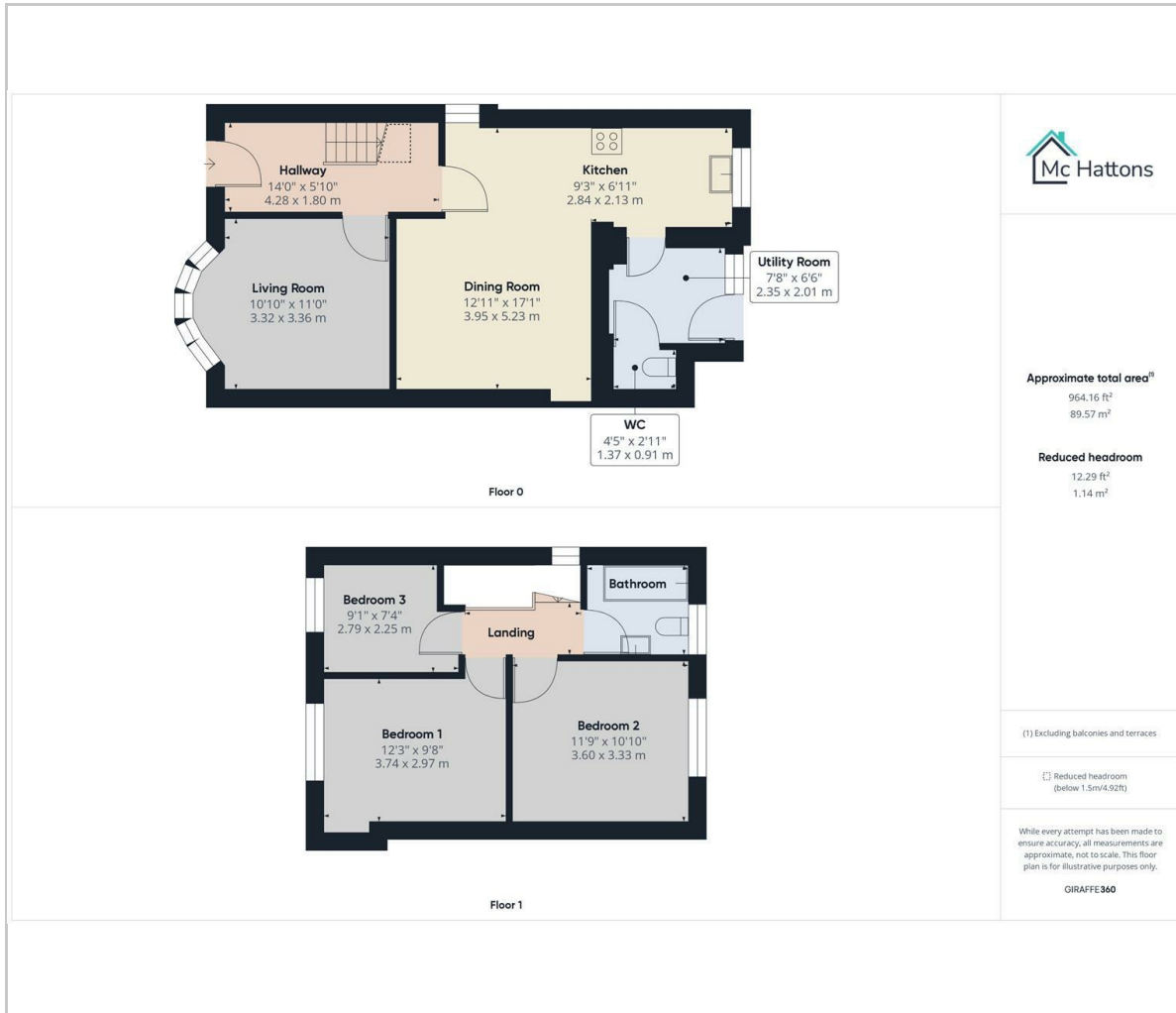

Area Map

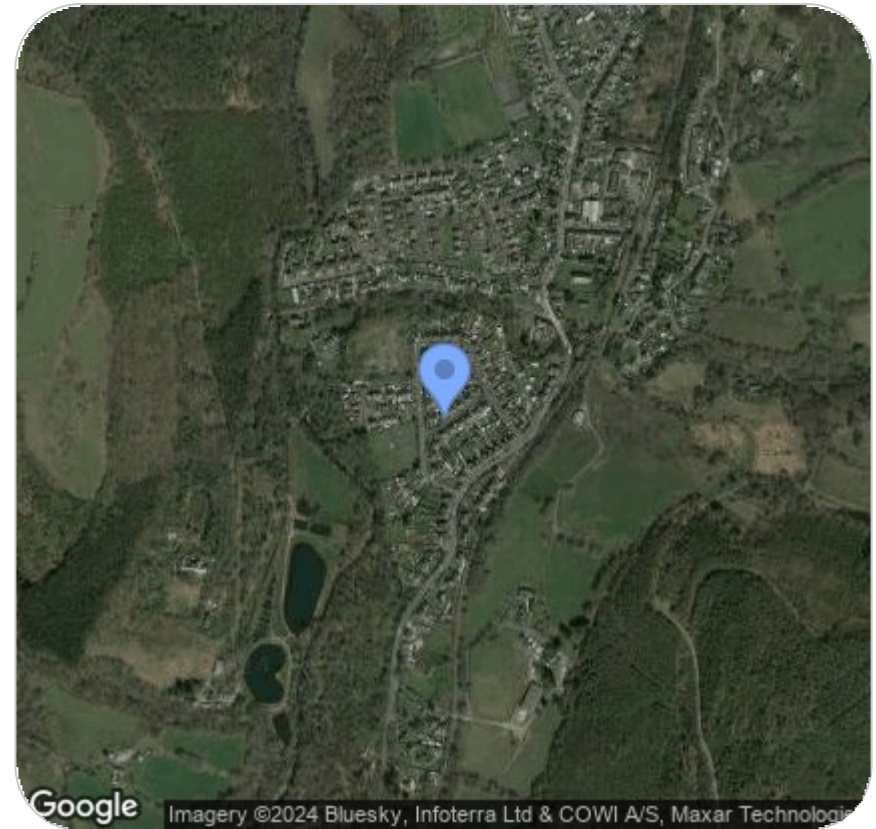

Energy Efficiency Graph

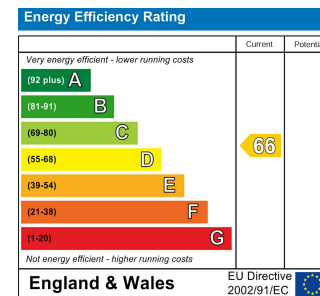

Viewing

Please contact our McHattons - Porthcawl Office on 01656 331577 if you wish to arrange a viewing appointment for this property or require further information.

These particulars, whilst believed to be accurate are set out as a general outline only for guidance and do not constitute any part of an offer or contract. Intending purchasers should not rely on them as statements of representation of fact, but must satisfy themselves by inspection or otherwise as to their accuracy. No person in this firm's employment has the authority to make or give any representation or warranty in respect of the property.

10 Lias Road Porthcawl, CF36 3AH

Tel: 01656 331577 Email: enquiries@mchattons.co.uk www.mchattons.co.uk