



Philadelphia Road
, Porthcawl, CF36 3DP

£280,000



Philadelphia Road
, Porthcawl, CF36 3DP

This charming three-bedroom semi-detached cottage-style property is located on Philadelphia Road, Porthcawl. It is conveniently situated close to Porthcawl Town and the surrounding beaches. Well-presented throughout, the property offers comfortable living spaces and delightful features.

Ground Floor:

Lounge: A spacious area featuring a cosy log-burning stove, perfect for relaxation and gatherings.

Kitchen: Well-equipped and functional, providing ample space for meal preparation.

Sitting / Garden Room: An additional living area ideal for enjoying natural light and views of the garden.

Shower Room: Conveniently located on the ground floor for easy access.

First Floor:

Bedrooms: Three well-proportioned bedrooms offering comfortable and private spaces for rest.

Bathroom: A family bathroom serving the three bedrooms.

Exterior:

Rear Garden:

An enclosed garden that combines both patio and lawn areas, perfect for outdoor activities and entertaining.

This delightful property offers a blend of character and convenience, making it an ideal home for those looking to enjoy the amenities of Porthcawl and its beautiful beaches.





Floor Plan

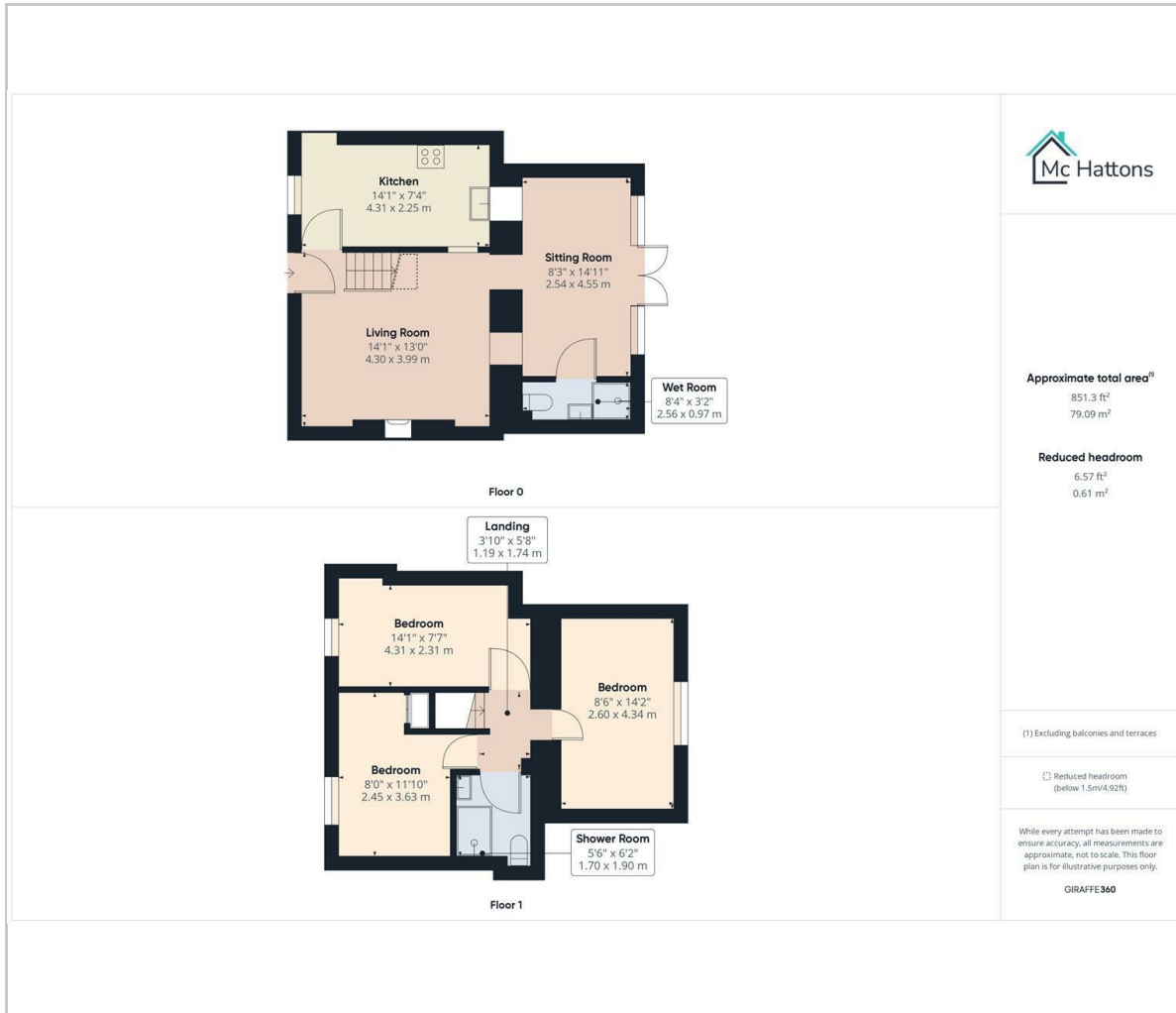

Area Map



Energy Efficiency Graph

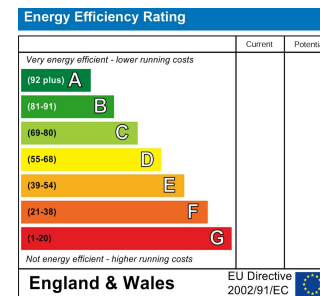

Viewing

Please contact our McHattons - Porthcawl Office on 01656 331577 if you wish to arrange a viewing appointment for this property or require further information.

These particulars, whilst believed to be accurate are set out as a general outline only for guidance and do not constitute any part of an offer or contract. Intending purchasers should not rely on them as statements of representation of fact, but must satisfy themselves by inspection or otherwise as to their accuracy. No person in this firm's employment has the authority to make or give any representation or warranty in respect of the property.

10 Lias Road Porthcawl, CF36 3AH

Tel: 01656 331577 Email: enquiries@mchattons.co.uk www.mchattons.co.uk