



WHITEFRIARS

BUSINESS CENTRE

AT THE **HEART** OF THE CITY



SERVICED OFFICE SUITES
FOR **4-200** PEOPLE

Please contact us to arrange a viewing.

01275 795 395 | sales@chadwickbc.co.uk | www.whitefriarsbristol.com
Whitefriars Business Centre | 2nd Floor | Whitefriars Lewins Mead | Bristol | BS1 2NT



FIXED MONTHLY FEE WITH AN ALL-INCLUSIVE PACKAGE

Our fully inclusive package provides you with the following:

- ▶ Modern fit-out
- ▶ High quality tea points
- ▶ Bookable meeting rooms
- ▶ Break out and collaboration spaces
- ▶ High speed fibre connection
- ▶ Dedicated bandwidth options
- ▶ VOIP phone system
- ▶ Digital telephone handsets
- ▶ Secure Comms Room
- ▶ Furniture
- ▶ 24/7 manned security
- ▶ 24/7 secure access
- ▶ Mail delivery and collection
- ▶ Landlord's service charges
- ▶ Business rates
- ▶ Statutory compliance
- ▶ Utilities
- ▶ Daily cleaning
- ▶ Maintenance
- ▶ Staffed main reception
- ▶ Passenger lifts
- ▶ On-site café
- ▶ Secure cycle storage
- ▶ On-site parking (additional fees apply)
- ▶ On-site gym (additional fees apply)
- ▶ EPC Rating E-124

OVERVIEW

- ▶ Serviced office suites ready for immediate occupation in the heart of Bristol.
- ▶ A vibrant working environment inside a prominent building that enjoys excellent natural light levels, stunning entrance reception, on-site conference rooms, café, gym and parking.
- ▶ Suites suitable for 4 - 200 people, with options to expand or contract.
- ▶ Simple all-inclusive agreements for a fixed term, be that several months, one year or more.



INDICATIVE FLOOR PLAN

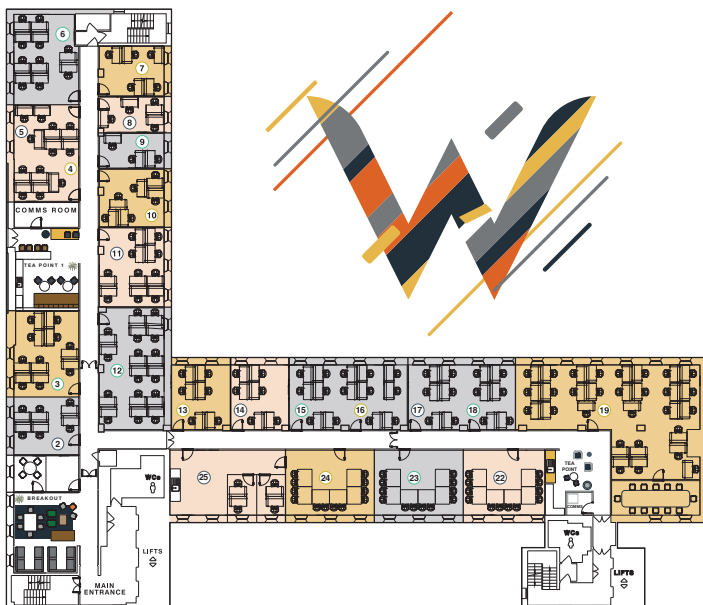

LOCATION

- ▶ One of Bristol's most prominent landmark buildings conveniently situated at the core of the city's Central Business District.
- ▶ Bristol Bus Station is just a 3 minute walk away and there is direct access to the M32 (1.5 miles), M4 (5.5 miles) and M4/M5 interchange (9 miles).
- ▶ Temple Meads Railway Station is just over a mile away and provides direct routes to London, the Midlands and the South West.
- ▶ Cabot Circus and Broadmead Shopping Centres are a short walk away and provide all the amenities that any occupier could possibly need including shops, banks, cafés and restaurants.