



**Fuchsia Road
Emersons Green**

£295,000

ChaseBuchanan

Key Features

- 2020 Build
- Redecorated and re-carpeted 2023
- 2 Off Street Parking Spaces
- Two Bedrooms
- Downstairs WC
- Easy Maintenance Garden
- Side Access Gate
- Quiet Off-Street Location



Description

Set across two floors this property promises comfortable living with a modern, efficient layout. The ground floor opens up to a combined kitchen and cosy living area, alongside a conveniently located WC. Up on the first floor, you'll find two comfortable bedrooms, along with a full-sized bathroom that comes with a bath. This property offers a good balance of public and private spaces, making it a perfect choice for a small family or working professionals. Externally there is an easy maintenance rear garden and off-street parking for two cars.





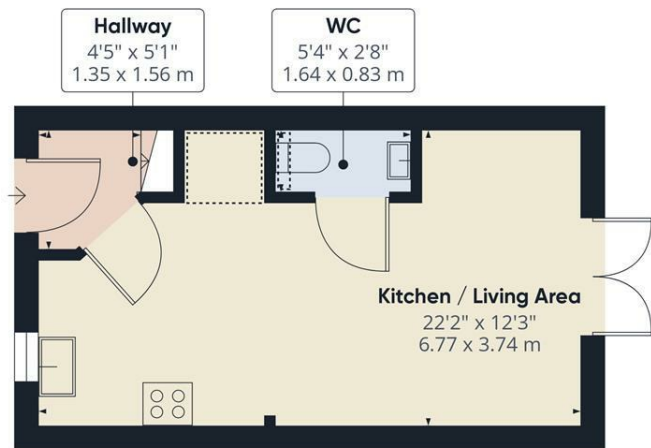

Ground Floor

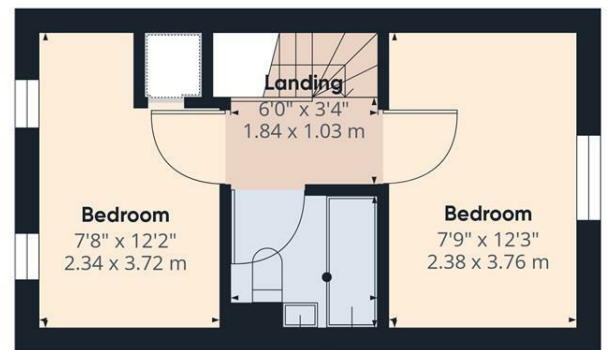

Floor 1

Approximate total area⁽¹⁾
 503.82 ft²
 46.81 m²

Reduced headroom
 12.51 ft²
 1.16 m²

(1) Excluding balconies and terraces.

Reduced headroom
 (below 1.5m/4.92ft)

While every attempt has been made to ensure accuracy, all measurements are approximate, not to scale. This floor plan is for illustrative purposes only.

GIRAFFE360

For more information or to book a viewing, please contact:

0117 9576290

6 Badminton Road, BS16 7BQ

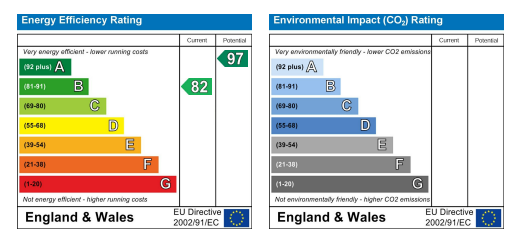

Care has been taken in the preparation of these particulars, however, their accuracy is not guaranteed and they do not form part of any contract. Measurements stated must be considered maximum.

ChaseBuchanan