



Southwold Road, E5

£475,000

A modern three bedroom apartment overlooking Millfields Park with a private balcony and allocated parking space. It benefits from floor to ceiling windows, wooden flooring, secure entry and lift access. It is also being sold chain free.

Morton House is located on Millfields Park next to the Hackney Marshes and the River Lea. It is under half a mile to Clapton Overground only three stops to Liverpool Street Station. The many café's, shops and restaurants of Chatsworth Road and Upper Clapton Road are nearby.

Features

- Three Bedrooms
- Park Views
- Allocated Parking Space
- Private Balcony
- EWS1 Compliant
- Chain Free

Southwold Road, London, E5

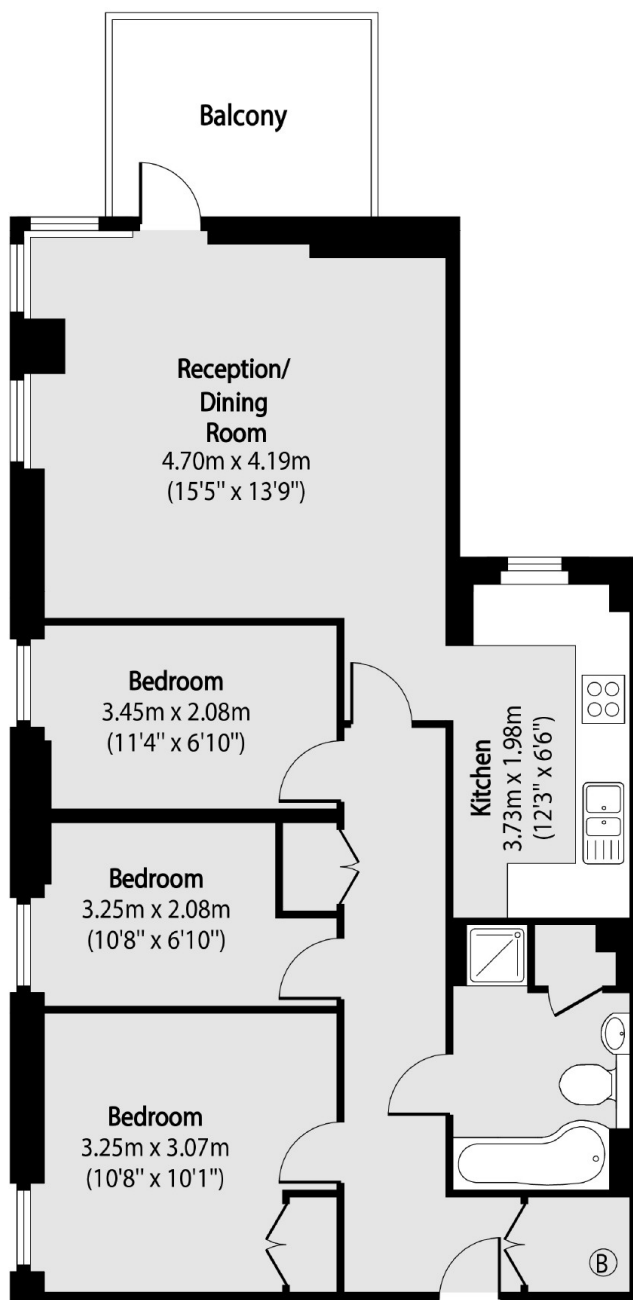

Total area (approx): 70.69 sq m (761 sq. ft)

Balcony/ total area (approx): 6.41 sq m (69 sq. ft)