



## Elderfield Road, E5

### £1,200,000

A three bedroom Victorian terrace with renovation and extension potential on one of Lower Clapton's most sought after roads. The property has a private garden, large basement, loft space and period features. It is being sold chain free.

Moments from vibrant Chatsworth Road, Lower Clapton Road & Mare Street there are numerous cafes, restaurants to choose from and Sunday Market. The green spaces of Hackney Downs Park, Millfields Park and the Hackney Marshes are nearby. Transport links include Homerton and Hackney Central overground stations offering easy access to the City.

### Features

- Victorian Terrace
- Three Bedrooms
- Renovation Potential
- Private Garden
- Basement
- Chatsworth Road
- Chain Free

# Elderfield Road, London, E5

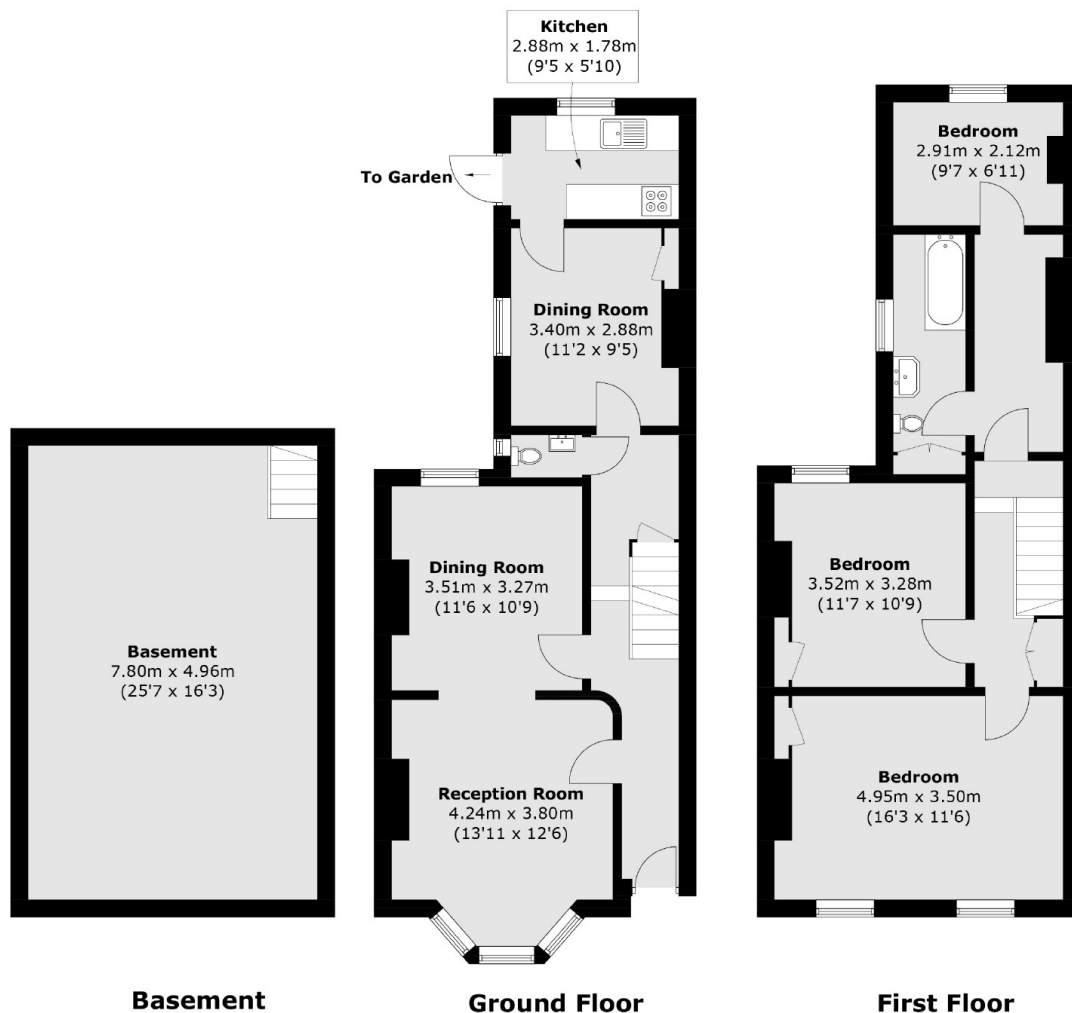

Total area (approx.): 147.8 sq. m (1,590.9 sq. ft)  
(Including Basement)